

90 28 22 285 00



| | | |
|---|-------------------------------|--------------------|
|  | Matte Black | 90 28 22 285 00-33 |
|  | Chrome | 90 28 22 285 00-00 |
|  | Brushed Platinum | 90 28 22 285 00-06 |
|  | Platinum | 90 28 22 285 00-08 |
|  | Durabross (23kt Gold) | 90 28 22 285 00-09 |
|  | Dark Chrome | 90 28 22 285 00-19 |
|  | Brushed Durabross (23kt Gold) | 90 28 22 285 00-28 |
|  | Brushed Bronze (PVD) | 90 28 22 285 00-42 |
|  | Brushed Champagne (22kt Gold) | 90 28 22 285 00-46 |
|  | Champagne (22kt Gold) | 90 28 22 285 00-47 |
|  | Brushed Chrome | 90 28 22 285 00-93 |
|  | Brushed Dark Platinum | 90 28 22 285 00-99 |



Spout 165 mm, 7 l/min. - Matte Black

SPARE PARTS

90 28 22 285 00



Spout 165 mm, 7 l/min. - Matte Black

SPARE PARTS

90 28 22 285 00

90 28 22 285 00

Parts for other finishes can be found here: [Chrome](#)

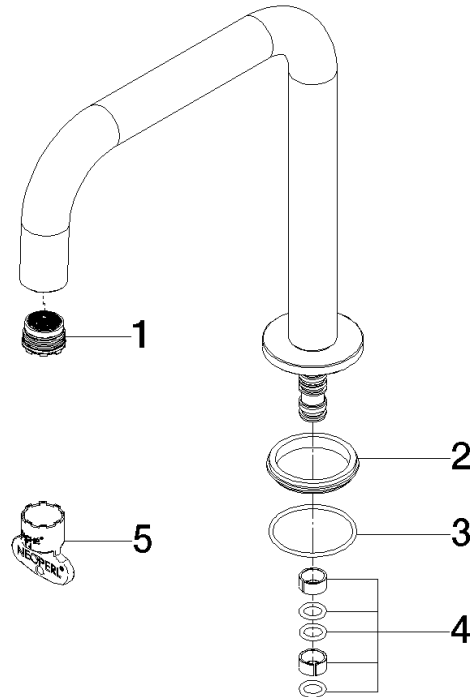

Spare parts list

| No. | Item Number | Name | Quantity used | Delivery time |
|-----|--------------------|----------------------------------|---------------|---------------|
| 2 | 90 30 11 285 00 90 | Disc Ø 41 x 4,5 mm - | 1.00 | 14 |
| 5 | 90 30 09 023 00 90 | Spanner - | 1.00 | 14 |
| 3 | 90 14 10 500 00 90 | O-Ring EPDM 70 34,65 x 1,78 mm - | 1.00 | 14 |
| 1 | 90 29 03 132 00 90 | Aerator insert M18.5 x 1 - | 1.00 | 14 |
| 4 | 90 28 10 184 00 90 | Seal set for spout - | 1.00 | 14 |