

Productinformatieblad

Specificaties



Controlelampje, Harmony XB4, metaal, rood, 22mm, universele LED, effen lens, 24V AC DC, compacte push-in

XB4BVB45

Belangrijk bericht: A change in appearance may be noted on the product but does not affect its use in terms of function and safety. This makes it compatible with our Universal LED blocks
EAN Code: 3606480724039

Prijs: 18,50 EUR

Hoofd

| | |
|------------------------------------|---------------------|
| range of product | Harmony XB4 |
| product of component type | Controlelampje |
| device short name | XB4 |
| kraag materiaal | Verchroomd metaal |
| materiaal bevestigingskraag | Zamak |
| bevestigingsdiameter | 22,5 mm |
| verkoop per ondeelbare hoeveelheid | 1 |
| vorm van kop signaleringseenheid | Rond |
| kap/operator of lenskleur | Rood |
| extra informatie operator | Met gewone lens |
| lichtbron | Universele LED |
| lamp fitting | Integrale LED |
| kleur lichtbron | Rood |
| Us nominale voedingsspanning | 24 V AC/DC 50/60 Hz |

Complementair

| | |
|---------------------------------|--|
| hoogte | 47 mm |
| breedte | 30 mm |
| diepte | 45,2 mm |
| beschrijving klemmen ISO n°1 | (X1-X2)PL |
| gewicht product | 0,076 kg |
| weerstand hoge druk drukring | 7000000 Pa om 55 °C, afstand: 0.1 m |
| aansluitingen - aansluitklemmen | Insteek, <= 2 x 1,5 mm ² met kabeluiteinde met aansluitflensbus In overeenstemming met IEC 60947-1 Insteek, >= 1 x 0,34 mm ² zonder draadeinddop In overeenstemming met IEC 60947-1 |
| Ui nom isolatiespanning | 300 V (vervuilingsgraad) 3) In overeenstemming met IEC 60947-1 |
| Uimp nom. schokgolfsparing | 4 kV In overeenstemming met IEC 60947-1 |
| type signalering | Vast |

De weergegeven prijs is de adviesprijs in euro excl. BTW. Deze kan onderhevig zijn aan korting. Neem contact op met uw lokale distributeur of detailhandel voor de daadwerkelijke prijs

| | |
|----------------------------|---|
| stroomverbruik | 15 mA |
| levensduur | 100000 h bij nominale spanning en 25 °C |
| bestand tegen stroompieken | 1 kV In overeenstemming met IEC 61000-4-5 |
| product presentatie | Compleet product |
| voedingsspanningsgrenzen | 20,4...26,4 V DC 20,4...26,4 V AC |

Omgeving

| | |
|---|---|
| beschermende behandeling | TH |
| ambient air temperature for storage | -40...70 °C |
| omgevingstemperatuur voor werking | -40...70 °C |
| beschermingsklasse tegen elektrische schokken | Klasse I In overeenstemming met IEC 60536 |
| IP beschermingsgraad | IP66 In overeenstemming met IEC 60529 IP67 IP69 IP69K |
| Enclosure Type | UL type 4X/13 |
| IK-beschermingsgraad | IK06 In overeenstemming met IEC 50102 |
| standards | IEC 60947-1 IEC 60947-5-1 IEC 60947-5-4 IEC 60947-5-5 UL 60947-1 UL 60947-5-1 UL 60947-5-5 UL 1059 UL 486E CSA C22.2 Nr 60947-1 CSA C22.2 Nr 60947-5-1 CSA C22.2 Nr. 158 CSA C22.2 Nr 65 IACS E10 |
| product certifications | EAC ECEE CB-regeling CCC UL CSA |
| trilling bestendigheid | 5 gn (f= 10...500 Hz) In overeenstemming met IEC 60068-2-6 25 mm piek-piek (f= 2...10 Hz) In overeenstemming met IEC 60068-2-6 |
| schokbestendigheid | 25 gn (duur = 6 ms) voor 1000 schokken op elke as In overeenstemming met IEC 60068-2-27 30 gn (duur = 18 ms) voor halve sinusgolf versnelling In overeenstemming met IEC 60068-2-27 50 gn (duur = 11 ms) voor halve sinusgolf versnelling In overeenstemming met IEC 60068-2-27 |
| weerstand tegen snelle piekspanningen | 2 kV In overeenstemming met IEC 61000-4-4 |
| weerstand tegen elektromagnetische velden | 10 V/m In overeenstemming met IEC 61000-4-3 |
| weerstand tegen elektrostatische ontlading | 4 kV op contact (op metalen onderdelen) In overeenstemming met IEC 61000-4-2 8 kV in open lucht (in isolerende onderdelen) In overeenstemming met IEC 61000-4-2 |
| elektromagnetische emissie | Klasse B In overeenstemming met IEC 55011 |

Verpakkingseenheid

| | |
|---------------------------------|-----|
| Eenheidstype van verpakking 1 | PCE |
| Aantal eenheden in verpakking 1 | 1 |

| | |
|----------------------|----------|
| verpakking 1 hoogte | 3,600 cm |
| verpakking 1 breedte | 5,300 cm |
| verpakking 1 lengte | 9,000 cm |
| verpakking_1_gewicht | 72,000 g |

contractuele waarborg

Garantie (in maanden) 18

Schneider Electric wil tegen 2050 de Net Zero-status hebben bereikt via partnerschappen in de toeleveringsketen, materialen met een lagere impact en circulariteit via onze doorlopende campagne "Use Better, Use Longer, Use Again" om de levensduur van producten en de recycleerbaarheid te verlengen.

[Uitleg van Environmental Data >](#)

[Hoe evalueren we de duurzaamheid van producten? >](#)

Milieuoetafdruk

| | |
|---|----------------|
| Totale levenscyclus ecologische voetafdruk | 1 kg CO2 eq. |
| Koolstofvoetafdruk van de fabricagefase [A1–A3] | 0.6 kg CO2 eq. |
| Koolstofvoetafdruk van de distributiefase [A4] | 0 kg CO2 eq. |
| Koolstofvoetafdruk van de installatiefase [A5] | 0 kg CO2 eq. |
| Koolstofvoetafdruk van de gebruiksfase [B2, B3, B4, B6] | 0.4 kg CO2 eq. |
| Koolstofvoetafdruk van de einde-levensfase [C1–C4] | 0.1 kg CO2 eq. |

Use Better

Materialen en verpakking

| | |
|--|--|
| Gemiddeld percentage gerecycleerde kunststof | 36 % |
| Gemiddeld percentage gerecycleerd metaal | 17 % |
| Pakket met gerecycleerd karton | Ja |
| Verpakkingen zonder kunststof | Ja |
| SCIP-nummer | 3d14fd98-3859-4733-a5ee-a3016769973c |
| RoHS-richtlijn van de EU | Conform door vrijstelling |
| REACH-verordening | Referentie bevat zorgwekkende stoffen (SVHC) boven drempelwaarde |

Use Longer

Levensduurverlenging

| | |
|------------------------|-------------------|
| Reparatie | Nee |
| Productreparatie-index | A |

Use Again

Herverpakken en herfabriceren

| | |
|--|--|
| Percentage mogelijke recycleerbaarheid | 32 |
| Circulair Profiel | Informatie over einde levensduur |
| Terugname | Ja |

Dimensions Drawings

Dimensions

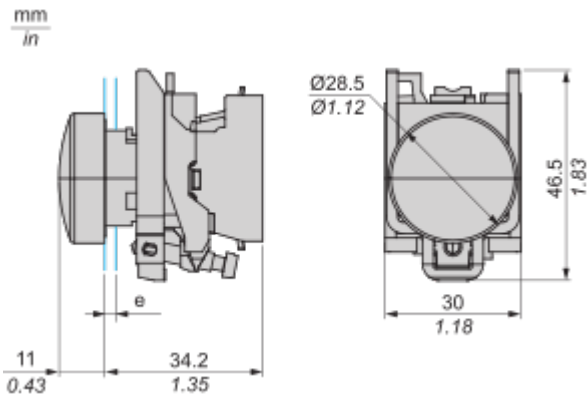

e : Clamping thickness: 1 to 6 mm / 0.04 to 0.24 in.

Mounting and Clearance

Mounting

Mounting and Unmounting



Panel cut-out Dimension

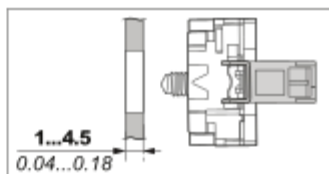
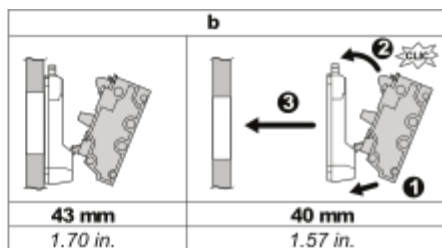
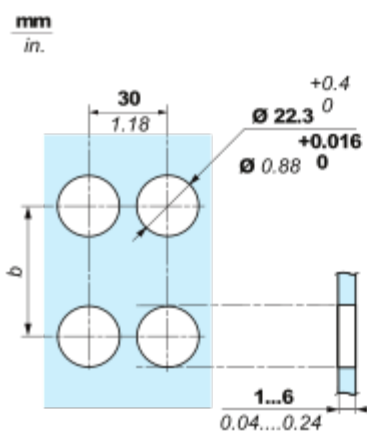

Connections and Schema

Wiring

Wiring and Unwiring



| | |
|-----------------|------------|
| mm | 8 |
| in. | 0.32 |
| mm ² | 0.34...1.5 |
| AWG | 22...16 |

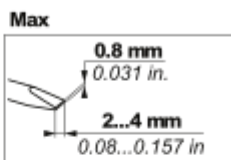

| | | | | |
|-----------------|------------|----------|------------|---------|
| mm | 8 | 8 | 8 | (1) Max |
| in. | 0.32 | 0.32 | 0.32 | |
| mm ² | 0.34...1.5 | 0.34...1 | 0.34...1.5 | (1) Max |
| AWG | 22...16 | 22...18 | 22...16 | |



Technical Illustration

Dimensions

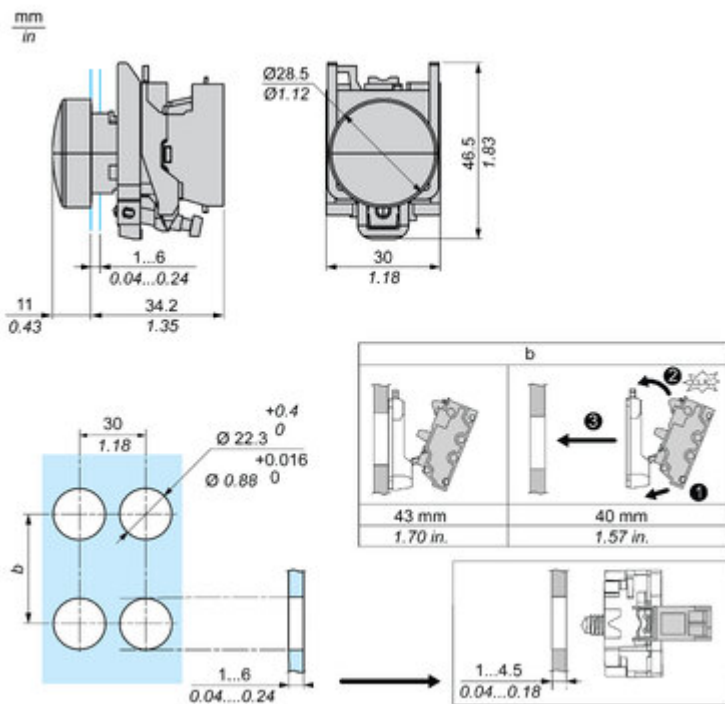

Technical Illustration

Wiring diagram

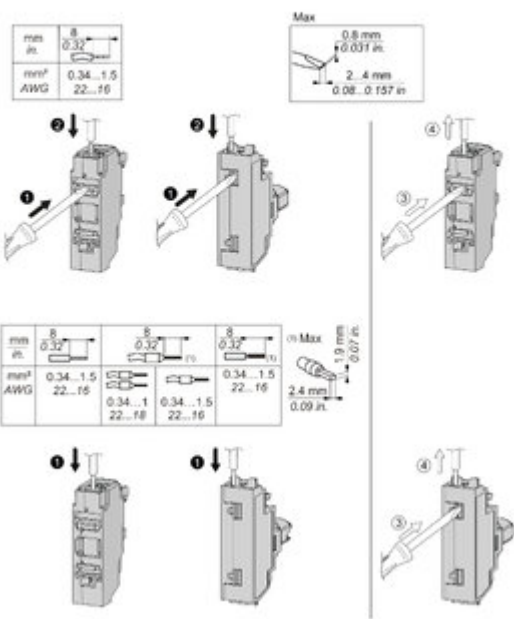

Offer Marketing Illustration

Product benefits / Features

Features

Harmony XB4/XB5 Illuminated functions

- NEW universal LED Block for all colors**: Accompanied by an icon of a square with a smaller square inside. The image shows a green illuminated button with a black LED block being inserted into its back.
- Simple stock management**: Accompanied by an icon of a person with a checkmark. The image shows a black illuminated button with a red LED block.
- Improved installation time and easy selection**: Accompanied by an icon of a circular arrow. The image shows a yellow illuminated button with a black LED block being inserted into its back.
- Improved color intensity and brightness**: Accompanied by an icon of a sun with rays. The image shows a black illuminated button with a red LED block.

Offer Marketing Illustration

Product benefits / Features

Technical Benefits

Harmony XB4

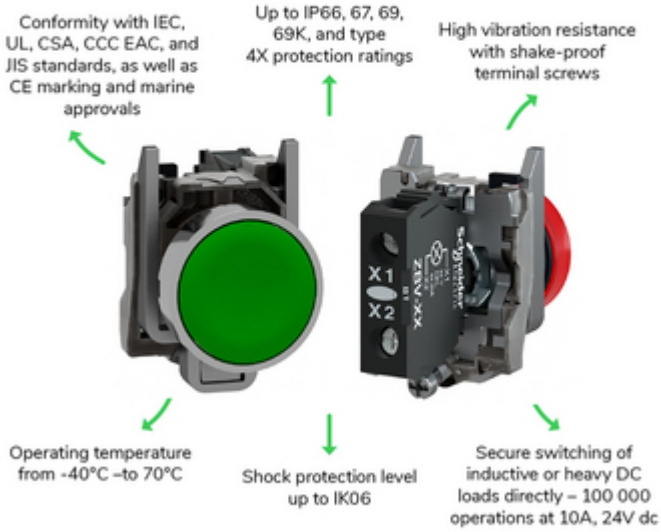

Offer Marketing Illustration

Product benefits / Features

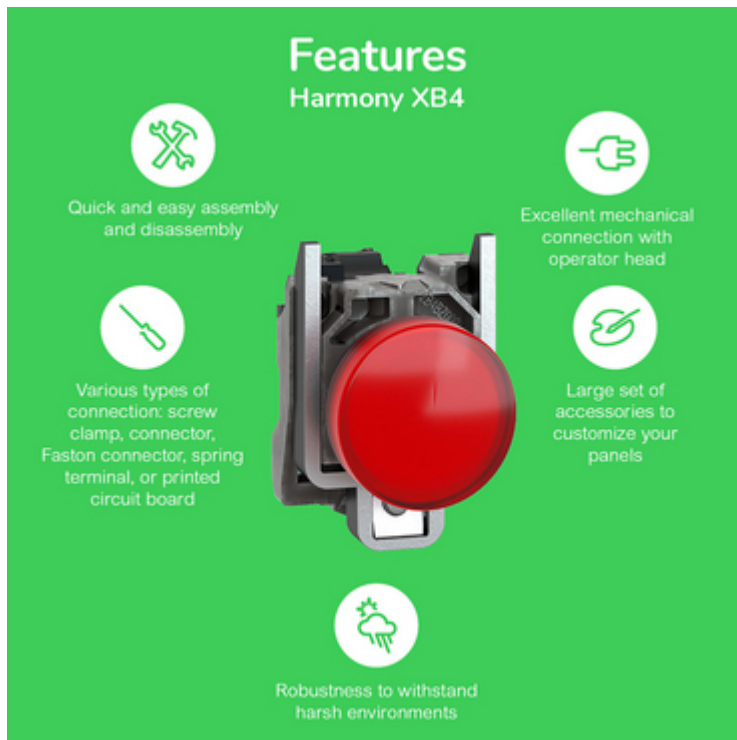

The infographic features a central image of a red Schneider XB4 terminal block. Surrounding it are five circular icons, each with a corresponding text description of a feature. The background is a solid green color.

Features Harmony XB4





-  Quick and easy assembly and disassembly
-  Various types of connection: screw clamp, connector, Faston connector, spring terminal, or printed circuit board
-  Excellent mechanical connection with operator head
-  Large set of accessories to customize your panels
-  Robustness to withstand harsh environments

Image of product / Alternate images

Alternative

