

Decommissioning instructions available to enable responsible recycling or disposal



© Copyright 2024 ABB. All rights reserved.

Contents

1. Purpose and Basic Description	3
2. Dismantling instructions	3
2.1. More than 1 pole product:.....	3
2.2. 1 pole product:.....	4
3. Material Composition.....	5
4. Additional Information.....	5

1. Purpose and Basic Description

This product family is in the scope of European Union directive 2012/19/EU on Waste Electrical and Electronic Equipment (WEEE). The product family must be disposed according to the legislation of the country. This end-of-life instruction is intended for use by customers and recycling companies which outline the responsible recycling or disposal method of the ABB product.

The circuit breakers and miniature circuit breakers of the S200(Z, C)200(L, M), S200M(T)UC product family protect cables and lines against overload and short circuits. The product data can differ within the different series.

2. Dismantling instructions

2.1. More than 1 pole product:

In case of more than 1 pole, first, the handle tie⁽¹⁾ and the two marked rivets⁽²⁾ should be removed to split the product into simple poles.

Afterwards, there are some intermediate pieces⁽³⁾ which can then be easily removed.

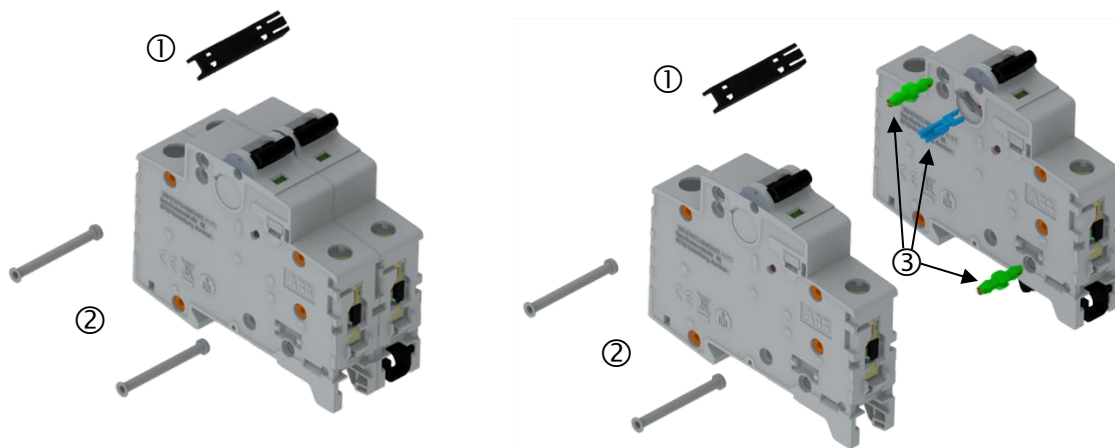

2.2. 1 pole product:

From then on, all individual poles are disassembled in the same way.

First remove the rivets (for products with more than one pole, only 4 rivets remain), then you can remove the cover and access all internal parts.

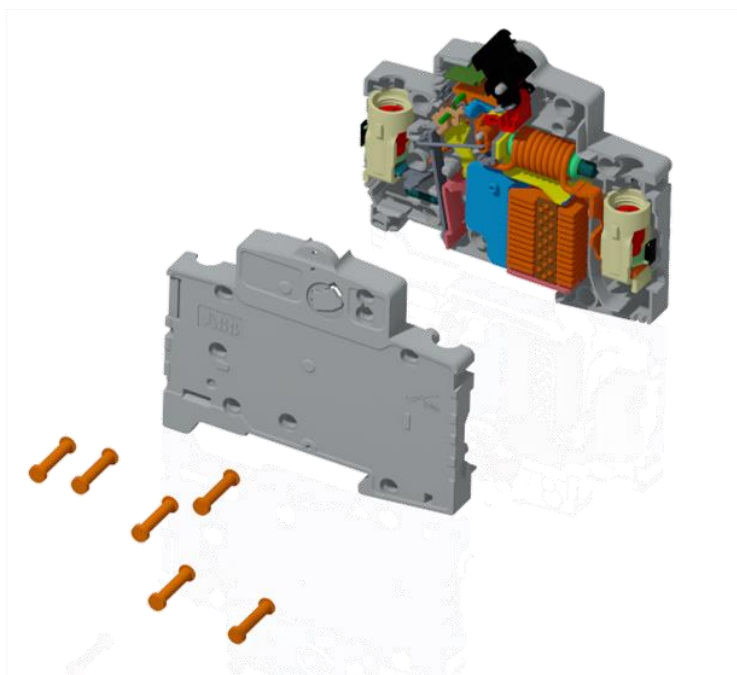

The different parts are extracted as shown in the following figure.

Framed assemblies consist of soldered or riveted parts that cannot be disassembled manually.

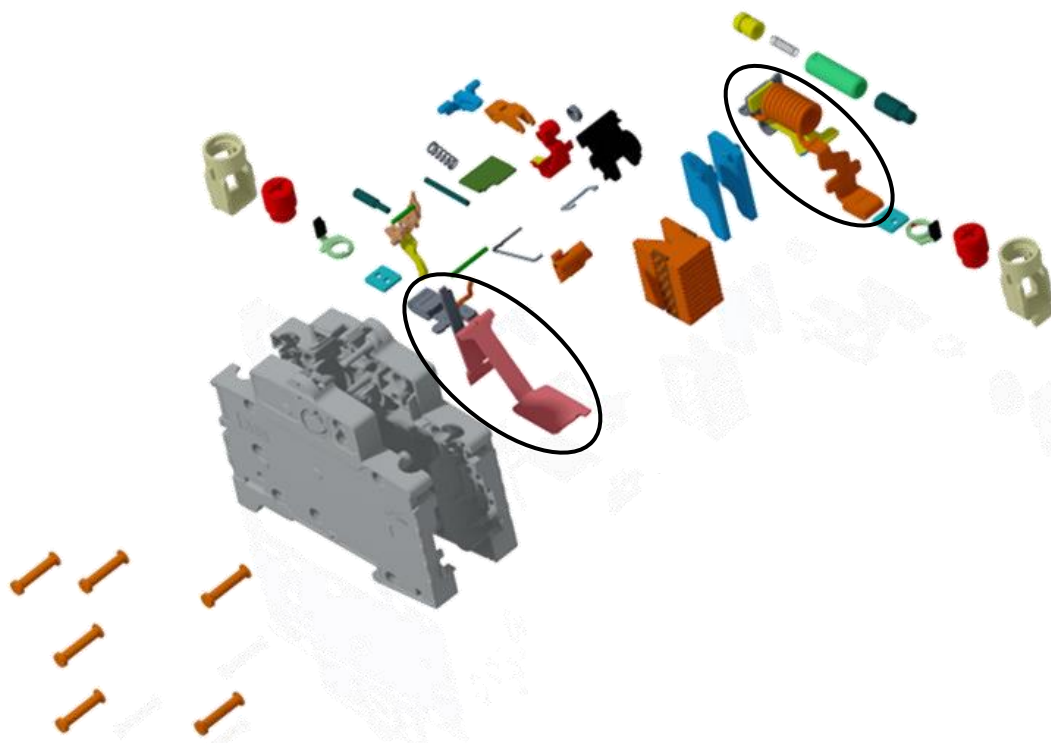

3. Material Composition

S200(L), SZ200, SC200

Plastics		Metals		Packaging	
PA6	29.6%	Steel	52.7%	Cardboard	5.7%
PA66	2.0%	Copper	4.3%	Others	0.1%
POM	1.4%	Aluminum	2.0%		
Others	0.9%	Others	1.3%		

S200M, S200M(T)UC

Plastics		Metals		Packaging	
PA66	30.2%	Steel	51.4%	Cardboard	5.6%
POM	1.4%	Copper	7.3%	Others	0.1%
Others	0.8%	Aluminum	1.9%		
		Others	1.3%		

Weight percentage of a single pole.

4. Additional Information

S200(L), SZ200, SC200

Weight per Pole	112.4 g
Overall dimensions (H x D x W)	88 x 69 x 17.5 mm

S200M, S200M(T)UC

Weight per Pole	115.6 g
Overall dimensions (H x D x W)	88 x 69 x 17.5 mm