

SensoWash[®] Starck

安装说明

Mounting instructions

智能马桶盖

Shower toilet unit

610000 00 2 01 1000

610200 00 2 01 1000



重要说明



电气安装/水管安装

4

Important information

Electrical/water installation

6

zh
en



安装, Installation

8



重要说明

关于安装说明书

本安装说明书是 Duravit 智能马桶的组成部分，安装前须认真阅读。

信息词及符号的解释

⚠ 危险！ 有致命危险或严重伤害的高风险

注意！ 避免发生物品损失



请参阅章节电气安装



请参阅本章节中的安装说明



请参阅章节水管安装

目标读者及安装工资质

智能马桶盖和相关水管的连接只能由合格的管道工安装。电气安装仅允许由有电工资质的电气安装人员实施。

注意！

必须无条件遵守当地的安装规定、相关的国家标准和低压准则。

注意！

请勿将智能马桶盖安装在有冻结危险的室内。室内温度不得低于 4°C

注意！

如果将智能马桶盖从寒冷处转移至温暖地点，可能出现冷凝湿气。

› 请关闭设备数小时。

安全提示

⚠ 危险！
触电可能导致生命危险。

› 请勿拆卸智能马桶盖的零部件。

⚠ 危险！
触电可能导致生命危险。

› 如果电源软线损坏，为了避免危险，必须由制造商、其维修部或类似部门的专业人员更换。

› 器具必须接地。

安装说明

安装前请查阅技术图纸看装前数据。技术图纸可从 www.duravit.com 下载。

1 检查安装要求（图 1）
预装智能马桶盖的水电附件的安装已包括在相应的陶瓷马桶安装说明中。
› 请确保水电附件以及陶瓷马桶是按照说明和规定安装的。

27 遥控器支架定位（图 27）
› 从第30步起，安装防盗装置。
› 至第29步，安装无防盗装置的遥控器支架。

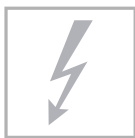

电气安装



水管安装



额定功率	1080 W
额定电源	220-240V 50/60 Hz
断路器	$I_N = 16 \text{ A}$
漏电断路器	$I_N = 30 \text{ mA}$
防护类型	IP X4
防护等级	1

冷水	DN 15(½")
水压	0.07 - 0.75 MPa (0.7 - 7.5 bar)
水硬度	最大值 2.4 mmol/l

提示!

- 当水的硬度为 $\geq 2.4 \text{ mmol/l}$ ($\geq 14^\circ \text{ dH}$ 或 24° fH)，则安装水软化装置。

电气连接/水管连接位置壁挂式马桶

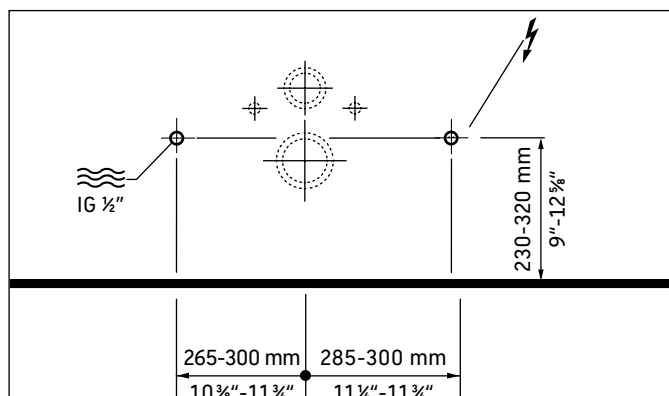

电气连接/水管连接位置独立马桶

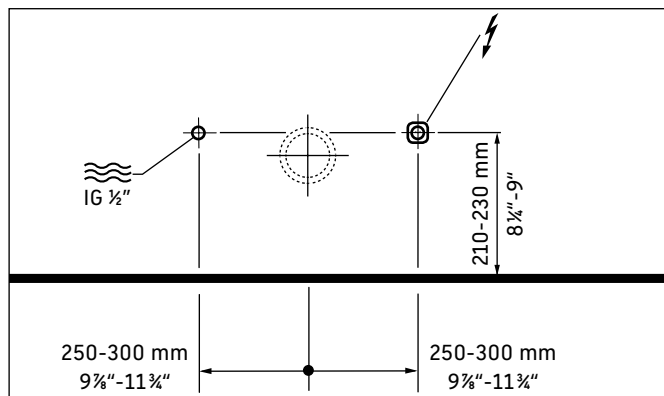

⚠ 危险!

触电可能导致生命危险。

- 连接智能马桶盖时，请勿使用未接地的延长线。

20 连接智能马桶盖 (图 20)

注意! 避免财产损失。

- 只能将智能马桶盖连接到符合规定负荷的插座上。

- 请确保安装完成后，用户能使用电源插头。

预先安装

- 请在规定区域安装供水接口和排水出口。

⚠ 危险!

健康风险和可能的产品损失。

- 智能马桶盖的冷水应从主供水管道连接。
- 请勿连接废水、脏水、工业用水、海水或其他未处理和适半处理的水。

10 挂壁式马桶的水管连接 (图 10)

注意! 避免发生故障。

- 请使用器具附带的新软管组件，旧软管组件不能重复利用。

17 独立式马桶的水管连接 (图 17)

注意! 避免发生故障。

- 请使用器具附带的新软管组件，旧软管组件不能重复利用。



Important information

About the mounting instructions

These mounting instructions come as part of the Duravit Shower WC and should be read carefully prior to installation.

Explanation of the key words and symbols

⚠ DANGER! At high risk of fatal hazards or serious injuries

NOTE! To avoid property damage



Link to the **Electrical Installation** section



Link to the **installation information** in this section



Link to the **Water Installation** section

Target Readership and Qualifications

The Shower WC and associated water connection may only be installed by qualified plumbers. The electrical installation may only be carried out by qualified electricians.

NOTE! Local installation regulations, country-specific standards and the low voltage directives must be observed at all times.

NOTE! DO NOT install the Shower WC in rooms where there is a danger of frost. The room temperature must not be less than 4 °C.

NOTE! Condensation may form when the Shower WC unit is brought from a cold location to a warm one.
> Leave the unit switched off for a few hours.

Safety instructions

⚠ DANGER!
Risk of fatal electric shock.

> Do NOT remove individual Shower WC components.

⚠ DANGER!
Risk of fatal electric shock.

- > If the supply cord is damaged, it must be replaced by the manufacturer, its service agent or similarly qualified persons in order to avoid a hazard.
- > Appliances have to be earthed.

Installation Instructions

Please read pre-installation data sheets prior to the installation. These are available to download on the Internet at www.duravit.com.

1 Checking the installation requirements (Diagram 1)

- The installation of the WC ceramics with pre-installation of the Shower WC water and power supplies is described in separate instructions.
- > Ensure that the supplies and WC ceramics have been installed and mounted according to the instructions and regulations.

27 Positioning the remote control mounting bracket (Diagram 27)

- > Continue with step 30 to install the anti-theft device.
- > Follow the instructions up to step 29 to install the mounting bracket without the anti-theft device.



Electrical installation



Water installation



Rated power input	1080 W
Rated power supply	220 – 240V 50/60Hz
Circuit breaker	$I_N = 16$ A
RCCB	$I_N = 30$ mA
Protection type	IP X4
Protection class	1

Cold water	DN 15(1/2")
Water pressure	0.07 - 0.75 MPa (0.7 - 7.5 bar)
Water hardness	max. 2.4 mmol/l

NOTE!

- > Install a water water softener with water hardness ≥ 2.4 mmol/l ($\geq 14^\circ$ dH and/or 24° fH).

Position of electrical / water connection with wall-mounted WC

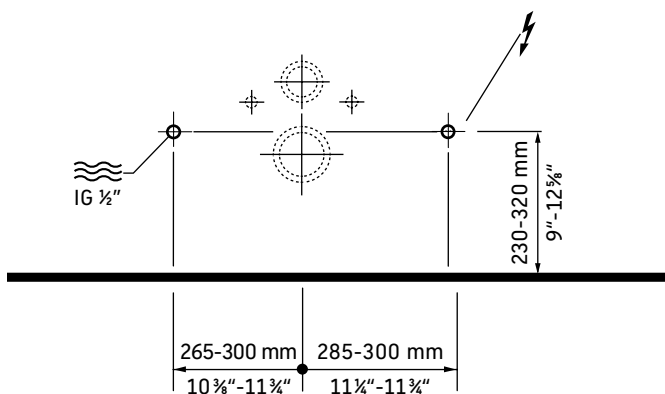

Position of electrical / water connection with floor-standing WC

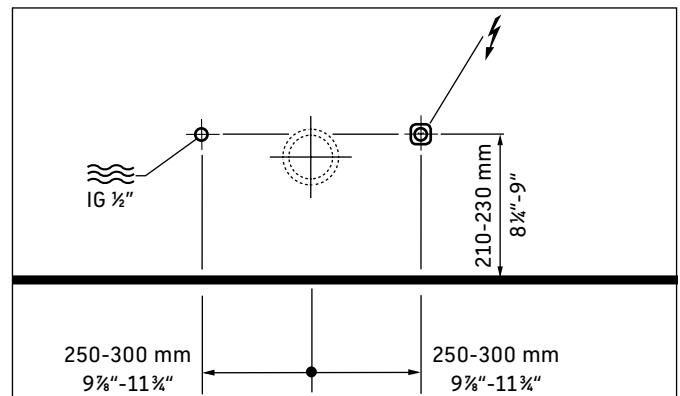

⚠ DANGER! Risk of fatal electric shock.

- > Do not use any unearthed extension cables when connecting the Shower WC.

20 Connecting the Shower WC (Diagram 20)

NOTE! Avoiding property damage.

- > Only connect the Shower WC to a socket with the stipulated connected loads.
- > Ensure that the power plug is accessible to users after the installation.

Pre-Installation

- > Install the water connection and water outlet in the specified areas.

⚠ DANGER! Health risk and potential product damage.

- > Supply the WC with cold drinking water from the main water system.
- > Do not connect any waste water, grey water, industrial water, sea water or other untreated or semi-treated water.

10 Connecting water to a wall-mounted WC (Diagram 10)

NOTE! Avoiding any malfunctions!

- > The new hose-sets supplied with the appliance are to be used and old hose-sets should not be reused.

17 Connecting water to a free-standing WC (Diagram 17)

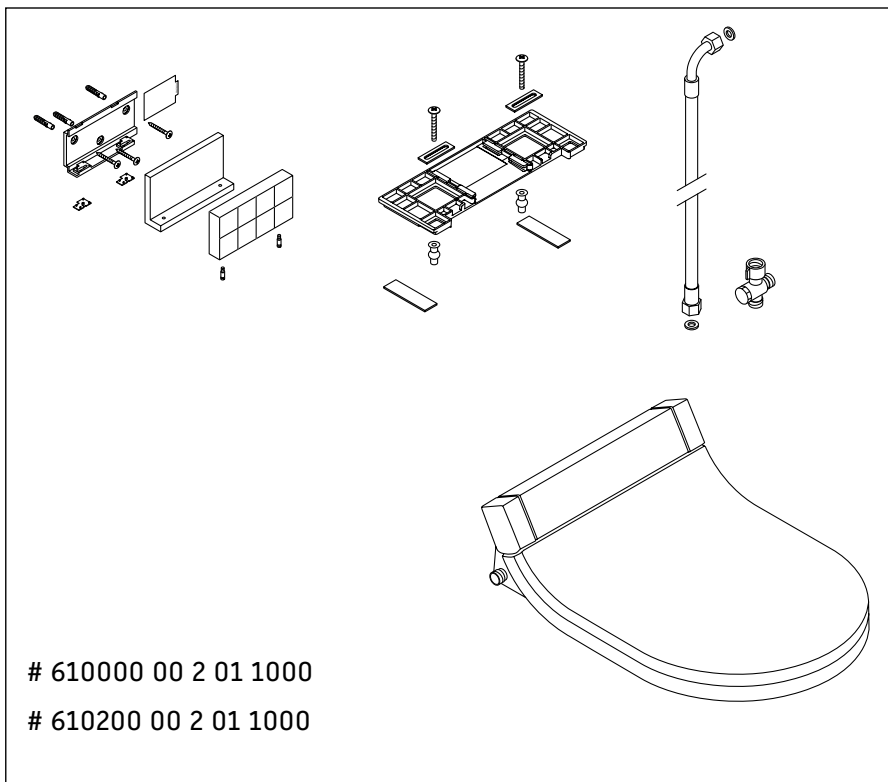

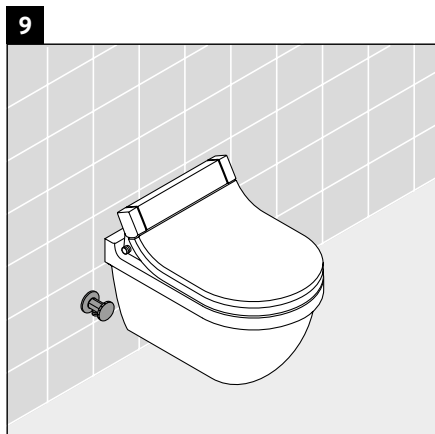
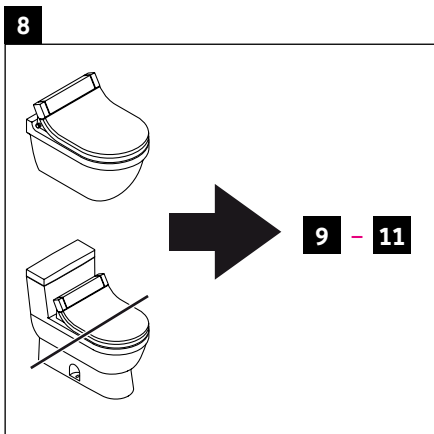
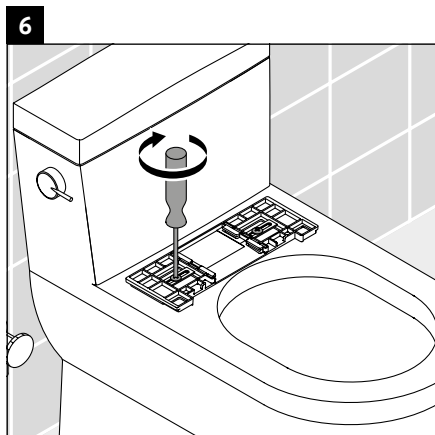
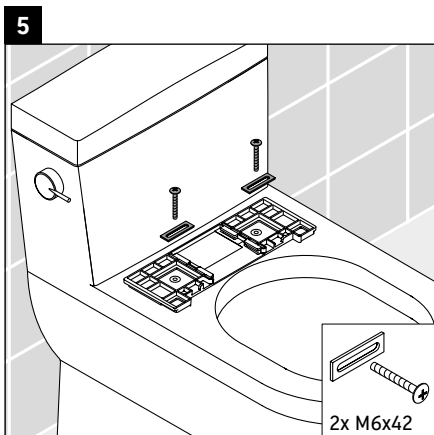
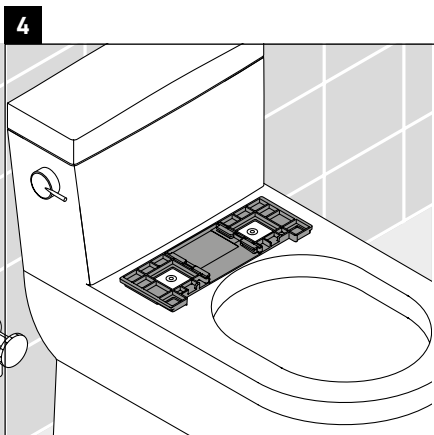
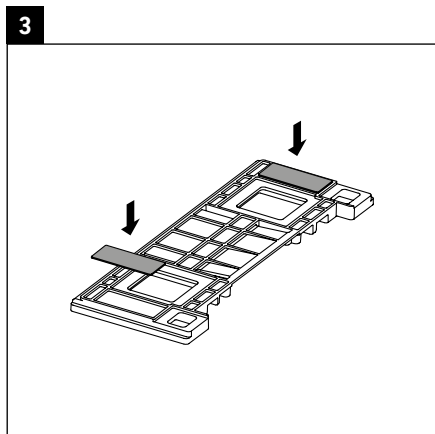
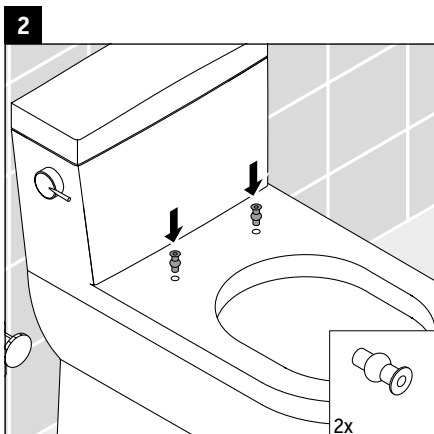
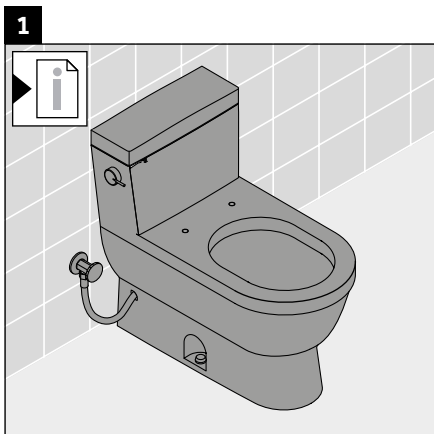

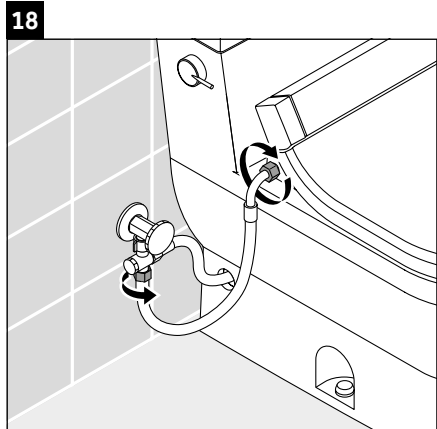
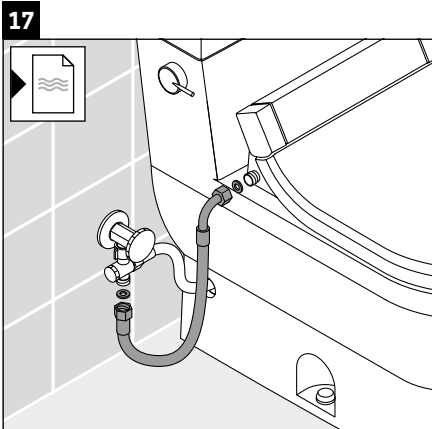
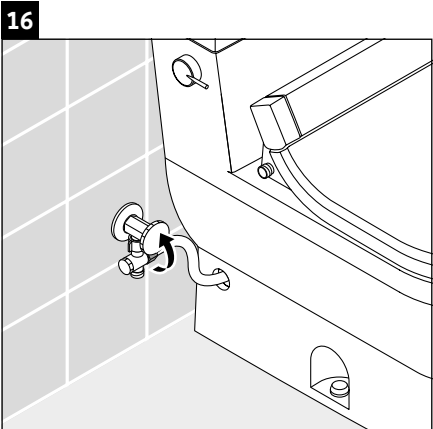
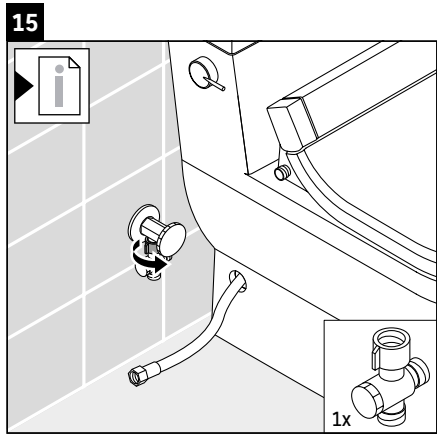
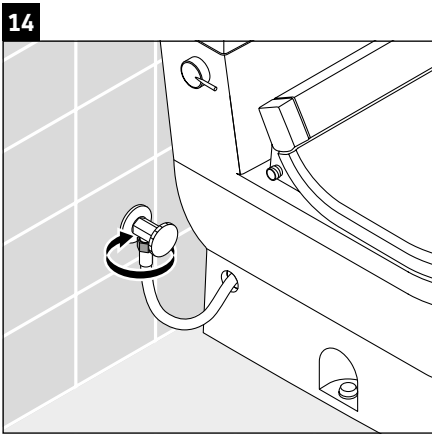
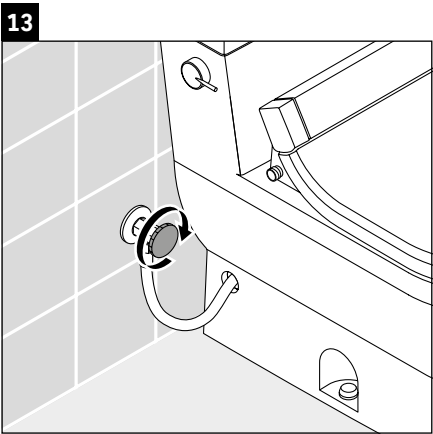
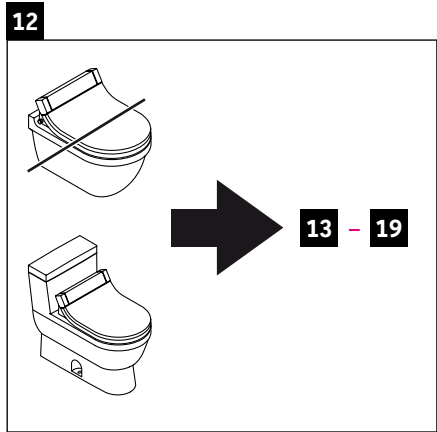
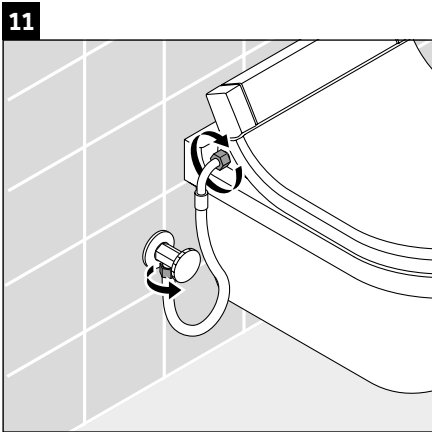
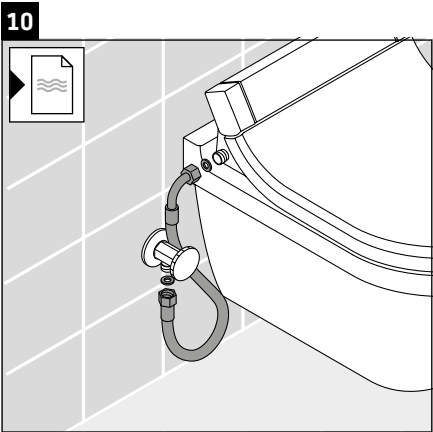

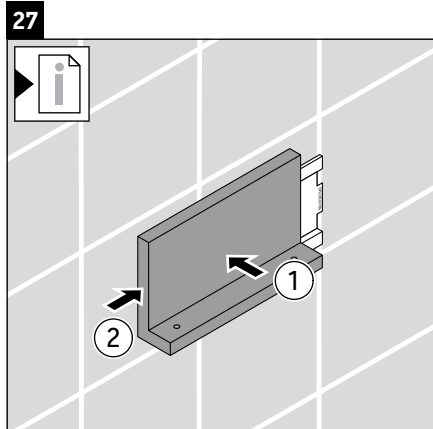
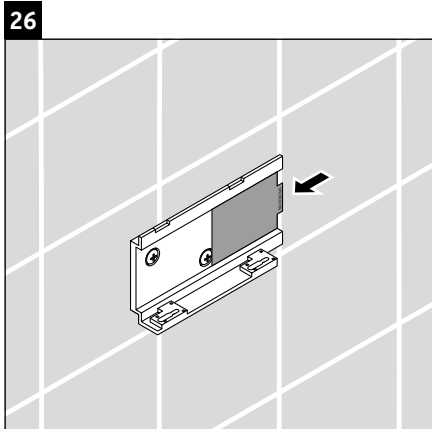
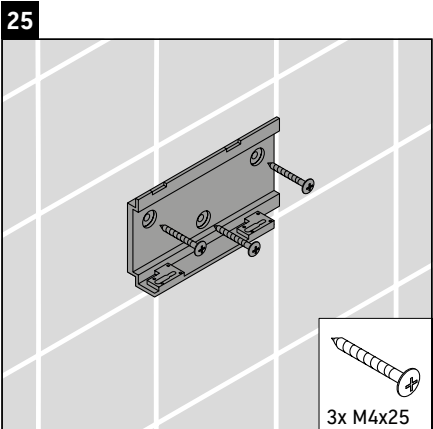
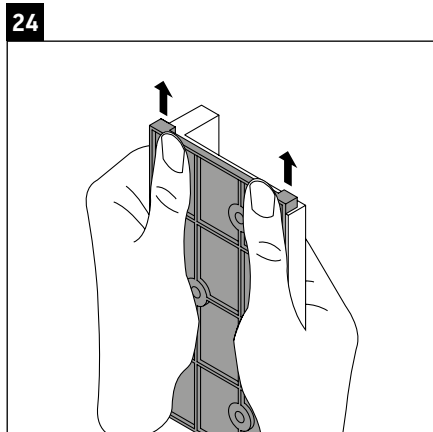
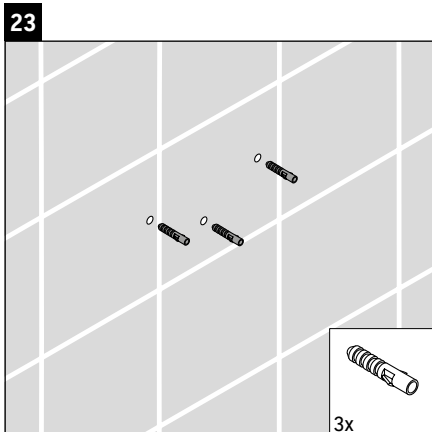
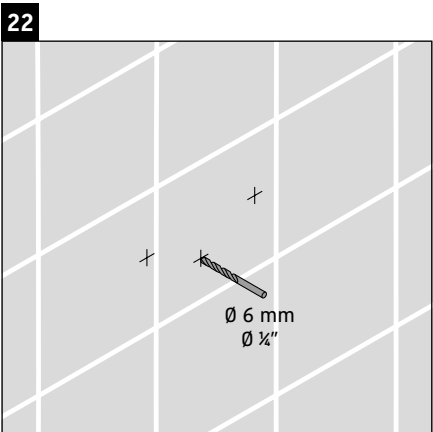
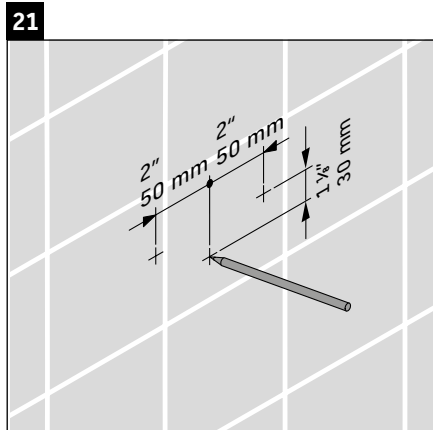
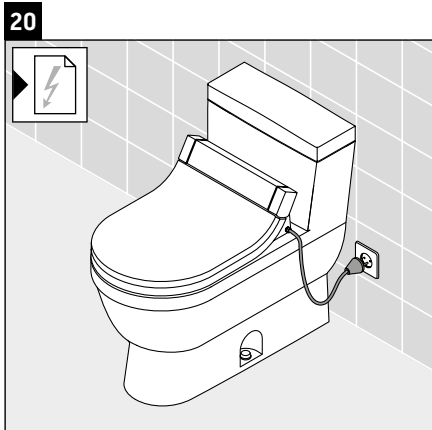
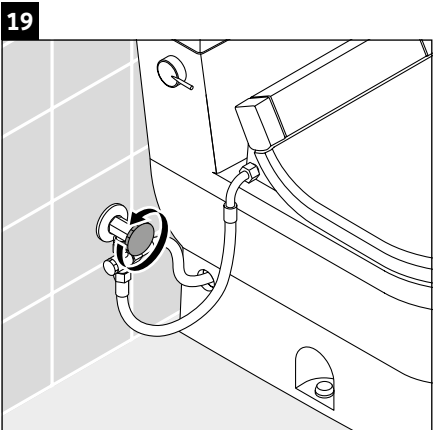

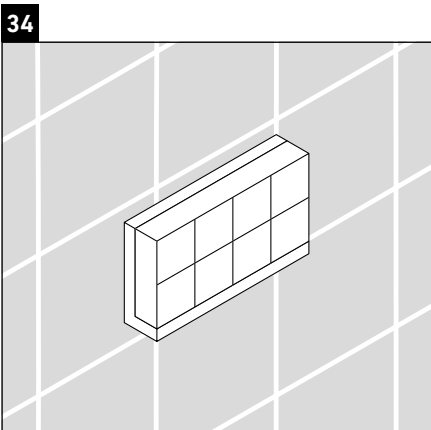
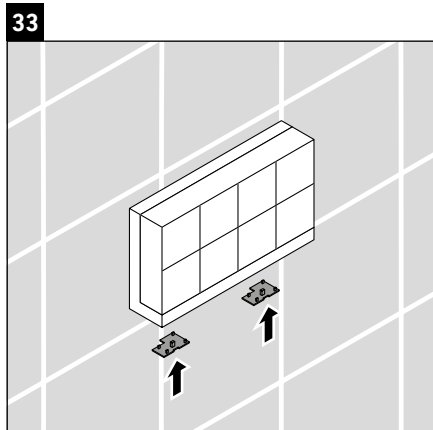
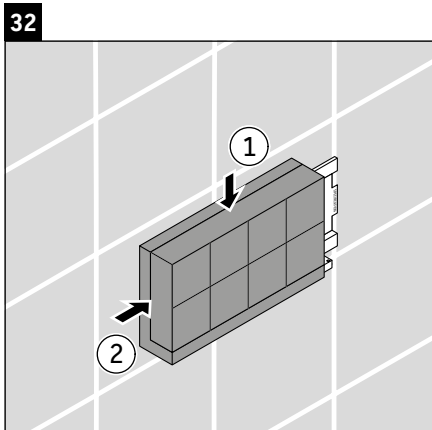
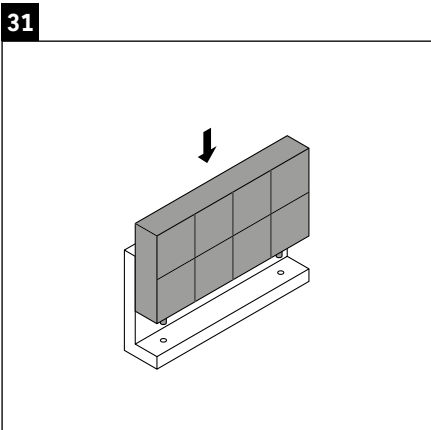
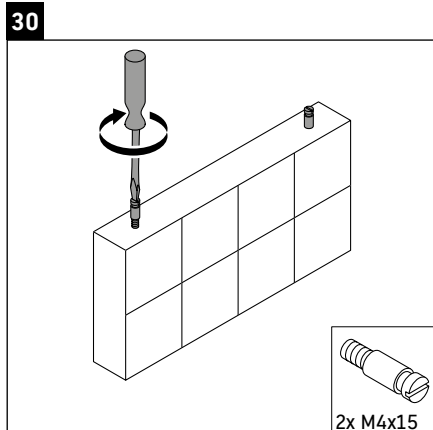
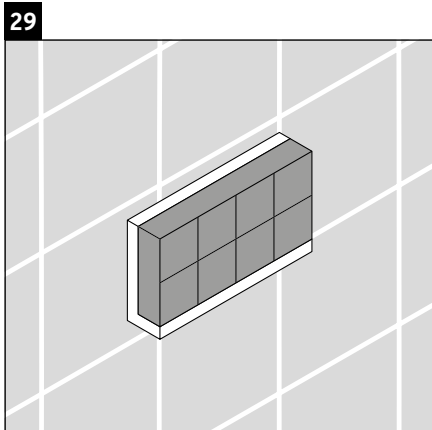
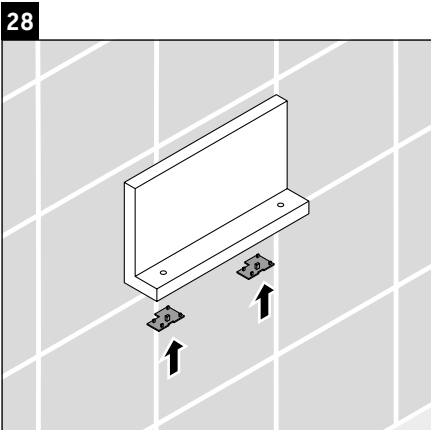

Duravit AG
P.O. Box 240
Werderstr. 36
78132 Hornberg
Germany
Phone +49 78 33 70 0
Fax +49 78 33 70 289
info@duravit.com
www.duravit.com

杜拉维特（中国）洁具有限公司
重庆市江津区珞璜工业园B区园区大
道88号
客服电话 +86 21 61542410
周一至周五 9:00-12:00; 13:00-17:00
info@cn.duravit.com
www.duravit.cn
www.sensowash.cn
