

Product data

Product code	VI03-0028	STK-code	6436028	EAN-code	6410064360288
Product name	Grounding ball 30mm + adapt. M12x35			ETIM class	EC002793
Wires	Straight with female thread				

Technical data

		-	
		-	
Nominal voltage (IEC)		1000	V
		-	
		-	
		-	
Number of poles		1	pcs
Max. Cross section		150	mm ²
Tightening torque			
	M12	50-80	Nm
		-	
		-	
		-	
		-	
		-	
Weight		329	g
		-	
Standards	SFS 3742:1985, EN 61230:2008 (5.7.)		
Color / Material	Tin plated / Copper		
Mounting / Connection	Screw M12, Min. 8.8		

Description

Permanent grounding ball studs to be used for grounding in different electrical systems such as switchgear, bus bars, conductors, vehicles, reels etc. The Grounding ball stud is made of forged copper and it is coated with tin. Assemblies include grounding ball stud, stainless steel adapter, washer and nut for fastening. Max. Short-circuit current I_k 1 s 29,6 kA / 1 s.

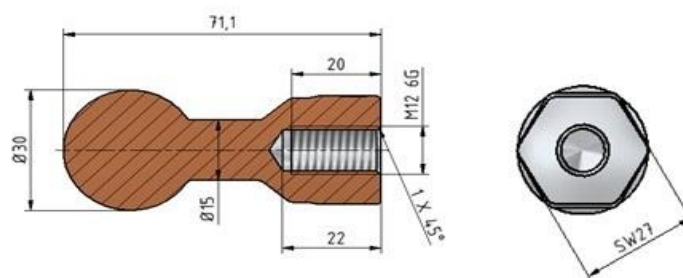
Drawing

Package

Package	Box	Pcs / Package	20	Weight [kg]	6,63
Length [mm]	210	Width [mm]	155	Height [mm]	105

Ouneva Oy

Teollisuustie 21
FI-82730 Tuupovaara
Finland

www.ounevagroup.fi
www.ounevaproducts.fi