

Concord

CONCORD BEACON MUSE 2700K O/B DIM BLACK 2062562



Features

- Simple and slick integral design with no driver box and without any visible screws

New technology utilization for improved performance

Invisible in-track adaptor for an impressive architectural look

Extremely precise light beams due to the high-quality lens #80mm die-cast aluminium body,

Adjustable beam angle: between 8° - 55° , Textured black finishing colour

Light color temperature: 2700K, candle light

System power: 18W, Fixture lumen output: 940lm, efficacy: 52lm/W, Ra97 typical, LED chromacity: 2 step MacAdam ellipse LED source (SDCM2), IR/UV free light source without heat radiation

Operating voltage 220-240V / 50-60Hz, dimmable via on-board potentiometer, suitable for installation on 3-circuit tracks, please check compatibility list on the instruction sheet.

Compatible with OneTrack

Electrical protection: Class II. Degree of protection: IP20, suitable for indoor environment only

Horizontal rotation: 355°, vertical tilt: 90°

Nominal product dimensions: D.80mmx215mm

5 years warranty. Suitable for track mounting

Product Overview

Product name	CONCORD BEACON MUSE 2700K O/B DIM BLACK
Technology	LED
Cap/Base	N/A
Housing	Aluminium
Mount	Track mounting
Fixture rating	Enclosed
General application	Museums & Galleries, Retail, Hospitality
ETIM Class	EC001744
E-number FI	4170388
Fixture luminous flux (lm)	940

Concord

CONCORD BEACON MUSE 2700K O/B DIM BLACK 2062562

Luminaire efficacy (lm/W)	52
LOR (%)	100
Correlated colour temperature (k)	2700
Light colour	Candlelight
CRI (Ra)	97
Colour Variation Initial (SDCM)	2
Beam Angle (°)	55
Photobiological Risk Group	RG1
Total power consumption (W)	18
Electrical protection	Class II
Control gear type	LED driver constant current
Dimmable	Yes
Minimum dimming level (%)	1
Housing colour	RAL 9005 - Jet black
IP rating	IP20
IK rating	IK02
Product EAN number	5025768625628
Warranty	5 years
Dimming method	Onboard pot
Useful luminous flux (#use)	940

Photometry

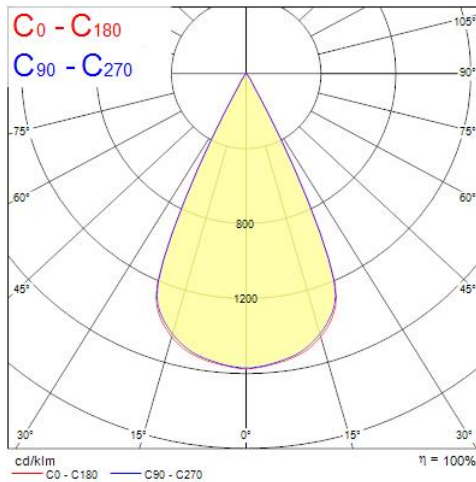
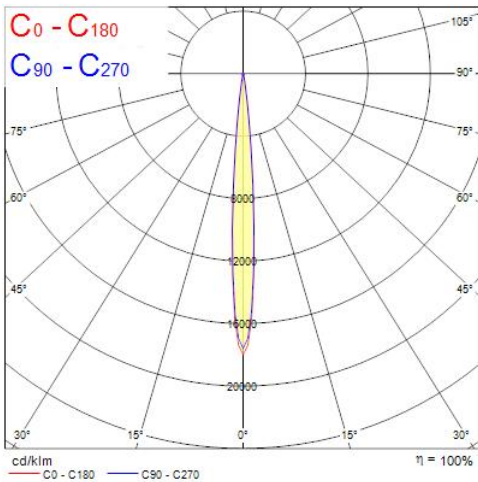

Distance [m]	Cone diameter [m]	E(0°)	E(C90)	E(C0)	Illuminance [lx]
0.5	0.08 0.08	36632	4.4° 17264	4.3° 18009	
1.0	0.15 0.15	8908	4.4° 4316	4.3° 4502	
1.5	0.23 0.23	3869	4.4° 1916	4.3° 2001	
2.0	0.31 0.30	2227	4.4° 1079	4.3° 1125	
2.5	0.38 0.38	1425	4.4° 691	4.3° 720	
3.0	0.45 0.45	990	4.4° 450	4.3° 500	

Distance [m] Cone diameter [m] Illuminance [lx]

— C0 - C180 (Half beam angle: 8.6°)
— C90 - C270 (Half beam angle: 8.6°)

Concord

CONCORD BEACON MUSE 2700K O/B DIM BLACK 2062562

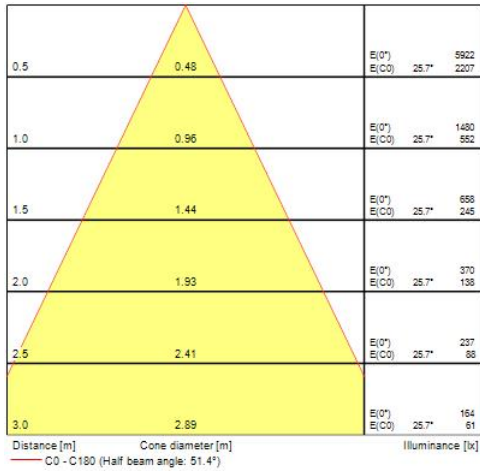

Technical drawings

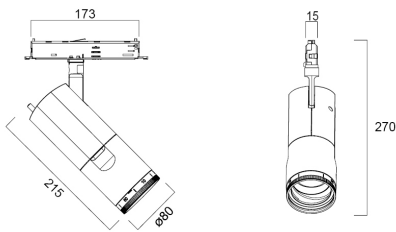

Data table

GENERAL DATA

Product name	CONCORD BEACON MUSE 2700K O/B DIM BLACK
Technology	LED
Cap/Base	N/A
Housing	Aluminium
Mount	Track mounting
Fixture rating	Enclosed
General application	Museums & Galleries, Retail, Hospitality
Operating temperature range (°C)	-10°C...+35°C
ETIM Class	EC001744

Concord

CONCORD BEACON MUSE 2700K O/B DIM BLACK 2062562

E-number FI	4170388
Warranty	5 years

OPTICAL DATA

Useful luminous flux (#use)	940
Fixture luminous flux (lm)	940
Luminaire efficacy (lm/W)	52
LOR (%)	100
Correlated colour temperature (k)	2700
Light colour	Candlelight
CRI (Ra)	97
Colour Variation Initial (SDCM)	2
Luminous Intensity (cd)	940
Beam Angle (°)	55
Distribution type	Symmetric
Photobiological Risk Group	RG1

ELECTRICAL DATA

Total power consumption (W)	18
Current (A)	0.082
Primary Supply/Product voltage - min (V)	220.0
Primary Supply/Product voltage - max (V)	240.0
Lamp power factor	0.9
THD (at 230 V, 50 Hz, full load, at 100% dimming level) ≤ xx.x %	7.9
Electrical protection	Class II
Control gear required	No
Control gear type	LED driver constant current
Dimmable	Yes
Dimming method	Onboard pot
Minimum dimming level (%)	1
Drive current (mA)	500
Inrush Current (A)	5
Inrush Duration (µs)	50

Concord

CONCORD BEACON MUSE 2700K O/B DIM BLACK 2062562

Glow Wire Test (°C)	650
Energy Efficiency Class (A->G) of contained light source	F
Nominal Frequency (Hz)	50/60Hz
Max. products per 10A C Breaker	31
Max. products per 13A C Breaker	65
Max. products per 16A C Breaker	85
Max. products per 20A C Breaker	104
Max. products per 10A B Breaker	31
Max. products per 13A B Breaker	39
Max. products per 16A B Breaker	50
Max. products per 20A B Breaker	62

LIFETIME DATA

Lifespan L70 B50	100000
Lifespan L80 B50	100000
Lifespan L90 B50	49000

PHYSICAL DATA

Housing colour	RAL 9005 - Jet black
IP rating	IP20
IK rating	IK02
Diffuser finish	Frosted
Diffuser material	Other
Reflector finish	Matt
Nominal Product Length (mm)	215
Nominal Product Width (mm)	80
Nominal Product Height (mm)	270
Nominal Product Diameter (mm)	80
Weight (kg)	0.94

PACKAGING

Product EAN number	5025768625628
Packaging single length / height (cm)	30.5

Concord

CONCORD BEACON MUSE 2700K O/B DIM BLACK 2062562

Packaging single width (cm)	13.5
Packaging single depth (cm)	20.5
DUN14 (inner)	05025768625628
Units per outer package	1
Packaging outer length / height (cm)	30.5
Packaging outer width (cm)	13.5
Packaging outer depth (cm)	20.5

SAFETY DATA

Optimal operating condition (°C)	-10-35
Special purpose lamp	No
Dry applications use only	Yes
Suitable for household illumination	No