

**Simon 400**

Round USB  
sockets for  
furniture

**simon**

# Simon|400

**Always going from one place to another is something that has been done since prehistoric times. Something that today has reemerged strongly in our work environment.**

**And being able to work in the tranquility of that corner and for two hours in the meeting room, is have a million offices in one.**

**It is making a static routine into a more dynamic and functional one. It's choosing where to sit based on the day, whether you need to concentrate or where the sun hits in the afternoon. It is choosing where to sit based on the agenda, the meetings or what is happening today. have to do.**

**It is returning to the origins.**

**It is to be again.**

**Simon presents Simon 400;  
because the workplace changes every day.**







**SINGLE  
SOLUTIONS**

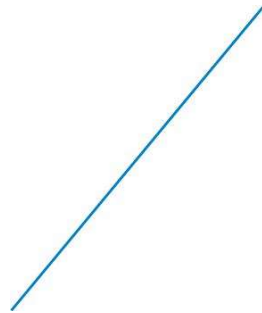

**The Simon 400 series inside the desktop also offers connection sockets individuals o circular for panel office furniture.**

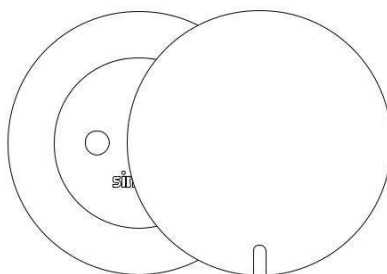
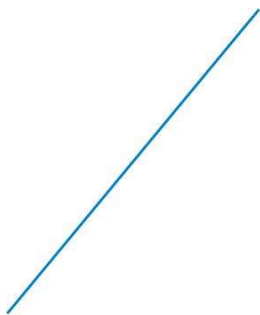

**mobile desktop for  
a single user**



**Courtesy socket on  
office furniture**



**Other applications and  
domestic**

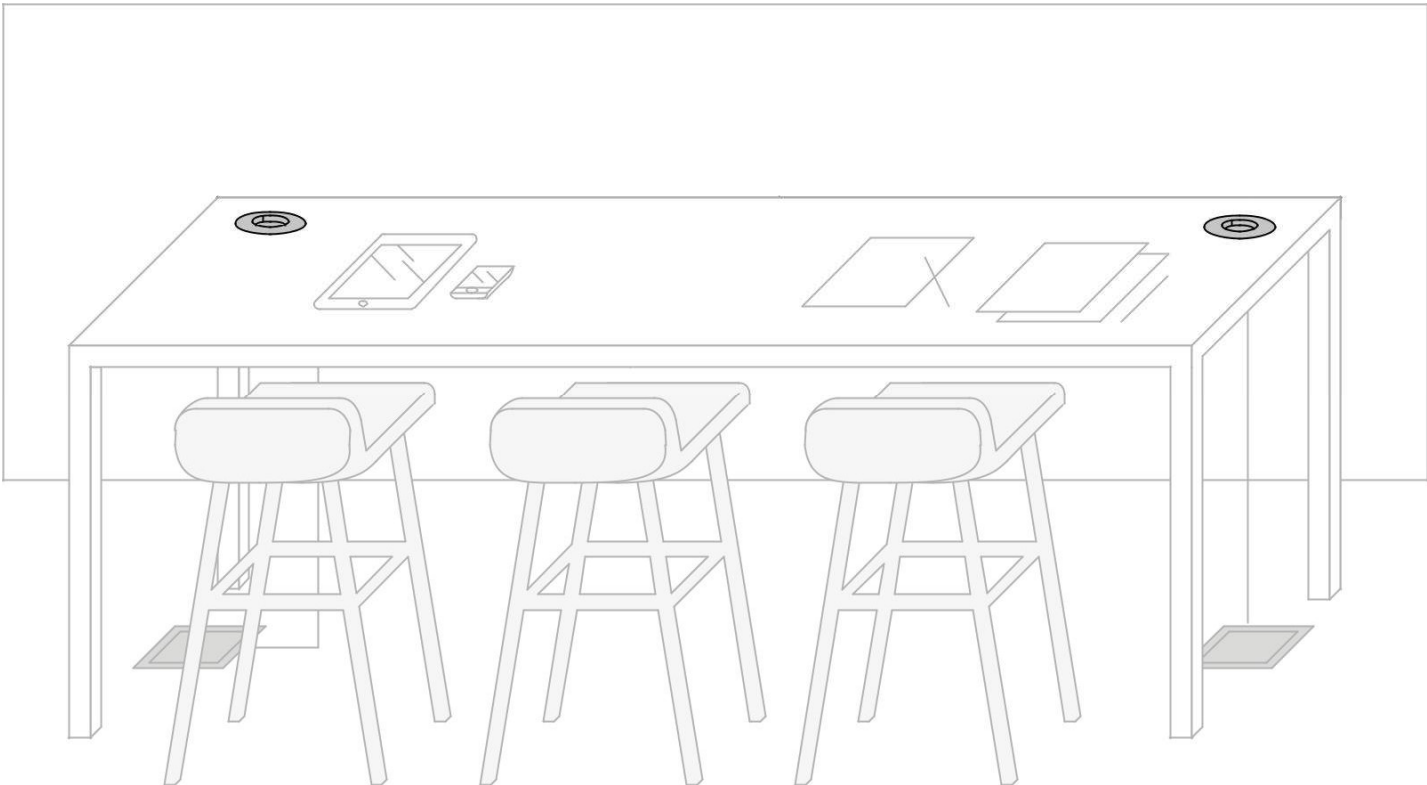

## ASSEMBLED AND WIRED FAST AND SAFE



### Assembled and wired

Supply in kit format. All the necessary components in a single reference.

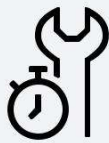

### Quick and easy installation

Wiring options with quick connector or free end.

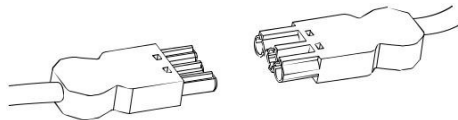

Simple installation from the top. Standard 54mm drilling hole.

Possibility of complete flushing by CNC.



### Anti humidity

Drainage system at the bottom to eliminate liquid in case of fall



## SINGLE SOLUTIONS



**Single socket outlet**  
Schuko or French socket outlet. With protective cap option.







**USB type A+C charger**  
15.5W 5V / 3.1A | 18.0W 9V / 2.0A | 18.0W 12V / 1.5A  
Compatible with QuickCharge technology. With protective cap option.

# SOCKET

Solutions that provide the most with the minimum space. To integrate into any workspace.

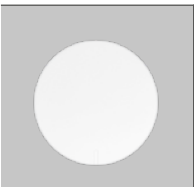

	REFERENCE	DESCRIPTION	GAPS
	<b>43101000</b> - 130 - 138	Panelable power outlet with Schuko socket base with 20 cm hose ending at the free end	1
	REFERENCE	DESCRIPTION	GAPS
	<b>43101002</b> - 130 - 138	Panelable power outlet with Schuko socket base with 20 cm hose ending in quick connector	1
	REFERENCE	DESCRIPTION	GAPS
	<b>43101000</b> - 230 - 238	Panelable power outlet with hose terminated at the free end	1
	REFERENCE	DESCRIPTION	GAPS
	<b>43101002</b> - 230 - 238	Panelable power outlet with hose ending in quick connector	1
	REFERENCE	DESCRIPTION	GAPS
	<b>43100001</b> - 130 - 138	Accessory cover for panelable power outlets	1

## USB A+C CHARGER

Solutions that provide the most with the minimum space. To integrate into any workspace.

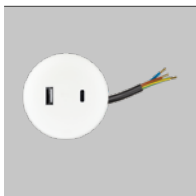

REFERENCE	DESCRIPTION	GAPS
<b>43120000</b> - 130 -138	White panelable USB A+C charger with 20 cm hose ending at the free end	1



REFERENCE	DESCRIPTION	GAPS
<b>43120200</b> - 130 -138	White panelable USB A+C charger with 20 centimeter hose ending in quick connector	1

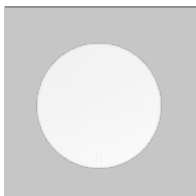

REFERENCE	DESCRIPTION	GAPS
<b>43100002</b> - 130 -138	USB A+C charger accessory cover	1

## CHARACTERISTICS

### TECHNIQUES

Plastic components made of thermoplastic materials, self-extinguishing and halogen-free, which guarantee the non-propagation of the flame due to fire and low toxicity in the event of smoke emission.

Claw working range: 10 to 50 mm

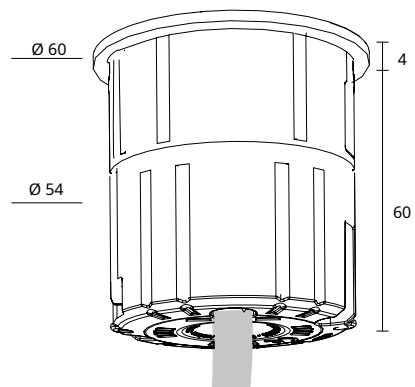

## FINISHES

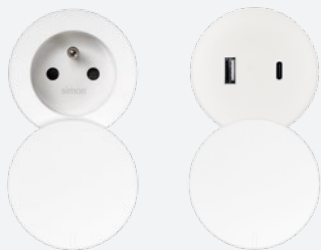

White RAL 9016



Black RAL 9005



# FACILITY

Panelable sockets for installation in furniture



Facility:inside the table

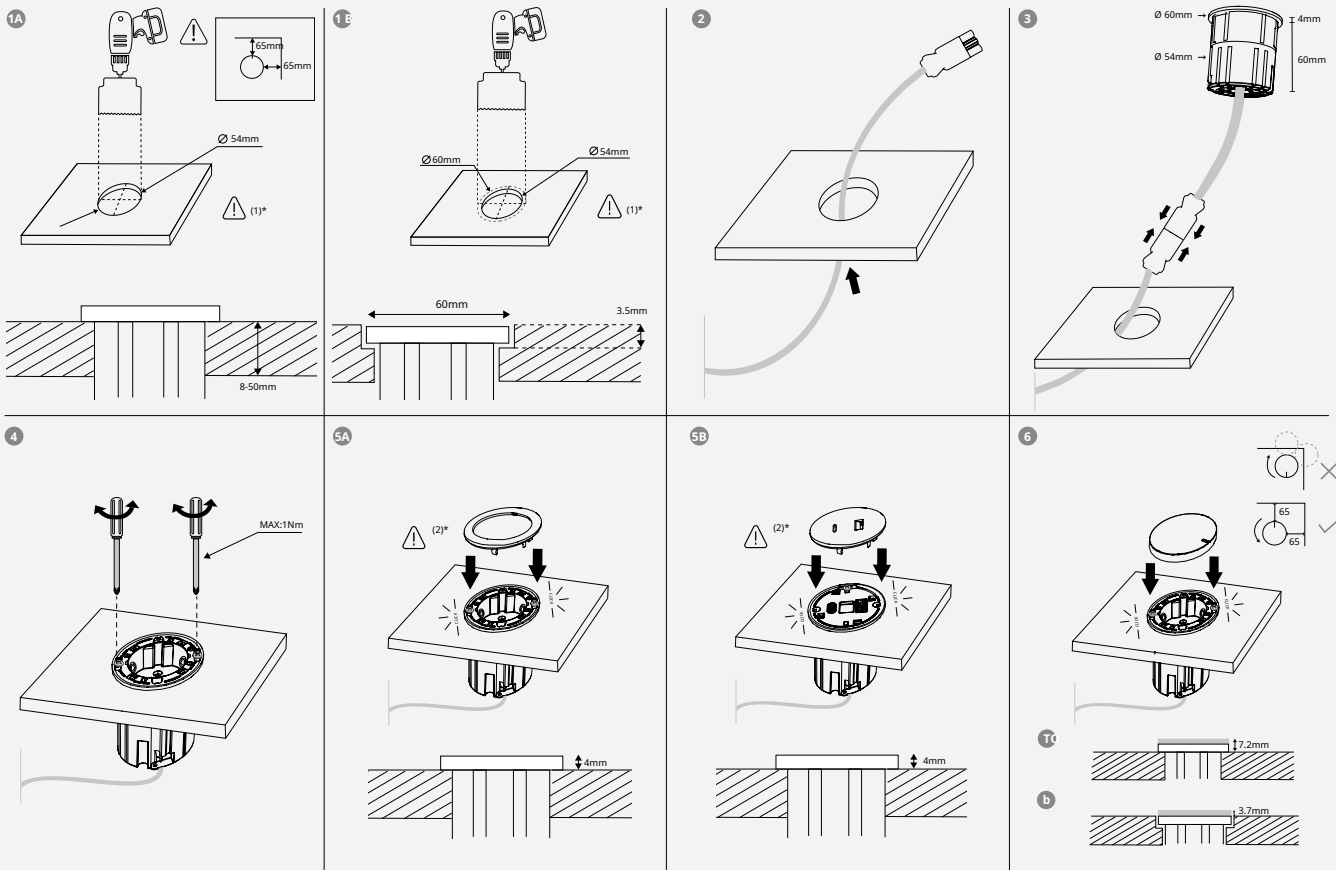

(1)\* Make sure that the cut hole for installing the product does not coincide with the pitch of the reinforcing bars of the table.  
 (2)\* Do not use the product without the trim ring correctly attached.



Panelable socket cover



230V  
30HZ

IP20

Facility:inside the table

1A 43100001-13X

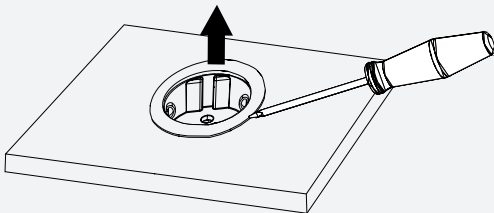

1B 43100002-13X

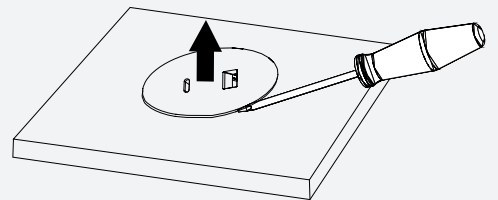

2A

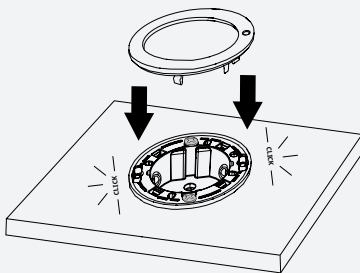

2B

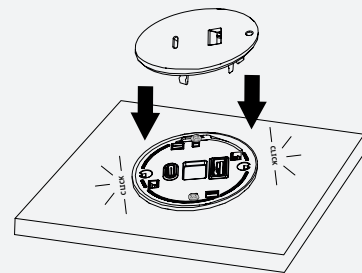

3A

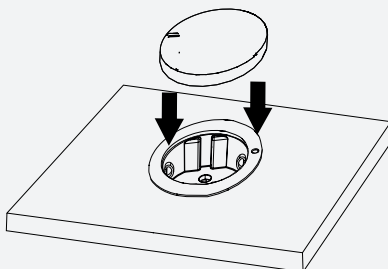

3B

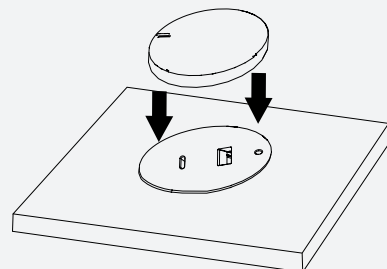



[www.simonelectric.com](http://www.simonelectric.com)



**SIMON, SAU**

Provincial Council, 390-392  
08013 Barcelona  
Tel. 651 761 336

**Customer Service  
Customer Technique**

Tel. 651 761 346 E-  
mail: [sat@simon.es](mailto:sat@simon.es)

**project department**

Tel. 651 761 346  
Email: [projects@simon.com](mailto:projects@simon.com)

**Customer Service**

Tel. 651 761 314

**Visit us in:**

**The House of Light**

Santa Cruz de Marcenado, 1  
28015 Madrid

**Appointment:**

[lacasadelaluz@simonelectric.com](mailto:lacasadelaluz@simonelectric.com)