

## PRODUCT DATASHEET

### PTi 150/220...240 I

POWERTRONIC® INTELLIGENT PTi I | ECG for HID lamps, with cable clamp



#### Areas of application

- Shop lighting
- Health and fitness areas (in luminaires with protection class IP66 or higher)
- Effect and accent lighting

#### Product benefits

- Extended terminal section enables mains looping
- Screw-down cable clamps for reliable strain relief
- Long reliable life at maximum permitted temperatures
- Automatic safety shutdown of lamps in the event of a defect or at end of life (EoL)

#### Product features

- Energy Efficiency Index EEI: A2
- Supply voltage: 220...240 V
- Line frequency: 50...60 Hz
- RI suppression: to EN 55015/CISPR 15
- Safety: to EN 61347-2-12
- Line harmonics according to EN 61000-3-2

– Immunity according to EN 61547

TECHNICAL DATA

Electrical data

Nominal wattage	160.00 W
Nominal voltage	220...240 V
Nominal output voltage	250 V
Input voltage AC	198...254 V
U-OUT (working voltage)	250 V
Type of current	AC
Inrush current	70 A <sup>1)</sup>
Mains frequency	50/60 Hz
Power factor $\lambda$	0.95 <sup>2)</sup>
ECG efficiency	92 %
Max. ECG no. on circuit breaker 10 A (B)	4 <sup>3)</sup>
Max. ECG no. on circuit breaker 16 A (B)	7 <sup>3)</sup>
Operating frequency	0.165 kHz

1)  $t_{width} = 250 \mu s$  (measured at 50 %  $i_{peak}$ )

2) Minimum

3) Type B

Dimensions & Weight

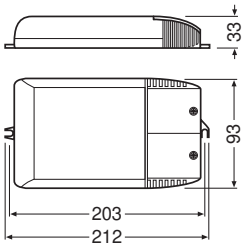

Length	212.00 mm
Mounting hole spacing, length	203,0 mm
Width	93.00 mm
Height	33.00 mm
Cable cross-section, input side	0,75...2,5 mm <sup>2</sup>
Cable cross-section, output side	0,75...2,5 mm <sup>2</sup>

Wire preparation length, input side	10...11 mm
Wire preparation length, output side	10...11 mm
Product weight	420.00 g

### Colors & materials

Casing material	Plastic
Body material	Plastic

### Temperatures & operating conditions

Ambient temperature range	-25...+50 °C
Maximum temperature at tc test point	75 °C
Max.housing temperature in case of fault	110 °C
Permitted rel. humidity during operation	5...85 % <sup>1)</sup>

<sup>1)</sup> Maximum 56 days/year at 85 %

### Lifespan

ECG lifetime	40000 h <sup>1)</sup>
--------------	-----------------------

<sup>1)</sup> At maximum T<sub>c</sub> / 10% failure rate

### Capabilities

Dimmable	No
Overheating protection	Power reduction and switch off at T > 75 °C at the tc point
Max. cable length to lamp/LED module	1,5 m
Suitable for fixtures with prot. class	I
Suitable for emergency lighting	No

### Certificates & Standards

Approval marks – approval	ENEC 10 / VDE / VDE-EMC / EAC / C-Tick
Standards	Acc. to EN 61347-2-12 / Acc. to EN 55015 / Acc. to EN 61000-3-2 / Acc. to EN 61547 / Acc. to EN 62493
Protection class	I
Type of protection	IP20
Energy efficiency class	A2
EEL – Energy Label	A2

### LOGISTICAL DATA

Temperature range at storage	-40...+85 °C
------------------------------	--------------





Safety advice

Ballast losses and lamp heat radiation can lead to heat accumulation in a completely closed case. Therefore it is necessary to ensure that the temperature at the measuring point t of the ECG does not exceed the maximum value.

Attention!

For safety reasons disconnect the device before replacing the lamp!

DOWNLOAD DATA

Documents and certificates	
	User instruction
	Declarations Of Conformity CE
	Certificates
CAD/BIM files	
	CAD data 3D PDF

LOGISTICAL DATA

Product code	Packaging unit (Pieces/Unit)	Dimensions (length x width x height)	Gross weight	Volume
4008321915535	Unpacked 1	205 mm x 91 mm x 33 mm	420.00 g	0.62 dm³
4008321915542	Shipping box 20	488 mm x 100 mm x 453 mm	9440.00 g	22.11 dm³

The mentioned product code describes the smallest quantity unit which can be ordered. One shipping unit can contain one or more single products. When placing an order, for the quantity please enter single or multiples of a shipping unit.

DISCLAIMER

Subject to change without notice. Errors and omission excepted. Always make sure to use the most recent release.