

# GOODWE

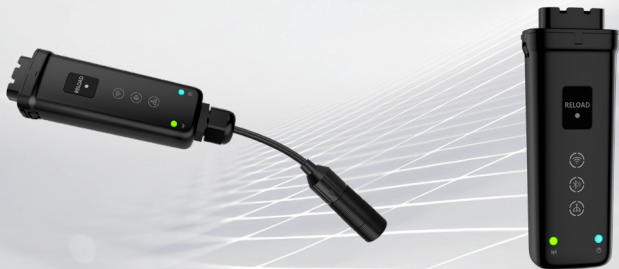

## Quick Installation Guide

### Smart Dongle

(Ezlink3000)

V1.2-2024-01-05

## 01 Applications

### Single Inverter

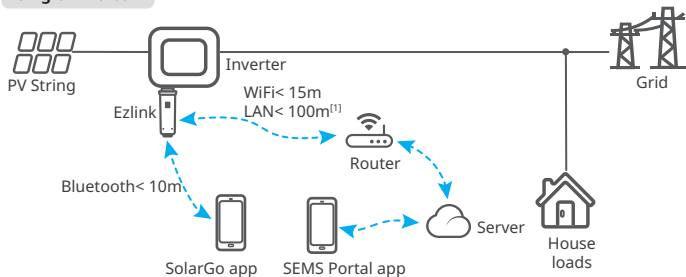

### Multiple Inverters

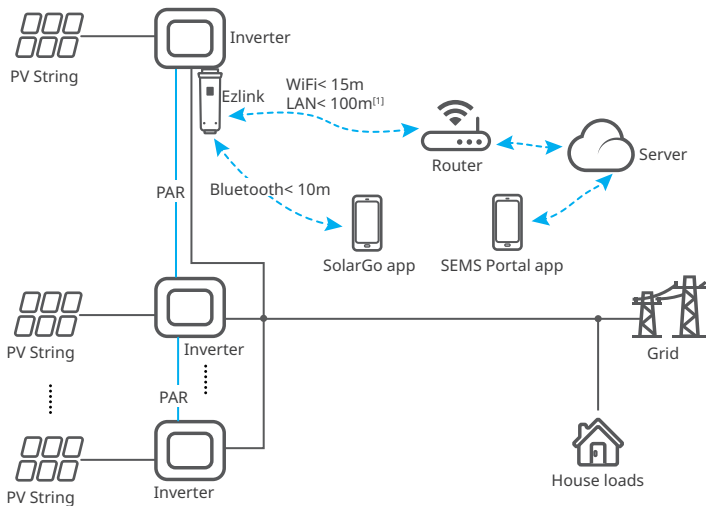

[1] LAN: Optional.

— Power cable — Signal cable

## 02 Installation

### Packing List



Ezlink \*1



Unlock tool \*1



User manual \*1



(optional)  
Waterproof gland  
& network cable \*1

### Installing the Dongle

① ② ③ ④ : Optional. Only for LAN function.

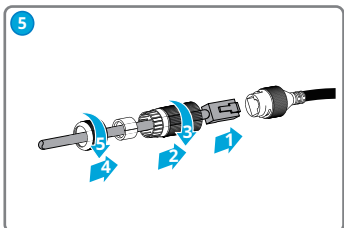
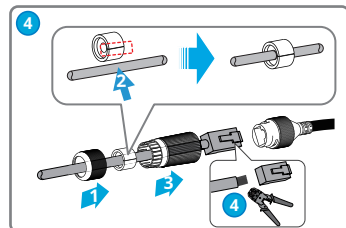
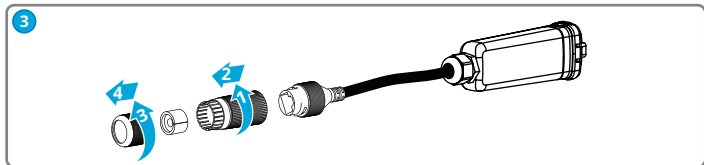
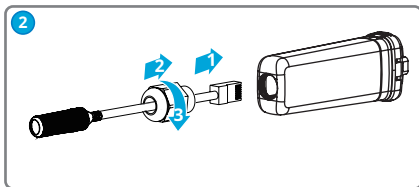
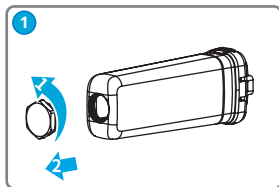

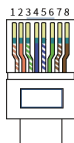
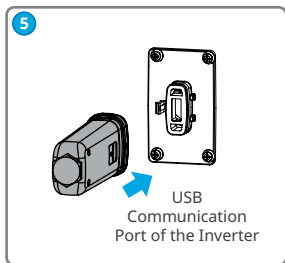
**RJ45 Connector:**

- 1.White & Orange
- 2.Orange
- 3.White & Green
- 4.Blue
- 5.White & Blue
- 6.Green
- 7.White & Brown
- 8.Brown



**03 Power On**

**Step 1** Power on the inverter.

**Step 2** Power on the router.

**Step 3** Check communication status of the Ezlink through indicators.

**Note:** Check the indicators on the Ezlink and the inverter to confirm the communication status of the device.

Indicator/Silkscreen	Color	Status	Description
	Blue	Blink	The Ezlink is working properly.
		OFF	The Ezlink is powered off.
	Green	ON	The Ezlink is connected to the server.
		Blink 2	The Ezlink is not connected to the router.
		Blink 4	The Ezlink is connected to the router, but not connected to the server.
RELOAD	-	-	Short press for 3s to restart the Ezlink. Long press for 3-10s to restore factory settings.

**04 Commissioning via SolarGo App**

**Step 1** Download and install SolarGo app.

The UI may be different due to the app version upgrade. Scan the QR code for latest SolarGo app user manual.



SolarGo App



SolarGo User Manual

**Step 2** Connect the app and the device.

**(Optional)** When multiple inverters are parallel connected, refer to the user manual of the inverter for more system commission details.

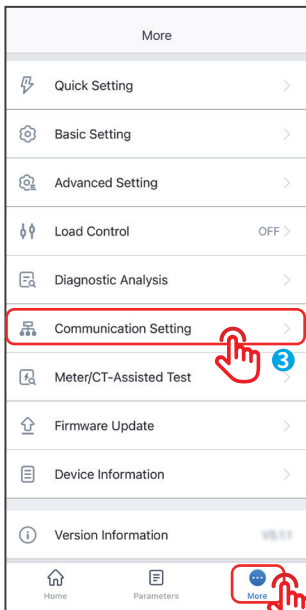
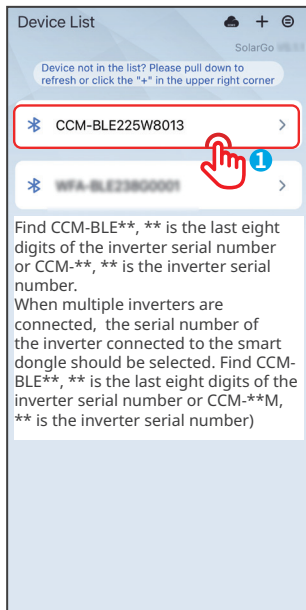

**Step 3** Set communication settings of the device.

- The interface may differ depending on the communication method.
- Make sure that the WiFi RSSI value is higher than -60, it would be better if it is -50 or higher. When the RSSI value is less than -60, you should move the router closer to the device, remove the obstacle, or add a repeater to improve the signal strength.

Network setting Save

4 Wi-Fi

Network Name  
TP-LINK\_Network

Encryption  
WPA2/WPA

Password

DHCP   
If you want to set a specific IP address for the device, please enter it manually after turning off DHCP

IP Address 172.18.0.158

Subnet Mask 255.255.255.0

Gateway Address 172.18.0.1

DNS Server 172.18.0.1

LAN

DHCP   
If you want to set a specific IP address for the device, please enter it manually after turning off DHCP

IP Address 0.0.0.0

Subnet Mask 0.0.0.0

Gateway Address 0.0.0.0

DNS Server 172.18.0.1

[Restore factory communication settings](#)

Network Name  
TP-LINK\_Network

Encryption  
WPA2/WPA

Password

DHCP   
If you want to set a specific IP address for the device, please enter it manually after turning off DHCP

IP Address 172.18.0.158  
NO YES

TP-LINK\_Network -14  
goodwe-2f -55  
ESP\_402938 -88

No.	Name	Description
1	WiFi Network	Select WiFi based on the actual requirement.
2	Password	WiFi password for the actual selected network.

3	DHCP	<ul style="list-style-type: none"> <li>• Enable DHCP when the router is in dynamic IP mode.</li> <li>• Disable DHCP when the router is in static IP mode.</li> </ul>
4	IP Address	<ul style="list-style-type: none"> <li>• Do not configure the parameters when DHCP is enabled.</li> <li>• Configure the parameters according to the router information when DHCP is disabled.</li> </ul>
5	Subnet Mask	
6	Gateway Address	
7	DNS Server	

## 05 Device Replacement

**Step 1** Prepare a new device before replacing the old Ezlink.

**Step 2** Remove the Ezlink using the Unlock Tool.

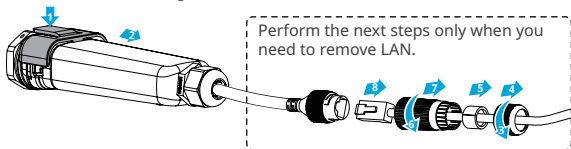

**Step 3** Refer to the Quick Installation Guide to install and configure the new device.

## 06 Troubleshooting

No.	Problem	Solutions
1	Cannot find CCM-BLE** or CCM-**	<ol style="list-style-type: none"> <li>1. Make sure that no other smart device is connected to CCM-BLE** or CCM-**.</li> <li>2. Make sure that the SolarGo app is the latest version.</li> </ol>
2	Unable to connect to CCM-BLE** or CCM-**	<ol style="list-style-type: none"> <li>1. Make sure that no other smart device is connected to CCM-BLE** or CCM-**.</li> <li>2. Restart the inverter or short press to restart the Ezlink, then reconnect CCM-BLE** or CCM-**.</li> </ol>
3	Indicator double blink	<ol style="list-style-type: none"> <li>1. Make sure that the router is powered on.</li> <li>2. When communicating via LAN, make sure that both LAN cable connection and LAN configuration are proper. Enable or disable DHCP based on actual needs.</li> <li>3. When communicating via WiFi, make sure that the wireless network connection is ok and the wireless signal strength meets the requirements. Enable or disable DHCP based on actual needs.</li> </ol>
4	Indicator quadruple blink	<ol style="list-style-type: none"> <li>1. Make sure that the Ezlink is connected to the router via WiFi or LAN properly, and the router can access the internet.</li> <li>2. If the problem persists, contact the after sales service.</li> </ol>
5	Indicator off	Check whether the inverter is powered on.

## 07 Technical Data

	Model	Ezlink3000
General Parameters	Connection Interface	USB
	Ethernet Interface (Optional)	10/100Mbps self-adaption, Communication distance $\leq 100\text{m}$
	Bluetooth	Bluetooth 5.1
	Installation	Plug-and-play
	Indicator	LED Indicator
	Dimensions (W × H × D mm)	153 × 49 × 32
	Weight (g)	130
	Ingress Protection Rating	IP65
	Power Consumption (W)	$\leq 2$
	Operation Mode	STA
Wireless Parameters	WiFi Communication	802.11 b/g/n(2.412GHz-2.484GHz)
Environment Parameters	Operating Temperature Range (°C)	-30 ~ +60
	Storage Temperature Range (°C)	-30 ~ +70
	Relative Humidity (non-condensing)	0-100%
	Max. Operating Altitude (m)	4000

## 08 EU Declaration of Conformity

GoodWe Technologies Co., Ltd. hereby declares that the communication device sold in the European market meets the requirements of the following directives:

- Radio Equipment Directive 2014/53/EU (RED)
- Restrictions of Hazardous Substances Directive 2011/65/EU and (EU) 2015/863 (RoHS)
- Waste Electrical and Electronic Equipment 2012/19/EU
- Registration, Evaluation, Authorization and Restriction of Chemicals (EC) No 1907/2006 (REACH)

You can download the EU Declaration of Conformity on <https://en.goodwe.com>.

For more information, scan the QR codes below.



SolarGo App



SolarGo User Manual



SEMS Portal App



SEMS Portal app User Manual





Website

## **GoodWe Technologies Co., Ltd.**

 No. 90 Zijin Rd., New District, Suzhou, 215011, China

 [www.goodwe.com](http://www.goodwe.com)

 [service@goodwe.com](mailto:service@goodwe.com)



340-00647-01



Local Contacts