

28 002 978 Product version from 4/1/2025



- spray head Ø 95mm
- Three settings: COMPACT RAIN, COMPACT SOFT FLOW, COMPACT AQUAPRESSURE FLOW, max. flow rate 9 l/min (at 3 bar)
- Function from: 6.8 l/min
- 1/2" connection
- inherently safe from back flow
- with anti-scale system

Notes:

	Brushed Durabronze (23kt Gold)	28 002 978-28
	Chrome	28 002 978-00
	Brushed Platinum	28 002 978-06
	Platinum	28 002 978-08
	Durabronze (23kt Gold)	28 002 978-09
	Brushed Gold (PVD)	28 002 978-37
	Brushed Dark Brass (PVD)	28 002 978-39
	Brushed Bronze (PVD)	28 002 978-42
	Brushed Dark Platinum	28 002 978-99

28 002 978 Product version from 4/1/2025

mm [inches]

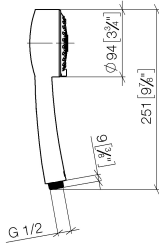

Flow rate chart

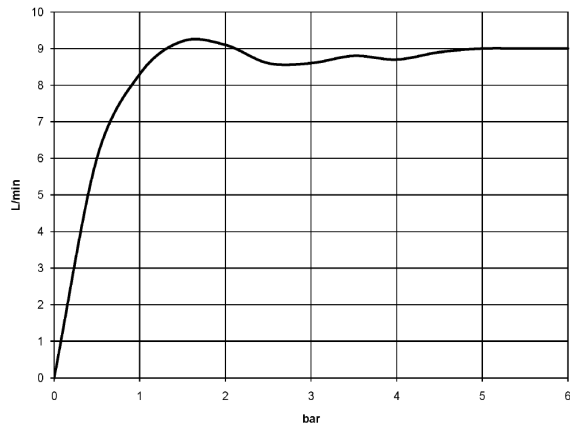

Codes & Standards

DIN 4109

ISO 3822

Ü-Zeichen



MADISON Hand shower 95 mm - Brushed Durabronz (23kt Gold)

MADISON

28 002 978 Product version from 4/1/2025

Certificates and sustainability

LGA_18

28 002 978 Product version from 4/1/2025

Parts for other finishes can be found here: [Chrome](#)

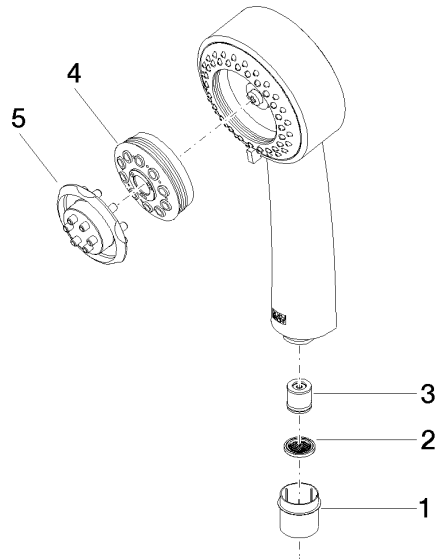

Spare parts list

No.	Item Number	Name	Quantity used	Delivery time
5	09 30 09 022 90	Spanner -	1.00	14
3	09 23 01 077 90	Back-flow preventer 8,7 l/min. -	1.00	14
1	09 21 02 115 90	Protective cap Protective cap for hand shower Ø 26 x 25 mm -	1.00	14
4	04 12 11 071 00 90	Regulating insert Hand shower adjuster 31 x 191 x 50 mm -	1.00	14
2	09 23 01 039 90	Sieve seal Ø 19 x 5,5 mm -	1.00	14