

Walraven Heavy Duty Clamp HD500 (M10/12) (BUP1000)

(B1005)

for steel pipes

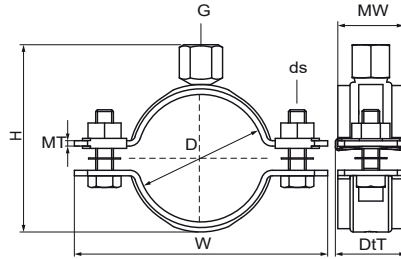

Features & benefits

- two-part clamp with two locking bolts
- heavy design
- bolts secured with anti-loss washer
- with CO₂ welded connection nut
- material: steel
- surface protection:
- product is part of the Walraven BIS UltraProtect® 1000 system
- suitable for in- and outdoor applications
- stands min. 1,000 hours salt spray test (max. 5% red rust) according to ISO 9227
- also available: noise insulating lining of silicone rubber (reddish brown), heat resistant up to +200 °C (A 35 15)
- tested for fire safety



| Product Number | Outside Pipe Diameter | DN | Pipe Diameter Imperial | Connection Thread | Total Height | Total Width | Total Depth | Material Width | Material Thickness | Screw Size | Maximum Allowed Load Faz | Approvals |
|------------------|-----------------------|--------|------------------------|-------------------|--------------|-------------|-------------|----------------|--------------------|------------|--------------------------|--|
| Reference Letter | D | D | D | G | H | W | DtT | MW | MT | ds | Fa,z | |
| Unit description | mm | | " | | mm | mm | mm | mm | mm | | N | |
| 33048078 | 72 - 78 | DN 65 | 2½ | M10/M12 | 115 | 137 | 32 | 30 | 3.00 | M8 | 4,000 | CE, ETA, RAL-GZ 655/B, RAL-GZ 656, VdS, ITB (KOT), FM, EPD |
| 33048085 | 79 - 85 | | | M10/M12 | 122 | 144 | 32 | 30 | 3.00 | M8 | 4,000 | CE, ETA, RAL-GZ 655/B, RAL-GZ 656, VdS, ITB (KOT), EPD |
| 33048092 | 86 - 92 | DN 80 | 3 | M10/M12 | 129 | 151 | 32 | 30 | 3.00 | M8 | 4,000 | CE, ETA, RAL-GZ 655/B, RAL-GZ 656, VdS, ITB (KOT), FM, EPD |
| 33048106 | 98 - 106 | | | M10/M12 | 143 | 165 | 32 | 30 | 3.00 | M8 | 4,000 | CE, ETA, RAL-GZ 655/B, RAL-GZ 656, VdS, ITB (KOT), EPD |
| 33048116 | 108 - 116 | DN 100 | 4 | M10/M12 | 153 | 175 | 32 | 30 | 3.00 | M8 | 4,000 | CE, ETA, RAL-GZ 655/B, RAL-GZ 656, VdS, ITB (KOT), EPD |
| 33048123 | 116 - 123 | | | M10/M12 | 160 | 182 | 32 | 30 | 3.00 | M8 | 4,000 | CE, ETA, RAL-GZ 655/B, RAL-GZ 656, ITB (KOT), EPD |
| 33048133 | 125 - 133 | | | M10/M12 | 170 | 192 | 32 | 30 | 3.00 | M8 | 4,000 | CE, ETA, RAL-GZ 655/B, RAL-GZ 656, ITB (KOT), EPD |
| 33048140 | 132 - 140 | DN 125 | 5 | M10/M12 | 177 | 199 | 32 | 30 | 3.00 | M8 | 4,000 | CE, ETA, RAL-GZ 655/B, RAL-GZ 656, VdS, ITB (KOT), EPD |
| 33048154 | 148 - 154 | | | M10/M12 | 191 | 213 | 32 | 30 | 3.00 | M8 | 4,000 | CE, ETA, RAL-GZ 655/B, ITB (KOT), EPD |
| 33048169 | 159 - 169 | DN 150 | 6 | M10/M12 | 206 | 240 | 38 | 38 | 4.00 | M10 | 8,200 | CE, ETA, VdS, ITB (KOT), EPD, RAL-GZ 655/B |
| 33048183 | 173 - 183 | | | M10/M12 | 220 | 255 | 38 | 38 | 4.00 | M10 | 8,200 | CE, ETA, ITB (KOT), EPD, RAL-GZ 655/B |
| 33048202 | 192 - 202 | | | M10/M12 | 239 | 274 | 38 | 38 | 4.00 | M10 | 8,200 | CE, ETA, ITB (KOT), EPD, RAL-GZ 655/B |
| 33048219 | 208 - 219 | | | M10/M12 | 256 | 291 | 38 | 38 | 4.00 | M10 | 8,200 | CE, ETA, ITB (KOT), EPD, RAL-GZ 655/B |
| 33048227 | 217 - 227 | DN 200 | 8 | M10/M12 | 264 | 299 | 38 | 38 | 4.00 | M10 | 8,200 | CE, ETA, ITB (KOT), EPD, RAL-GZ 655/B |