

## Walraven Heavy Duty Clamp HD500 (M10/12) (BUP1000)

(B1005)

for steel pipes

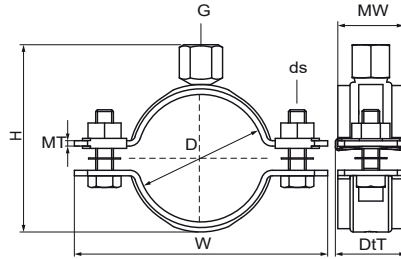

### Features & benefits

- two-part clamp with two locking bolts
- heavy design
- bolts secured with anti-loss washer
- with CO<sub>2</sub> welded connection nut
- material: steel
- surface protection:
- product is part of the Walraven BIS UltraProtect® 1000 system
- suitable for in- and outdoor applications
- stands min. 1,000 hours salt spray test (max. 5% red rust) according to ISO 9227
- also available: noise insulating lining of silicone rubber (reddish brown), heat resistant up to +200 °C (A 35 15)
- tested for fire safety



Product Number	VVS Number	Outside Pipe Diameter	DN	Pipe Diameter Imperial	Connection Thread	Total Height	Total Width	Total Depth	Material Width	Material Thickness	Screw Size	Maximum Allowed Load Faz	Approvals
Reference Letter		D	D	D	G	H	W	DtT	MW	MT	ds	Fo,z	
Unit description		mm		"		mm	mm	mm	mm	mm		N	
33048078	18024163	72 - 78	DN 65	2 1/2	M10/M12	115	137	32	30	3.00	M8	4,000	CE, ETA, RAL-GZ 655/B, RAL-GZ 656, VdS, ITB (KOT), FM, EPD
33048085	18024165	79 - 85			M10/M12	122	144	32	30	3.00	M8	4,000	CE, ETA, RAL-GZ 655/B, RAL-GZ 656, VdS, ITB (KOT), EPD
33048092	18024167	86 - 92	DN 80	3	M10/M12	129	151	32	30	3.00	M8	4,000	CE, ETA, RAL-GZ 655/B, RAL-GZ 656, VdS, ITB (KOT), FM, EPD
33048106	18024172	98 - 106			M10/M12	143	165	32	30	3.00	M8	4,000	CE, ETA, RAL-GZ 655/B, RAL-GZ 656, VdS, ITB (KOT), EPD
33048116	18024175	108 - 116	DN 100	4	M10/M12	153	175	32	30	3.00	M8	4,000	CE, ETA, RAL-GZ 655/B, RAL-GZ 656, VdS, ITB (KOT), EPD
33048123		116 - 123			M10/M12	160	182	32	30	3.00	M8	4,000	CE, ETA, RAL-GZ 655/B, RAL-GZ 656, ITB (KOT), EPD
33048133	18024178	125 - 133			M10/M12	170	192	32	30	3.00	M8	4,000	CE, ETA, RAL-GZ 655/B, RAL-GZ 656, ITB (KOT), EPD
33048140	18024179	132 - 140	DN 125	5	M10/M12	177	199	32	30	3.00	M8	4,000	CE, ETA, RAL-GZ 655/B, RAL-GZ 656, VdS, ITB (KOT), EPD
33048154	18024181	148 - 154			M10/M12	191	213	32	30	3.00	M8	4,000	CE, ETA, RAL-GZ 655/B, ITB (KOT), EPD
33048169	18024183	159 - 169	DN 150	6	M10/M12	206	240	38	38	4.00	M10	8,200	CE, ETA, VdS, ITB (KOT), EPD, RAL-GZ 655/B
33048183	18024184	173 - 183			M10/M12	220	255	38	38	4.00	M10	8,200	CE, ETA, ITB (KOT), EPD, RAL-GZ 655/B
33048202	18024185	192 - 202			M10/M12	239	274	38	38	4.00	M10	8,200	CE, ETA, ITB (KOT), EPD, RAL-GZ 655/B
33048219	18024186	208 - 219			M10/M12	256	291	38	38	4.00	M10	8,200	CE, ETA, ITB (KOT), EPD, RAL-GZ 655/B
33048227	18024187	217 - 227	DN 200	8	M10/M12	264	299	38	38	4.00	M10	8,200	CE, ETA, ITB (KOT), EPD, RAL-GZ 655/B