



# HANSA

Installation and maintenance guide





4-13



14-22



23

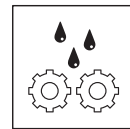

24-31



32



HANSA Connect App



[hansa.com/hansa-app](https://hansa.com/hansa-app)

Apple and the Apple logo are trademarks of Apple Inc., registered in the U.S. and other countries. App Store is a service mark of Apple Inc., registered in the U.S. and other countries.

Google Play and the Google Play logo are trademarks of Google Inc.

The Bluetooth® word mark and logos are registered trademarks owned by the Bluetooth SIG, Inc. and any use of such marks by Hansa Armaturen GmbH is under license. Other trademarks and trade names are those of their respective owners.



**Lithium 2CR5 6 V**  
 I (ISO 3822)  
 EN 15091  
 100 - 1000 kPa

max. +70°C  
 IP 55

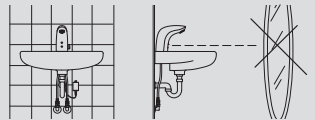
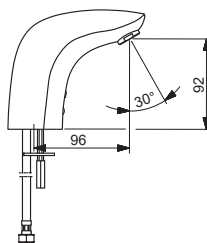
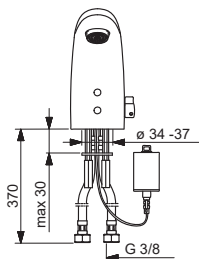
**6441 2219** [mpi.hansa.com/64412219](https://mpi.hansa.com/64412219)

**0615 2219**   
**0615 2219 33**   
**6416 2219**

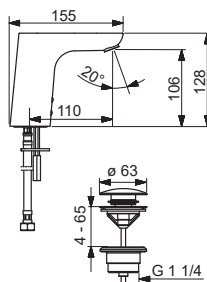
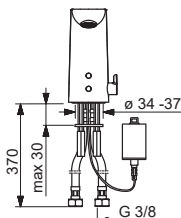
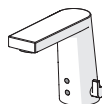
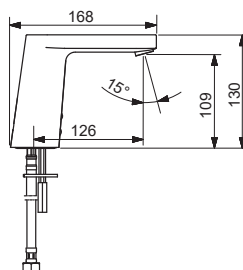
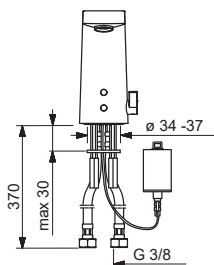
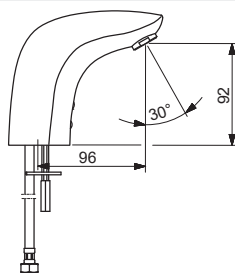
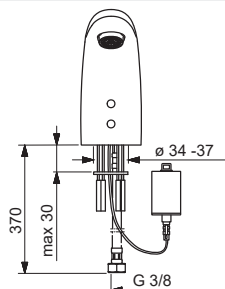
[mpi.hansa.com/06152219](https://mpi.hansa.com/06152219)**5716 2219** [mpi.hansa.com/57162219](https://mpi.hansa.com/57162219)**6440 2219** [mpi.hansa.com/64402219](https://mpi.hansa.com/64402219)





**Lithium 2CR5 6 V**  
 I (ISO 3822)  
 EN 15091  
 100 - 1000 kPa

max. +70°C  
 IP 55

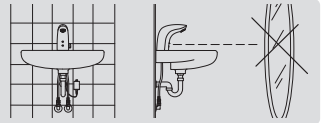

**6443 2219** ❄️

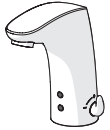
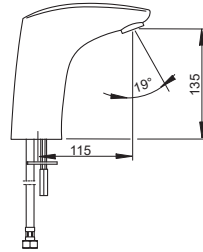
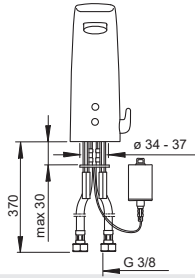

[mpi.hansa.com/64432219](https://mpi.hansa.com/64432219)

**6541 2219** ❄️ 0.08 l/s

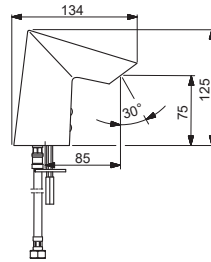
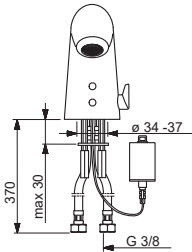

[mpi.hansa.com/65412219](https://mpi.hansa.com/65412219)

**6491 2219** ❄️

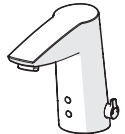
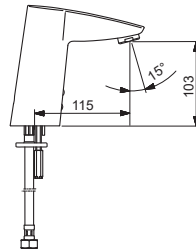
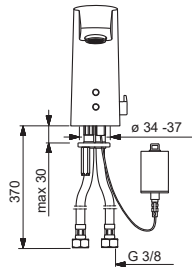

[mpi.hansa.com/64912219](https://mpi.hansa.com/64912219)



**Lithium 2CR5 6 V**  
 I (ISO 3822)  
 EN 15091  
 100 - 1000 kPa

max. +70°C  
 IP 55

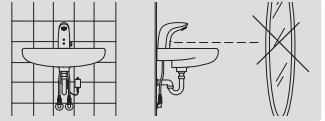

**5716 2279**

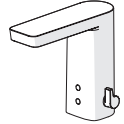
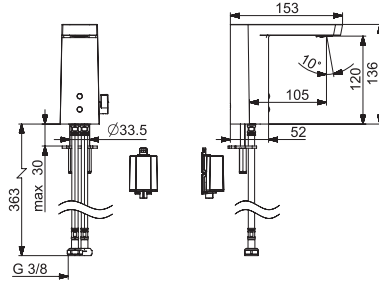

[mpi.hansa.com/57162279](https://mpi.hansa.com/57162279)

**6444 2229**

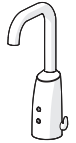
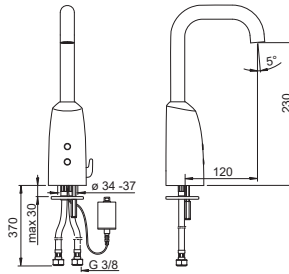

[mpi.hansa.com/64442229](https://mpi.hansa.com/64442229)

**6444 2219**

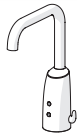
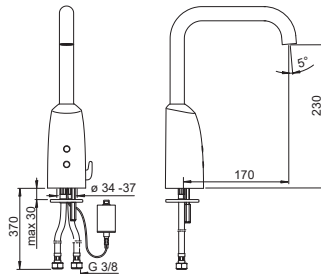

[mpi.hansa.com/64442219](https://mpi.hansa.com/64442219)

**5749 2219**

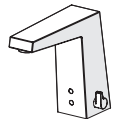
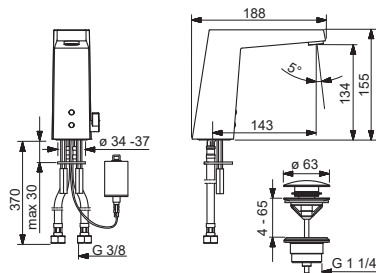

[mpi.hansa.com/57492219](https://mpi.hansa.com/57492219)



**Lithium 2CR5 6 V**  
 I (ISO 3822)  
 EN 15091  
 100 - 1000 kPa

max. +70°C  
 IP 55

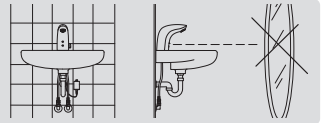

**5193 2201**

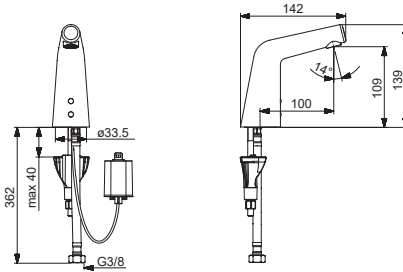

[mpi.hansa.com/57162279](http://mpi.hansa.com/57162279)

**5179 2201**

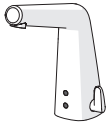
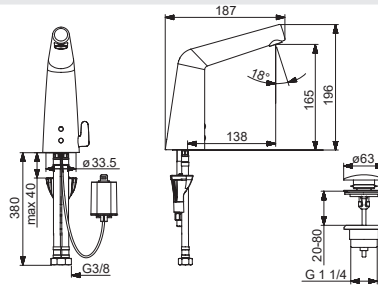

[mpi.hansa.com/64442229](http://mpi.hansa.com/64442229)

**5194 2201**

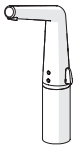
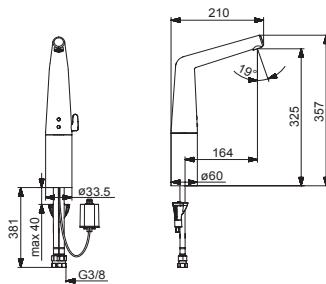

[mpi.hansa.com/64442219](http://mpi.hansa.com/64442219)



**9 / 12 V**  
I (ISO 3822)  
EN 15091  
100 - 1000 kPa

max. +70°C  
IP 55

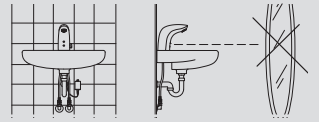

**5712 2209** ❄️

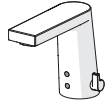
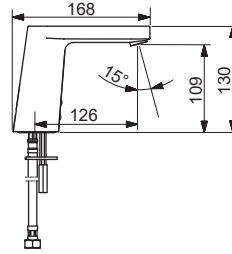
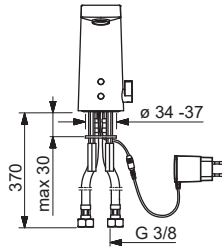

[mpi.hansa.com/57122209](http://mpi.hansa.com/57122209)

**6443 2009** ❄️

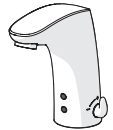
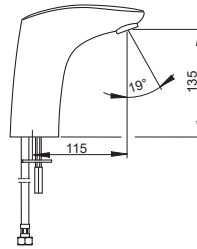
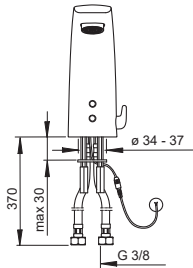

[mpi.hansa.com/64432009](http://mpi.hansa.com/64432009)

**6442 1109** ❄️ 100 - 500 kPa

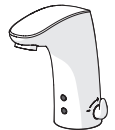
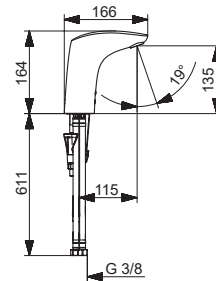
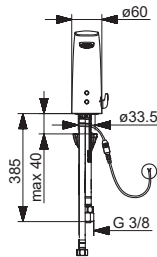

[mpi.hansa.com/64421109](http://mpi.hansa.com/64421109)

**6541 2079** ❄️

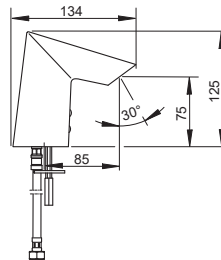
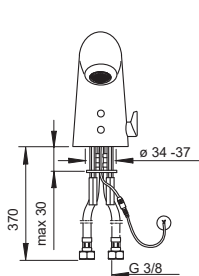

[mpi.hansa.com/65412079](http://mpi.hansa.com/65412079)



**9 / 12 V**  
 I (ISO 3822)  
 EN 15091  
 100 - 1000 kPa

max. +70°C  
 IP 55

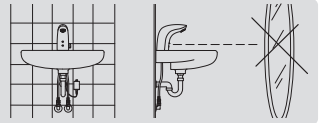

**5193 2211** \*

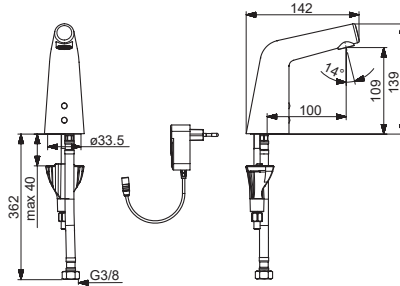

[mpi.hansa.com/51932211](https://mpi.hansa.com/51932211)

**5179 2221** \*

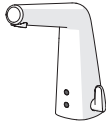
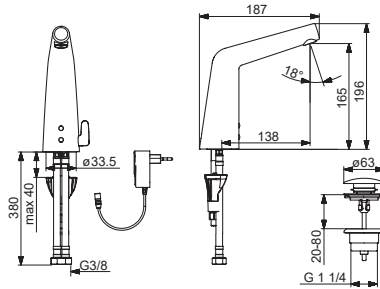

[mpi.hansa.com/51792221](https://mpi.hansa.com/51792221)

**5194 2211** \*

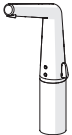
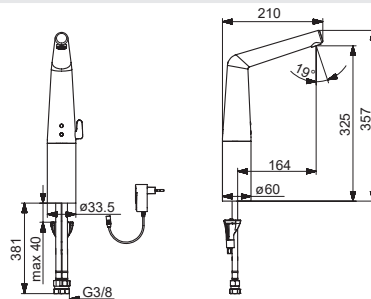

[mpi.hansa.com/51942211](https://mpi.hansa.com/51942211)



**230 / 9 V**  
I (ISO 3822)  
EN 15091  
100 - 1000 kPa

max. +70°C  
IP 55 / transformer IP 20

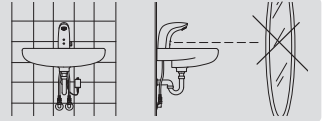

**6541 2009**

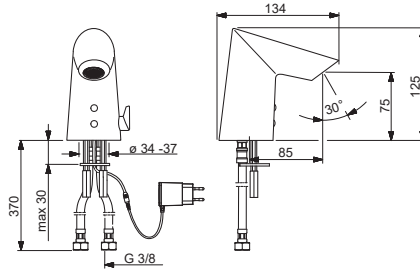

[mpi.hansa.com/65412009](http://mpi.hansa.com/65412009)

**6491 2019**

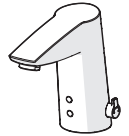
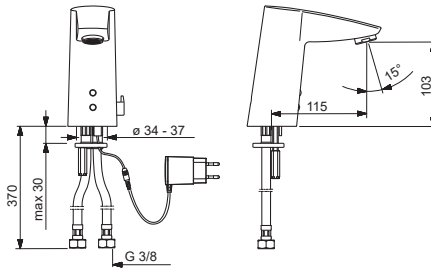

[mpi.hansa.com/64912019](http://mpi.hansa.com/64912019)

**6441 2009**

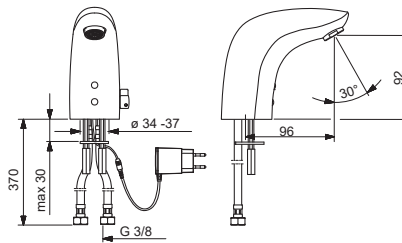

[mpi.hansa.com/64412009](http://mpi.hansa.com/64412009)

**5712 2279**

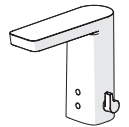
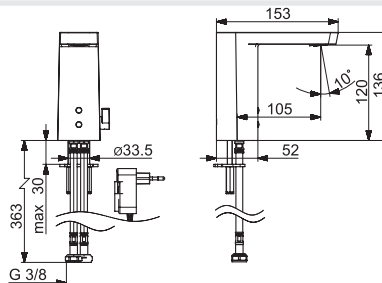

[mpi.hansa.com/57122279](http://mpi.hansa.com/57122279)



**230 / 9 V**  
 I (ISO 3822)  
 EN 15091  
 100 - 1000 kPa

max. +70°C  
 IP 55 / transformer IP 20

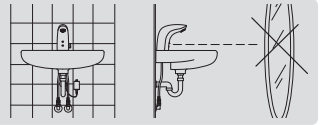

**6443 2029** ❄️

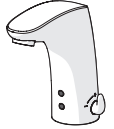
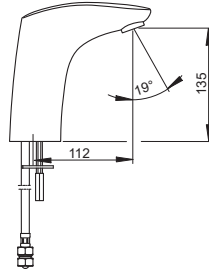
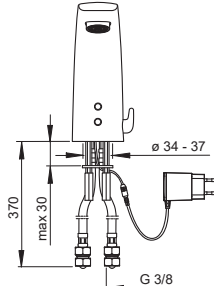

[mpi.hansa.com/64432029](https://mpi.hansa.com/64432029)

**6442 1129** ❄️

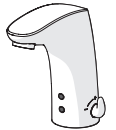
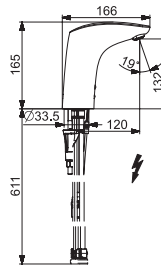
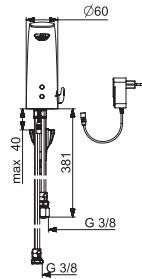

[mpi.hansa.com/64421129](https://mpi.hansa.com/64421129)

**0614 2209** ❄️

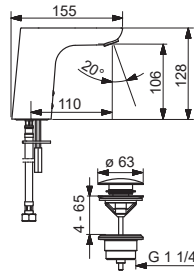
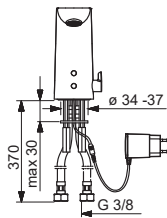

[mpi.hansa.com/06142209](https://mpi.hansa.com/06142209)

**5748 2209** ❄️

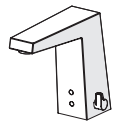
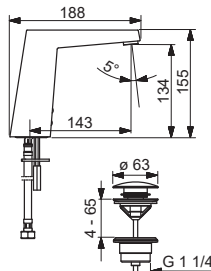
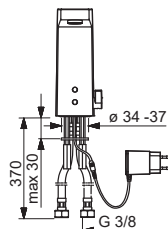

[mpi.hansa.com/57482209](https://mpi.hansa.com/57482209)



**230 / 12 V**  
I (ISO 3822)  
EN 15091  
100 - 1000 kPa

max. +70°C  
IP 55

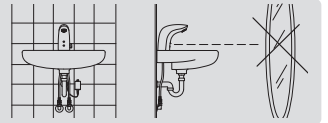

**6443 2019**

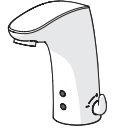
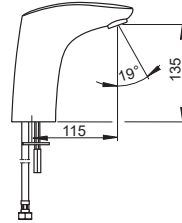
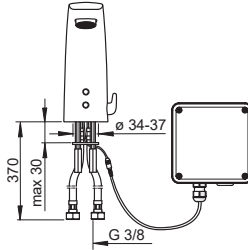

[mpi.hansa.com/64432019](https://mpi.hansa.com/64432019)

**6442 1119**

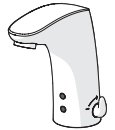
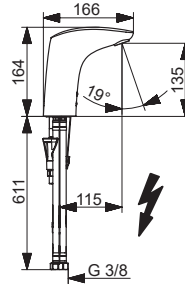
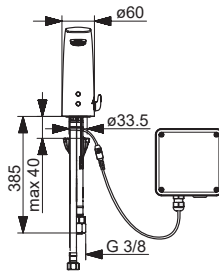

[mpi.hansa.com/64421119](https://mpi.hansa.com/64421119)





- GB** Power supply requirement: Power supply output must be short circuit protected
- CZ** Požadavky týkající se napájecího zdroje: Výstup napájecího zdroje musí být chráněn proti zkratu
- DE** Stromversorgungs-voraussetzungen: Stromversorgungsspannung muss kurzschlussgeschützt sein.
- DK** Krav til strømforsyning: Strømforsyningsudgang skal være kortslutningsbeskyttet
- EE** Nõuded vooluallikale: Vooluallika väljund peab olema kaitstud lühise eest
- ES** Requisitos del suministro eléctrico: el suministro eléctrico debe estar protegido contra cortocircuitos
- FI** Vaatimukset virtälähteelle: Virtälähteen ulostulon tulee olla oikosulkusuojattu
- FR** Unité d'alimentation électrique: La sortie de l'unité d'alimentation oit être protégée contre le court-circuit
- IT** Requisiti dell'alimentazione: L'uscita deve essere protetta da cortocircuiti
- LT** Reikalavimai maitinimo šaltiniui: turi būti apsauga nuo trumpo jungimo
- NL** Prasības attiecībā uz barošanas ierīci: ierīces izvadām jābūt aizsargātām pret īsslēgumiem
- NO** Vereisten voor de voeding: De uitgang van de voeding moet beschermd zijn tegen kortsluitingen
- NO** Krav til strømforsyning: Strømforsyningsspenning må være kortslutningssikret
- PL** Wymagania w stosunku do zasilacza: Zasilacz musi być wyposażony w zabezpieczenie przeciwzwarciowe
- RO** Pentru alimentarea cu putere: borna de putere trebuie să fie protejată la scurtcircuit
- RU** Требования к источнику тока: Выход источника тока защищен от короткого замыкания
- SE** Krav på matningsdön: Utspänningen skall vara kortslutningssäker
- SK** Požiadavka na napájanie: Výstup napájania musí byť chránený voči skratu.
- UA** Вимоги до джерела струму: Вихід джерела струму захищений від короткого замикання.
- PT** Requisitos de alimentação eléctrica: a alimentação eléctrica deve estar protegida contra curto-circuito.
- GR** Προϋποθέσεις για αδιάλειπτη παροχή ρεύματος: Τάση εξόδου ασφαλισμένη έναντι βραχυκυκλώματος
- SI** Zahteva za napajanje: Izhod za napajanje mora biti zaščiten s kratkim stikom
- HU** Áramellátás: A tápegység kimeneténél fontos az érintésvédelmet biztosítani.

## Hansa 6499 0100

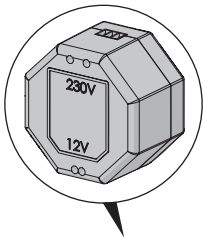
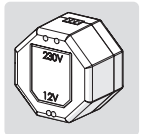

Oras 199275

1.....5

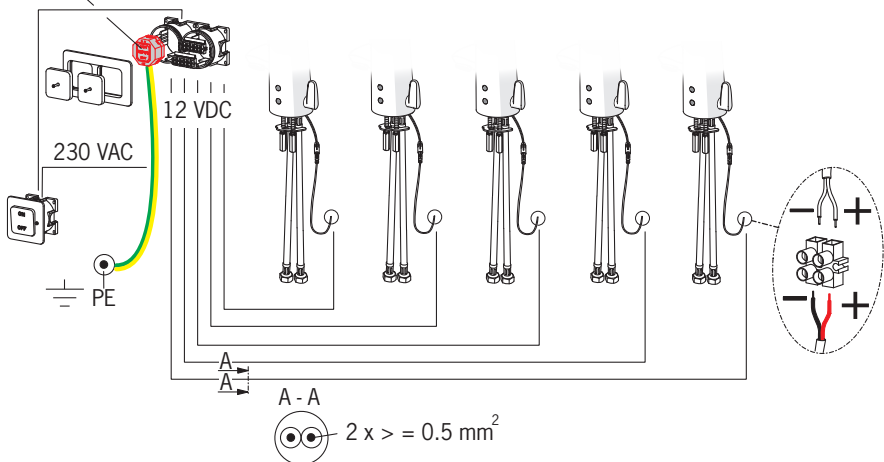

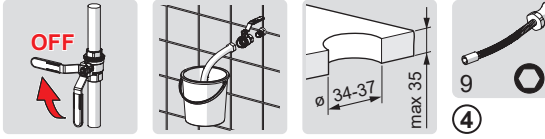

**1 A**

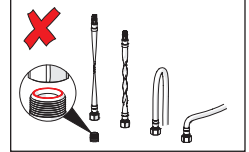
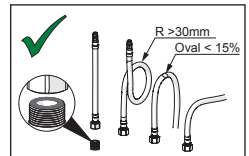
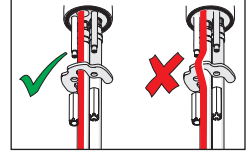
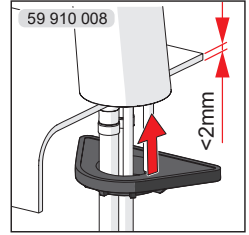
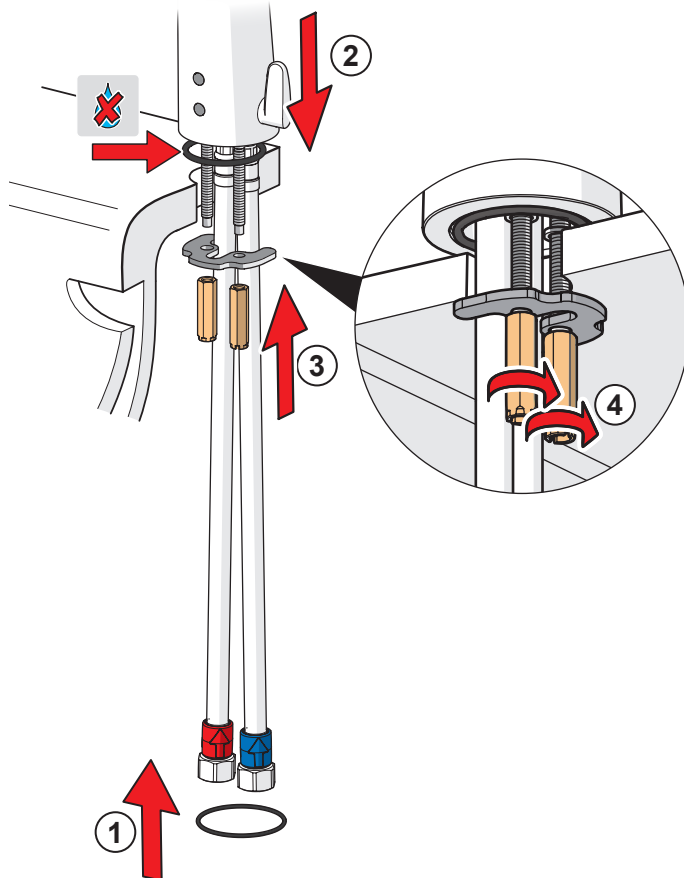

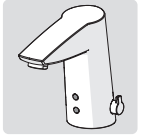
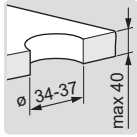
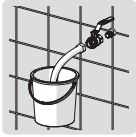
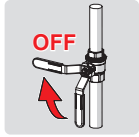

**1 B**

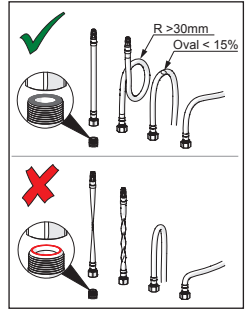
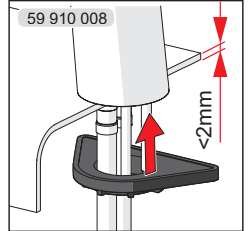
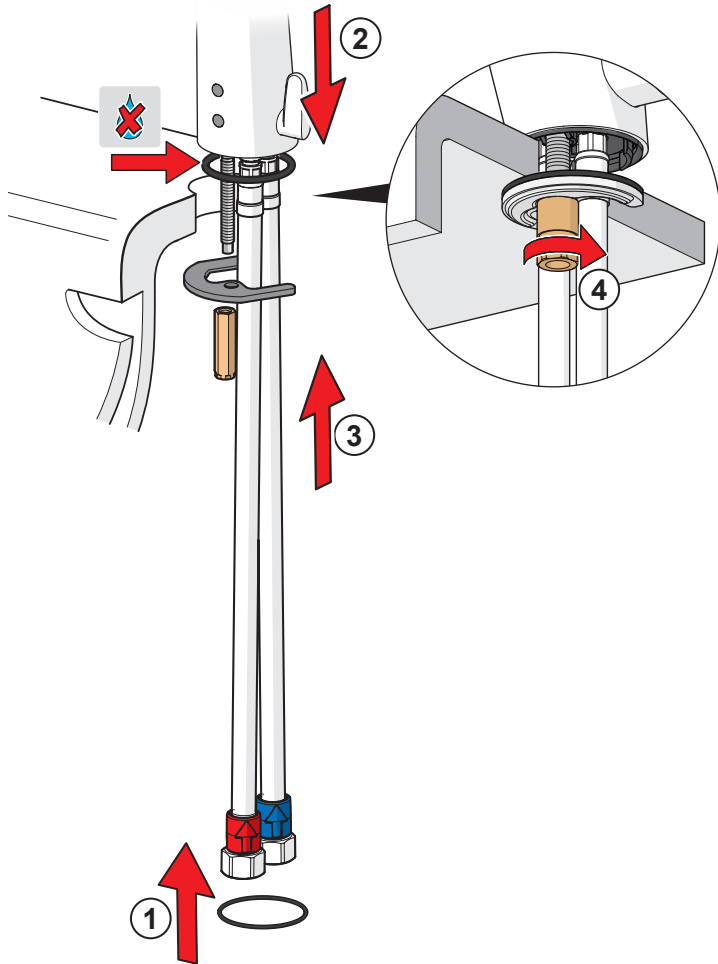

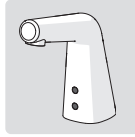
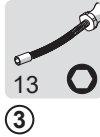
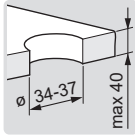
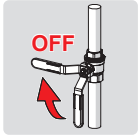

**1 C**

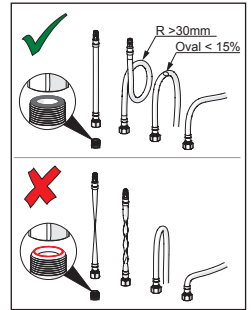
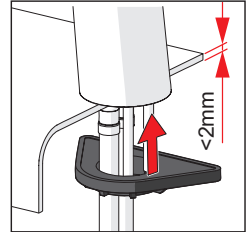
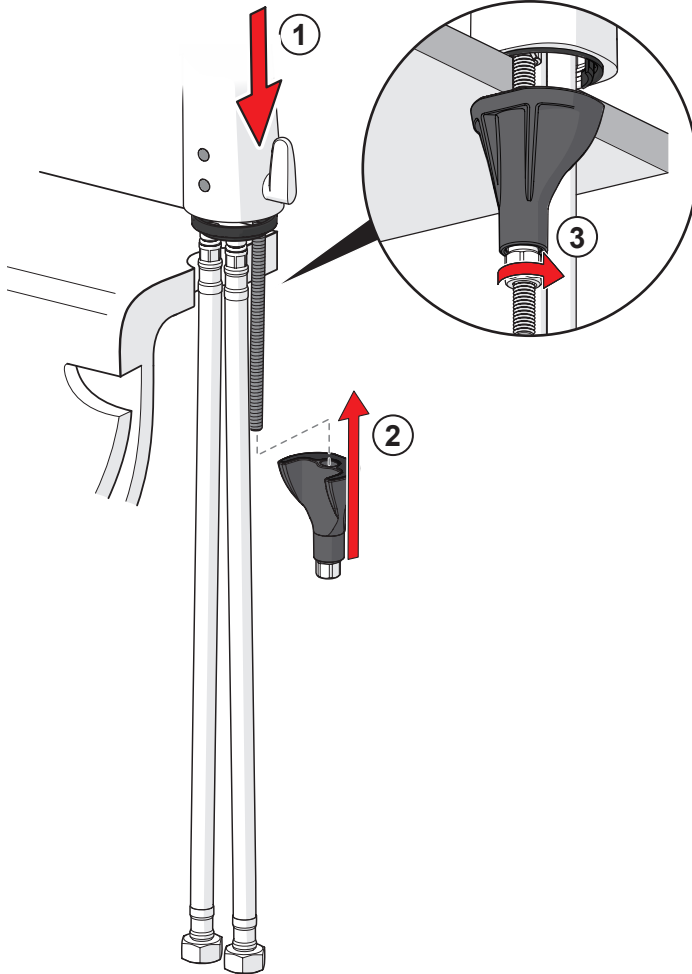

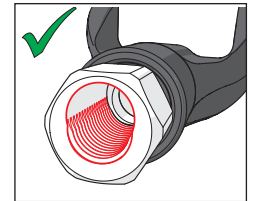
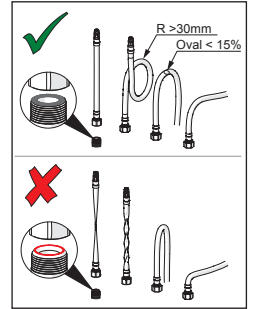
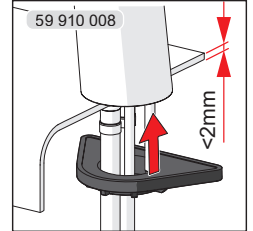
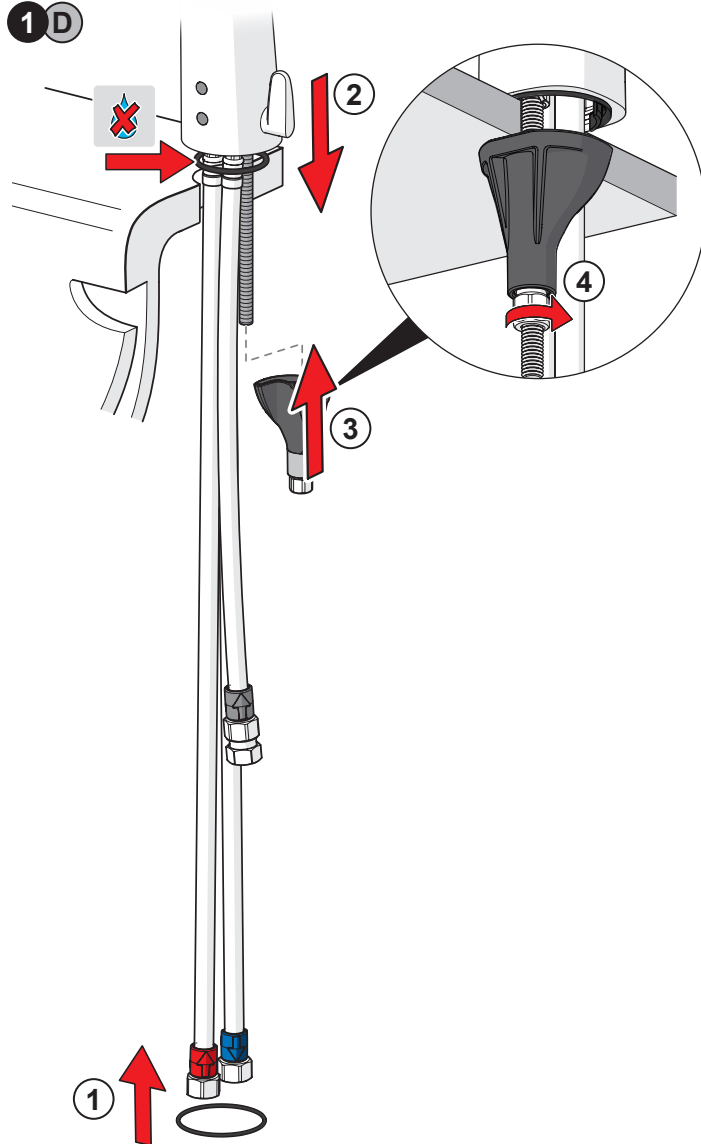
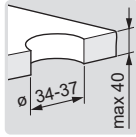
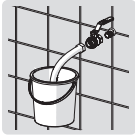
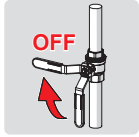



1 2

max.  
1600 kPa

2 A

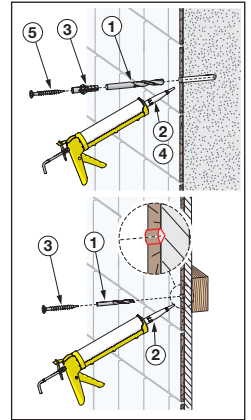
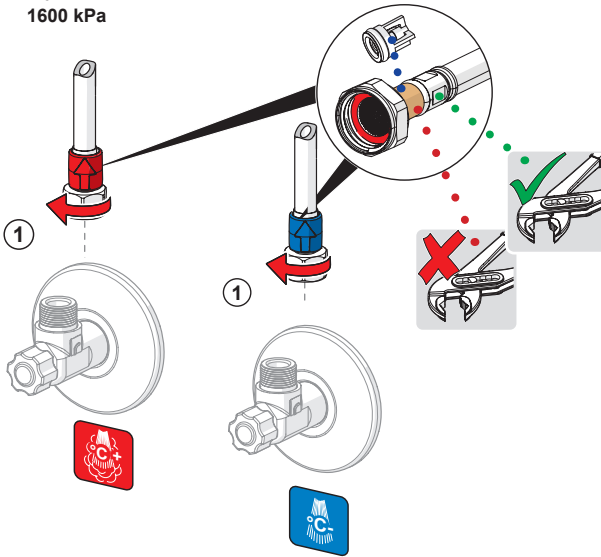

2 B

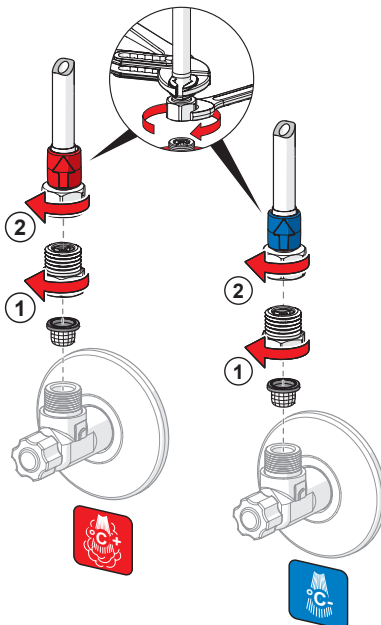



19

①②③④



max.  
1600 kPa



**2C**

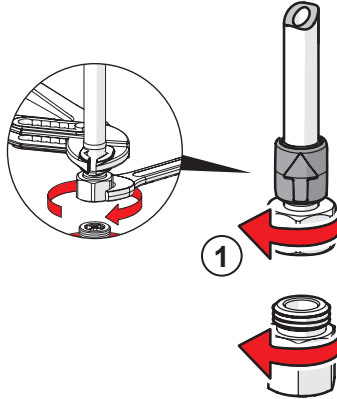

①

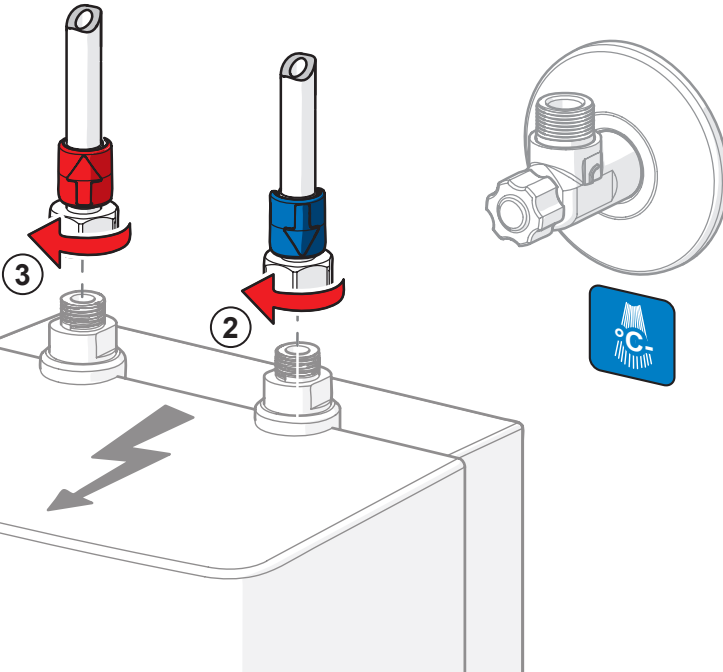

③

②





**3 A**

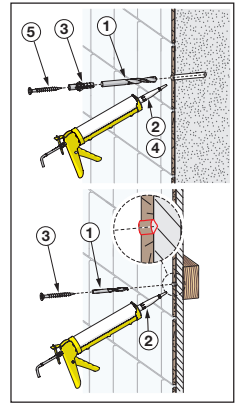
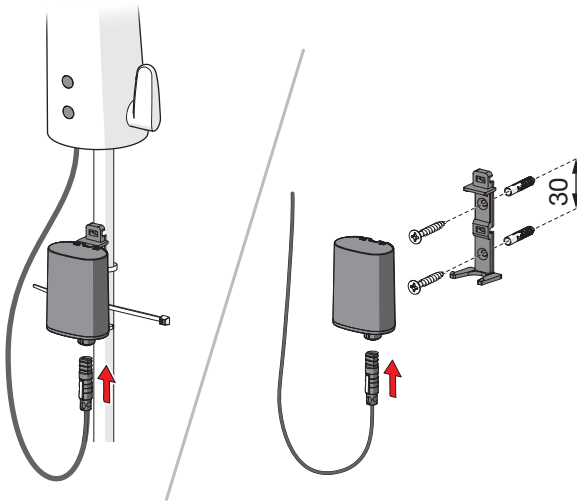

**3 B**

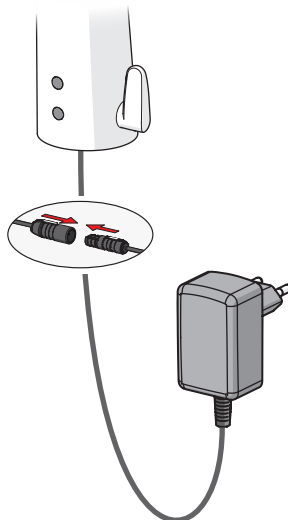

**6449 0900**





**3 C**

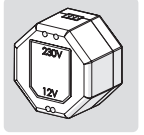
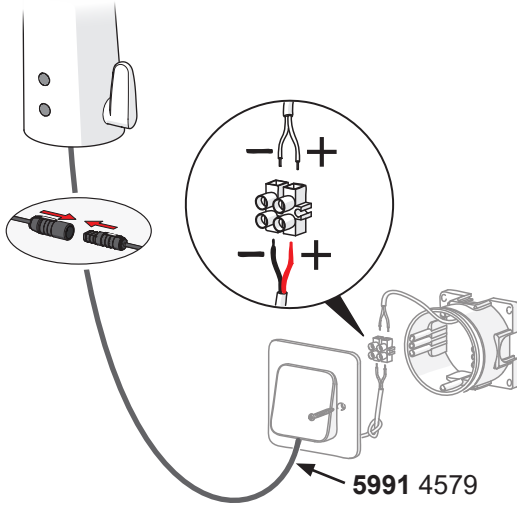

**6499 0100**

**3 D**

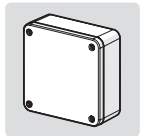
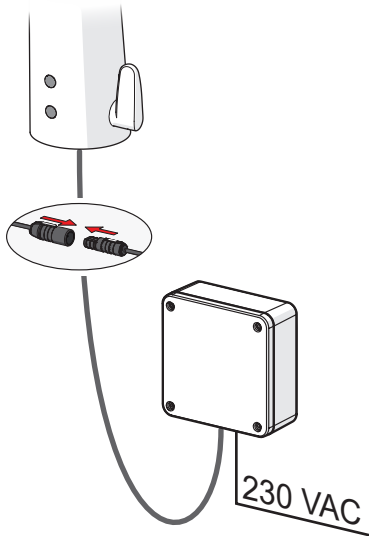

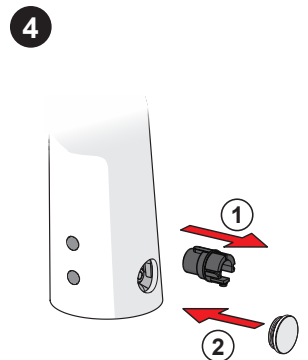
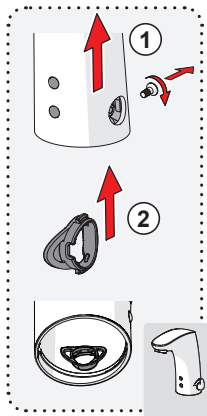
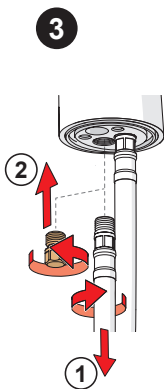
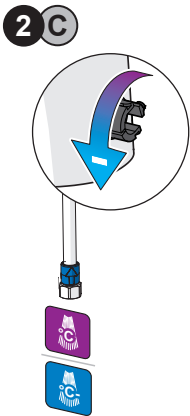
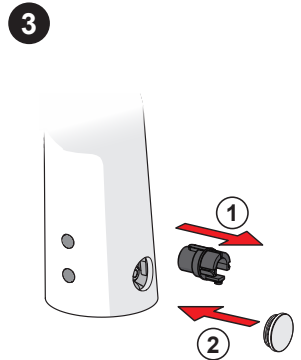
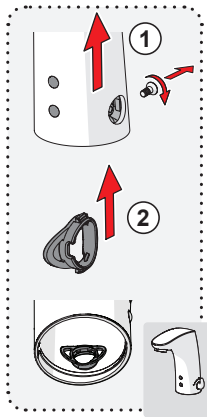
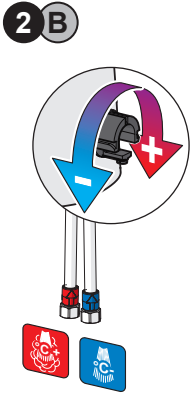
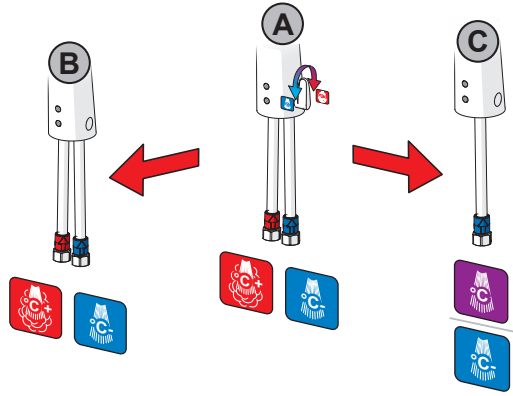
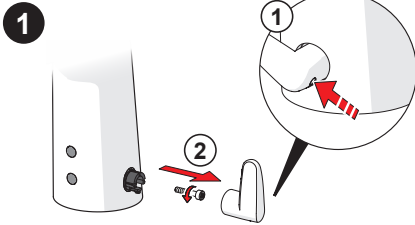
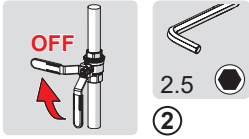



**AUTOMATIC**

**2 s ± 1 s**

**max. 2 min**

**Bluetooth®**

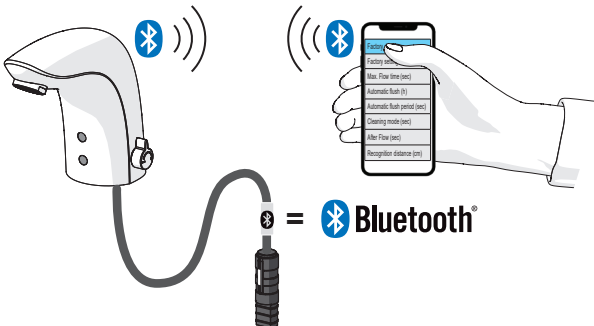
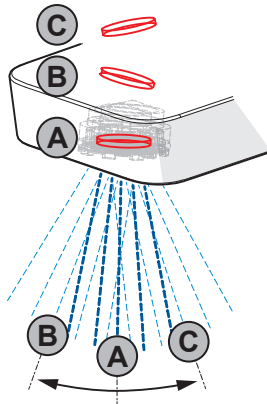
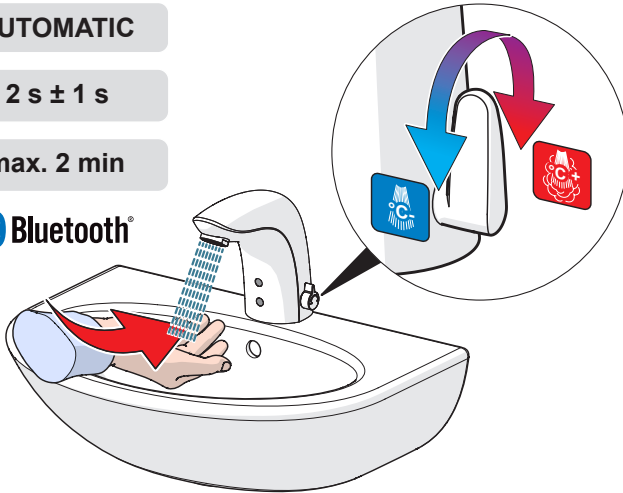

HANSA Connect App

Download on the  
**App Store**

GET IT ON  
**Google Play**

[hansa.com/hansa-app](https://hansa.com/hansa-app)



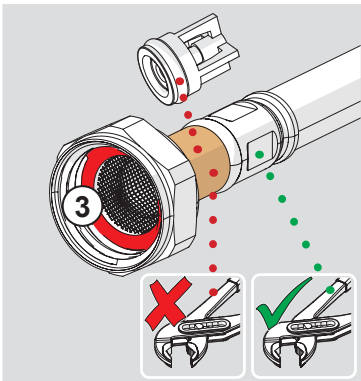
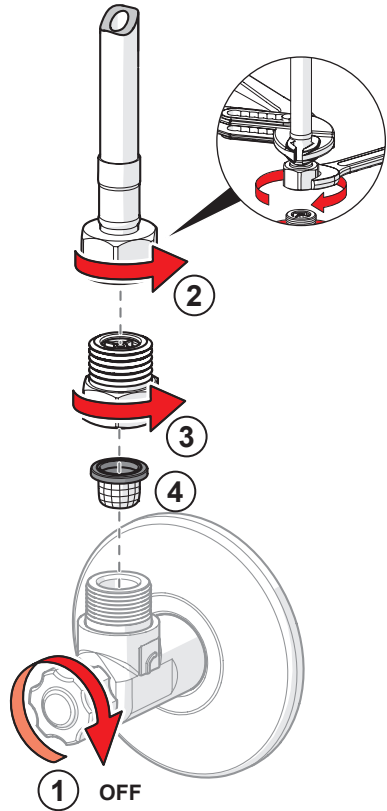
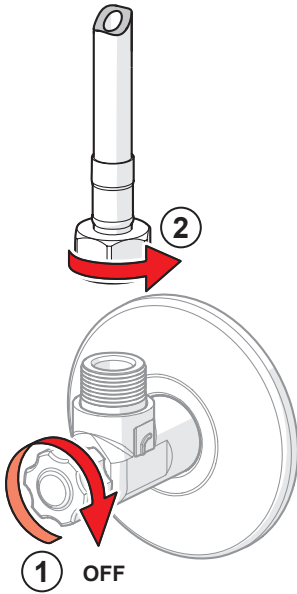
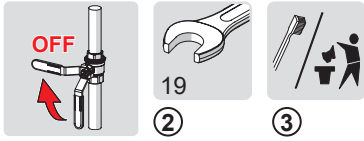
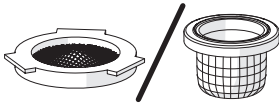

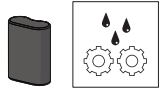

Lithium 2CR5 6V

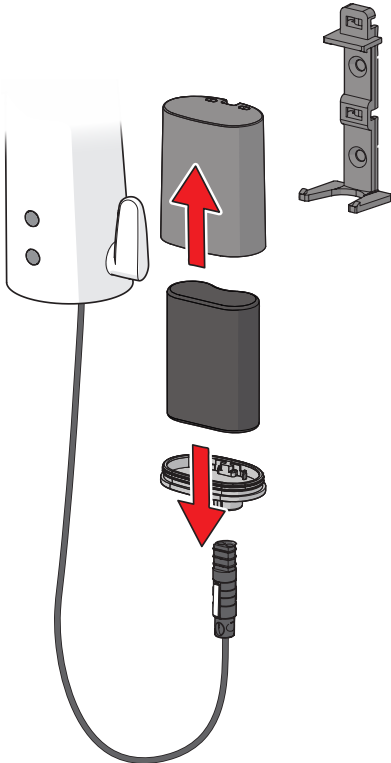



2.5

① ②

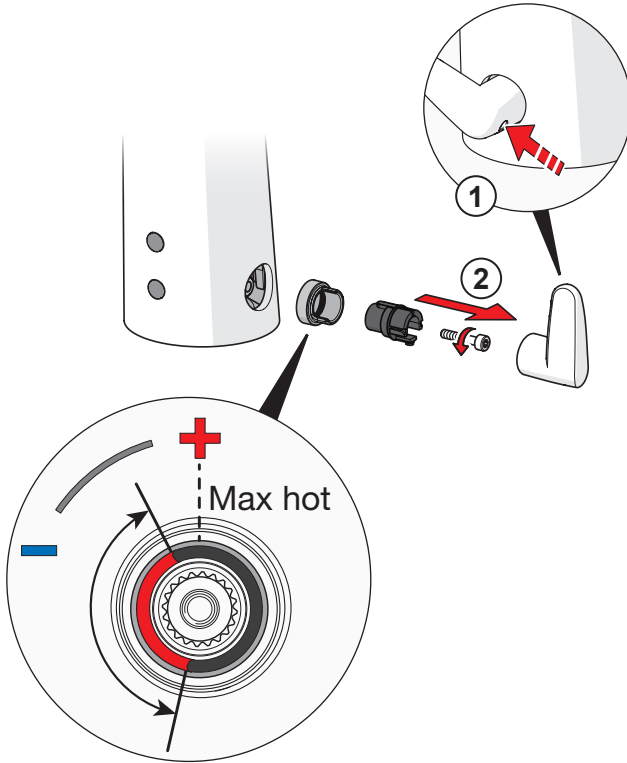

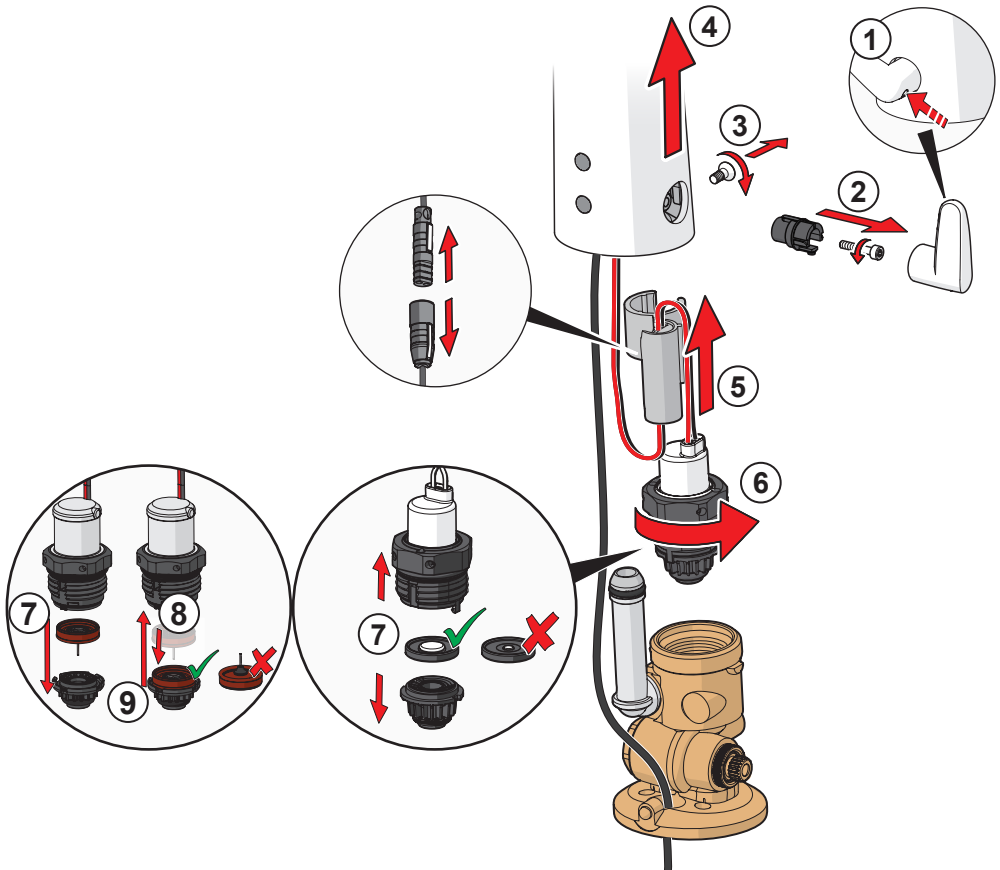
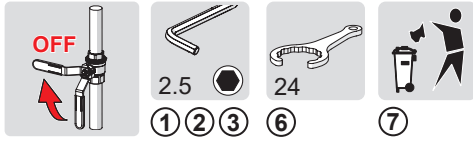

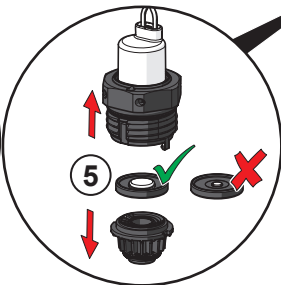
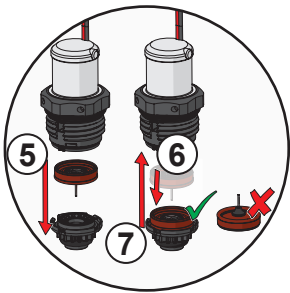
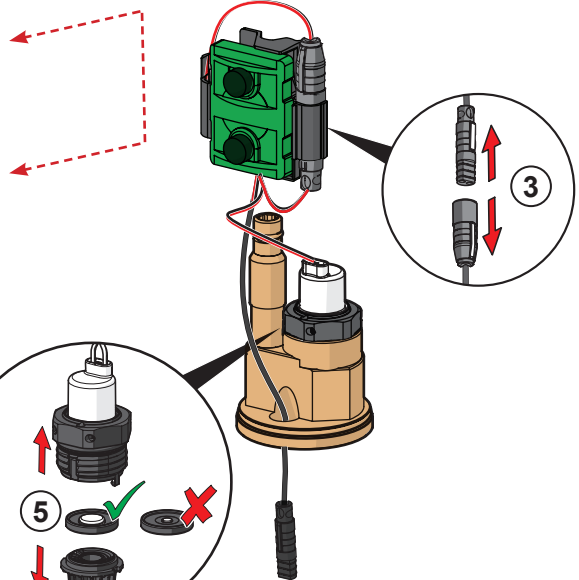
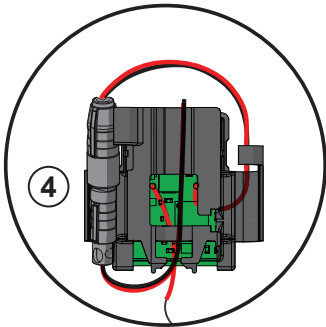
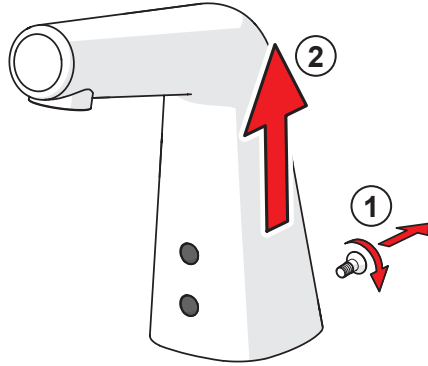
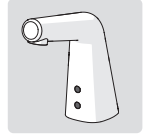
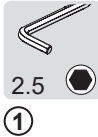
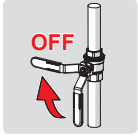



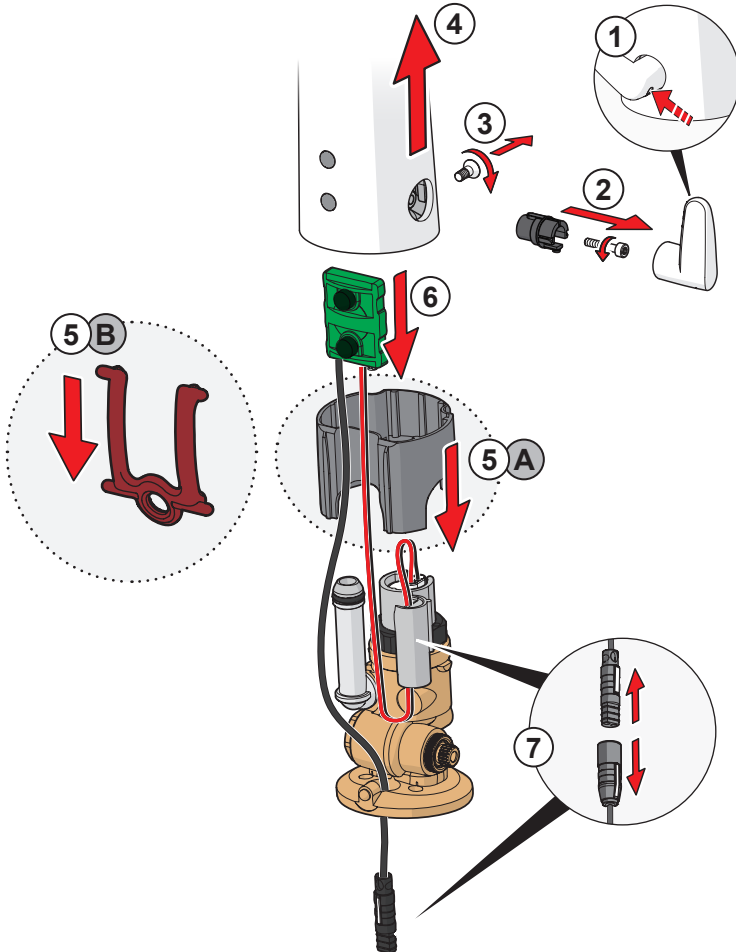
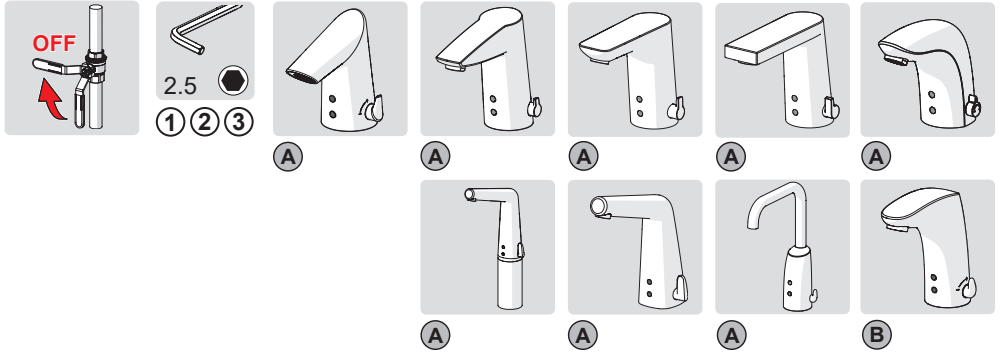

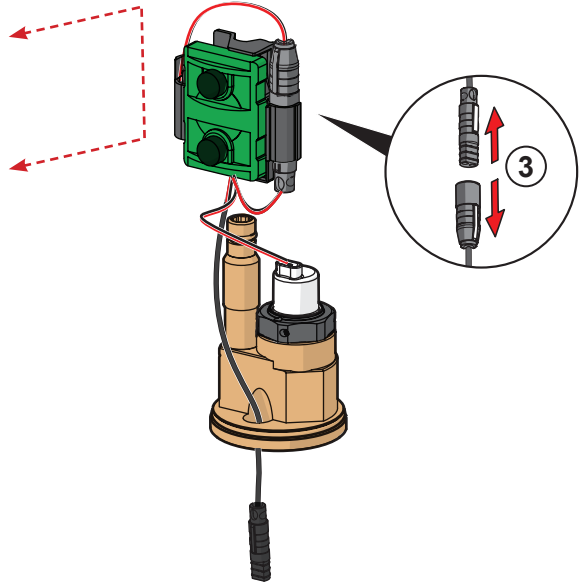
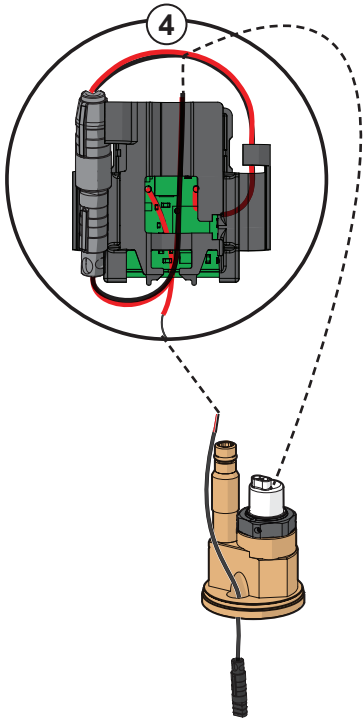
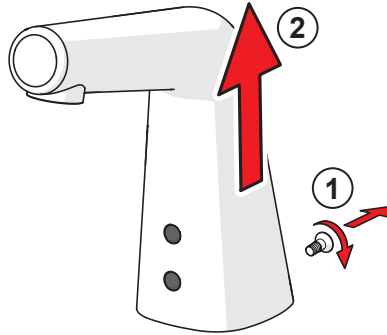
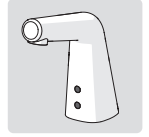
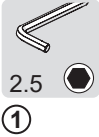
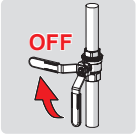

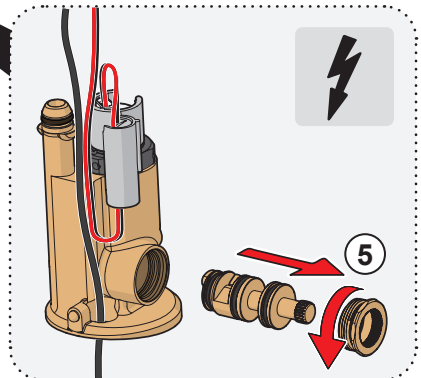
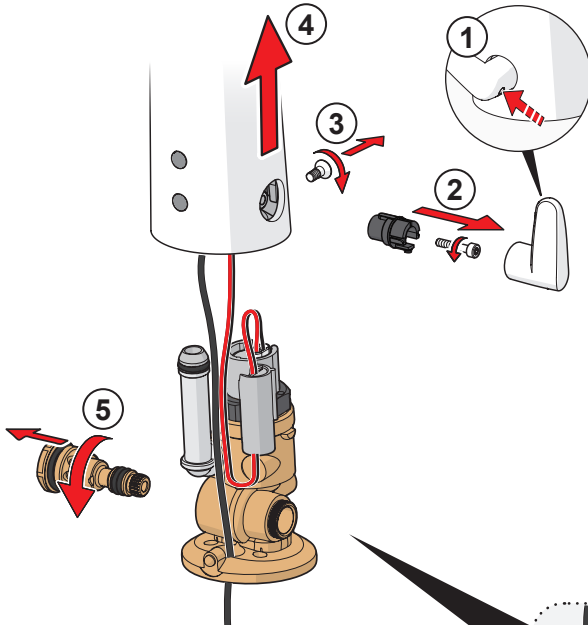
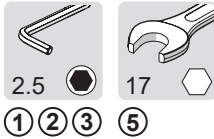
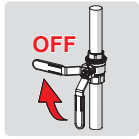

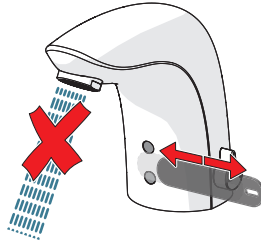
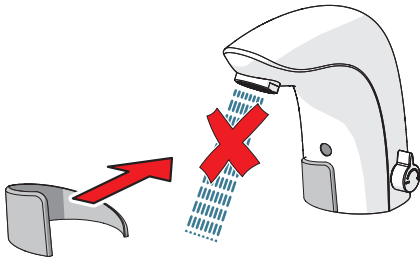

- 1 ON
- 2
- 3
- 4   
on 30 s (factory settings)
- 5 automatic off / off

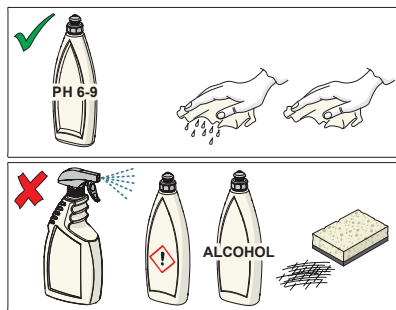
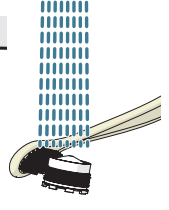
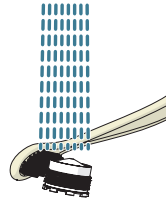
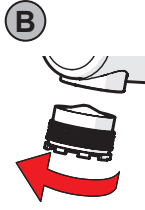
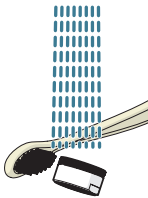
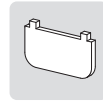
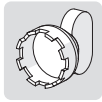







Oras Group is a powerful European provider of sanitary fittings: the market leader in the Nordics and a leading company in Continental Europe. The company's mission is to make the use of water easy and sustainable and its vision is to become the European leader of advanced sanitary fittings. Oras Group has two strong brands: Oras and Hansa.

The Group's head office is located in Rauma, Finland, and the Group has three manufacturing sites: Kralovice (Czech Republic), Olesno (Poland) and Rauma (Finland). Oras Group employs approximately 1,200 people in twenty countries. Oras Group is owned by Oras Invest, a family company and an industrial owner.

HANSA Armaturen GmbH  
P. O. BOX 81 02 40  
D-70519 Stuttgart  
Sigmaringer Strasse 107  
D-70567 Stuttgart  
Tel.: +49 711 16 14 0  
Fax: +49 711 16 14 368  
info@hansa.de  
www.hansa.com

