

## Walraven Heavy Duty Clamp HD500 (M16) (BUP1000)

(B1006)

for steel pipes

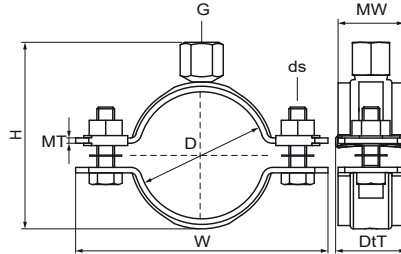

### Features & benefits

- two-part clamp with two locking bolts
- heavy design
- bolts secured with anti-loss washer
- with CO<sub>2</sub> welded connection nut
- material: steel
- surface protection:
- product is part of the Walraven BIS UltraProtect® 1000 system
- suitable for in- and outdoor applications
- stands min. 1,000 hours salt spray test (max. 5% red rust) according to ISO 9227
- also available: noise insulating lining of silicone rubber (reddish brown), heat resistant up to +200 °C (A 35 15)
- tested for fire safety



Product Number	NRF Number	Outside Pipe Diameter	DN	Pipe Diameter Imperial	Connection Thread	Total Height	Total Width	Total Depth	Material Width	Material Thickness	Screw Size	Maximum Allowed Load Faz	Approvals
Reference Letter	D	D	D	G	H	W	DtT	MW	MT	ds	Fa,z		
Unit description	mm		"	mm		mm	mm	mm	mm	mm	N		
33068169	3485839	159 - 169	DN 150	6	M16	193	240	38	38	4.00	M10	8,200	RAL-GZ 655/B, ITB (KOT), ETA, CE, EPD
33068183	3485841	173 - 183			M16	207	255	38	38	4.00	M10	8,200	RAL-GZ 655/B, VdS, ITB (KOT), ETA, CE, EPD
33068202	3485842	192 - 202			M16	226	274	38	38	4.00	M10	8,200	RAL-GZ 655/B, VdS, ITB (KOT), ETA, CE, EPD
33068227	3485843	217 - 227	DN 200	8	M16	251	299	38	38	4.00	M10	8,200	RAL-GZ 655/B, ITB (KOT), ETA, CE, EPD
33068241	3485844	229 - 241			M16	265	322	38	38	4.00	M12	8,200	RAL-GZ 655/B, ITB (KOT), ETA, CE, EPD
33068254	3485845	244 - 254			M16	278	335	38	38	4.00	M12	8,200	RAL-GZ 655/B, ITB (KOT), ETA, CE, EPD
33068264	3485846	254 - 264			M16	288	345	38	38	4.00	M12	8,200	RAL-GZ 655/B, ITB (KOT), ETA, CE, EPD
33068279	3485847	267 - 279	DN 250	10	M16	303	360	38	38	4.00	M12	8,200	RAL-GZ 655/B, ITB (KOT), ETA, CE, EPD
33068289	3485848	279 - 289			M16	312	368	48	48	5.00	M12	12,000	ITB (KOT), ETA, CE, RAL-GZ 655/B
33068302	3485849	292 - 302			M16	325	381	48	48	5.00	M12	12,000	ITB (KOT), ETA, CE, RAL-GZ 655/B
33068325	3485851	315 - 325	DN 300	12	M16	348	404	48	48	5.00	M12	12,000	ITB (KOT), ETA, CE, RAL-GZ 655/B
33068360	3485852	350 - 360	DN 350	14	M16	383	439	48	48	5.00	M12	12,000	ITB (KOT), ETA, CE, RAL-GZ 655/B, EPD
33068374	3485853	364 - 374			M16	397	453	48	48	5.00	M12	12,000	ITB (KOT), ETA, CE, RAL-GZ 655/B, EPD
33068389	3485854	379 - 389			M16	412	468	48	48	5.00	M12	12,000	ITB (KOT), ETA, CE, RAL-GZ 655/B, EPD
33068408	3485855	398 - 408	DN 400	16	M16	431	487	48	48	5.00	M12	12,000	ITB (KOT), ETA, CE, RAL-GZ 655/B, EPD
33068418	3485856	408 - 418			M16	441	497	48	48	5.00	M12	12,000	ITB (KOT), ETA, CE, RAL-GZ 655/B, EPD
33068436	3485857	424 - 436			M16	459	515	48	48	5.00	M12	12,000	ITB (KOT), ETA, CE, RAL-GZ 655/B, EPD
33068458	3485858	448 - 458	DN 450	18	M16	481	538	48	48	5.00	M12	12,000	ITB (KOT), ETA, CE, RAL-GZ 655/B, EPD
33068509	3485859	499 - 509	DN 500	20	M16	532	589	48	48	5.00	M12	12,000	ITB (KOT), ETA, CE, RAL-GZ 655/B, EPD
33068219		208 - 219			M16	243	291	38	38	4.00	M10	8,200	RAL-GZ 655/B, VdS, ITB (KOT), ETA, CE, EPD