

Walraven Heavy Duty Clamp HD500 (M16) (BUP1000)

(B1006)

for steel pipes

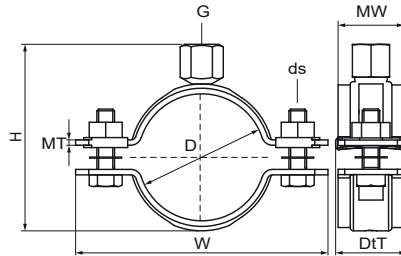

Features & benefits

- two-part clamp with two locking bolts
- heavy design
- bolts secured with anti-loss washer
- with CO₂ welded connection nut
- material: steel
- surface protection:
- product is part of the Walraven BIS UltraProtect® 1000 system
- suitable for in- and outdoor applications
- stands min. 1,000 hours salt spray test (max. 5% red rust) according to ISO 9227
- also available: noise insulating lining of silicone rubber (reddish brown), heat resistant up to +200 °C (A 35 15)
- tested for fire safety



Product Number	VVS Number	Outside Pipe Diameter	DN	Pipe Diameter Imperial	Connection Thread	Total Height	Total Width	Total Depth	Material Width	Material Thickness	Screw Size	Maximum Allowed Load Faz	Approvals
Reference Letter		D	D	D	G	H	W	Dt	MW	MT	ds	F _{a,z}	
Unit description		mm		"		mm	mm	mm	mm	mm		N	
33068169		159 - 169	DN 150	6	M16	193	240	38	38	4.00	M10	8,200	RAL-GZ 655/B, ITB (KOT), ETA, CE, EPD
33068183		173 - 183			M16	207	255	38	38	4.00	M10	8,200	RAL-GZ 655/B, VdS, ITB (KOT), ETA, CE, EPD
33068202		192 - 202			M16	226	274	38	38	4.00	M10	8,200	RAL-GZ 655/B, VdS, ITB (KOT), ETA, CE, EPD
33068227	18024323	217 - 227	DN 200	8	M16	251	299	38	38	4.00	M10	8,200	RAL-GZ 655/B, ITB (KOT), ETA, CE, EPD
33068241	18024324	229 - 241			M16	265	322	38	38	4.00	M12	8,200	RAL-GZ 655/B, ITB (KOT), ETA, CE, EPD
33068254	18024325	244 - 254			M16	278	335	38	38	4.00	M12	8,200	RAL-GZ 655/B, ITB (KOT), ETA, CE, EPD
33068264	18024326	254 - 264			M16	288	345	38	38	4.00	M12	8,200	RAL-GZ 655/B, ITB (KOT), ETA, CE, EPD
33068279	18024328	267 - 279	DN 250	10	M16	303	360	38	38	4.00	M12	8,200	RAL-GZ 655/B, ITB (KOT), ETA, CE, EPD
33068289	18024329	279 - 289			M16	312	368	48	48	5.00	M12	12,000	ITB (KOT), ETA, CE, RAL-GZ 655/B
33068302	18024330	292 - 302			M16	325	381	48	48	5.00	M12	12,000	ITB (KOT), ETA, CE, RAL-GZ 655/B
33068325	18024333	315 - 325	DN 300	12	M16	348	404	48	48	5.00	M12	12,000	ITB (KOT), ETA, CE, RAL-GZ 655/B
33068360	18024336	350 - 360	DN 350	14	M16	383	439	48	48	5.00	M12	12,000	ITB (KOT), ETA, CE, RAL-GZ 655/B, EPD
33068374	18024337	364 - 374			M16	397	453	48	48	5.00	M12	12,000	ITB (KOT), ETA, CE, RAL-GZ 655/B, EPD
33068389		379 - 389			M16	412	468	48	48	5.00	M12	12,000	ITB (KOT), ETA, CE, RAL-GZ 655/B, EPD
33068408	18024341	398 - 408	DN 400	16	M16	431	487	48	48	5.00	M12	12,000	ITB (KOT), ETA, CE, RAL-GZ 655/B, EPD
33068418		408 - 418			M16	441	497	48	48	5.00	M12	12,000	ITB (KOT), ETA, CE, RAL-GZ 655/B, EPD
33068436		424 - 436			M16	459	515	48	48	5.00	M12	12,000	ITB (KOT), ETA, CE, RAL-GZ 655/B, EPD
33068458	18024346	448 - 458	DN 450	18	M16	481	538	48	48	5.00	M12	12,000	ITB (KOT), ETA, CE, RAL-GZ 655/B, EPD
33068509	18024351	499 - 509	DN 500	20	M16	532	589	48	48	5.00	M12	12,000	ITB (KOT), ETA, CE, RAL-GZ 655/B, EPD
33068219		208 - 219			M16	243	291	38	38	4.00	M10	8,200	RAL-GZ 655/B, VdS, ITB (KOT), ETA, CE, EPD