

Walraven Heavy Duty Clamp HD500 (1/2") (BUP1000)

(B1009)

for steel pipes

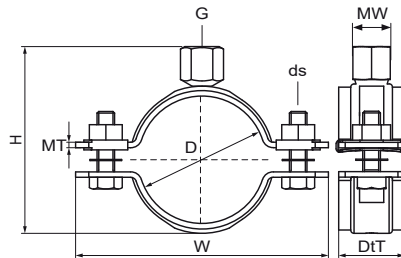

Features & benefits

- two-part clamp with two locking bolts
- heavy design
- bolts secured with anti-loss washer
- with CO₂ welded connection nut
- material: steel
- surface protection:
- product is part of the Walraven BIS UltraProtect® 1000 system
- suitable for in- and outdoor applications
- stands min. 1,000 hours salt spray test (max. 5% red rust) according to ISO 9227
- also available: noise insulating lining of silicone rubber (reddish brown), heat resistant up to +200 °C (A 35 15)
- tested for fire safety



Product Number	Outside Pipe Diameter	DN	Pipe Diameter Imperial	Connection Thread	Total Height	Total Width	Total Depth	Material Width	Material Thickness	Screw Size	Maximum Allowed Load Faz	Approvals
Reference Letter	D	D	D	G	H	W	DdT	MW	MT	ds	F _{0,z}	
Unit description	mm		"		mm	mm	mm	mm	mm		N	
33078019	15 - 19	DN 10	3/8	G1/2"	41	75	32	30	2.50	M8	2,100	ITB (KOT), CE, ETA, RAL-GZ 655/B, EPD
33078023	19 - 23	DN 15	1/2	G1/2"	45	79	32	30	2.50	M8	2,100	ITB (KOT), CE, ETA, RAL-GZ 655/B, EPD
33078030	25 - 30	DN 20	3/4	G1/2"	52	85	32	30	2.50	M8	2,100	ITB (KOT), CE, ETA, RAL-GZ 655/B, EPD
33078036	31 - 36	DN 25	1	G1/2"	58	91	32	30	2.50	M8	2,100	ITB (KOT), CE, ETA, RAL-GZ 655/B, EPD
33078042	37 - 42	-	-	G1/2"	65	98	32	30	2.50	M8	2,100	ITB (KOT), CE, ETA, RAL-GZ 655/B, EPD
33078045	40 - 45	DN 32	1 1/4	G1/2"	68	102	32	30	2.50	M8	2,100	ITB (KOT), CE, ETA, RAL-GZ 655/B, EPD
33078052	47 - 52	DN 40	1 1/2	G1/2"	75	109	32	30	2.50	M8	2,100	ITB (KOT), CE, ETA, RAL-GZ 655/B, EPD
33078058	53 - 58	-	-	G1/2"	81	114	32	30	2.50	M8	2,100	ITB (KOT), CE, ETA, RAL-GZ 655/B, EPD
33078065	59 - 65	DN 50	2	G1/2"	88	121	32	30	2.50	M8	2,100	ITB (KOT), CE, ETA, RAL-GZ 655/B, EPD
33078071	66 - 71	-	-	G1/2"	94	129	32	30	2.50	M8	2,100	ITB (KOT), CE, ETA, RAL-GZ 655/B, EPD
33078078	72 - 78	DN 65	2 1/2	G1/2"	102	137	32	30	3.00	M8	4,000	ITB (KOT), CE, ETA, RAL-GZ 655/B, EPD
33078085	79 - 85	-	-	G1/2"	109	144	32	30	3.00	M8	4,000	ITB (KOT), CE, ETA, RAL-GZ 655/B, EPD
33078092	86 - 92	DN 80	3	G1/2"	116	151	32	30	3.00	M8	4,000	ITB (KOT), CE, ETA, RAL-GZ 655/B, EPD
33078106	98 - 106	-	-	G1/2"	130	165	32	30	3.00	M8	4,000	ITB (KOT), CE, ETA, RAL-GZ 655/B, EPD
33078116	108 - 116	DN 100	4	G1/2"	140	175	32	30	3.00	M8	4,000	ITB (KOT), CE, ETA, RAL-GZ 655/B, EPD
33078133	125 - 133	-	-	G1/2"	157	192	32	30	3.00	M8	4,000	ITB (KOT), CE, ETA, RAL-GZ 655/B, EPD
33078140	132 - 140	DN 125	5	G1/2"	164	199	32	30	3.00	M8	4,000	ITB (KOT), CE, ETA, RAL-GZ 655/B, EPD
33078154	148 - 154	-	-	G1/2"	179	213	32	30	3.00	M8	4,000	ITB (KOT), CE, ETA, RAL-GZ 655/B, EPD
33078169	159 - 169	DN 150	6	G1/2"	195	240	38	38	4.00	M10	8,200	ITB (KOT), CE, ETA, RAL-GZ 655/B, EPD
33078183	173 - 183	-	-	G1/2"	209	254	38	38	4.00	M10	8,200	ITB (KOT), CE, ETA, RAL-GZ 655/B, EPD
33078202	192 - 202	-	-	G1/2"	228	274	38	38	4.00	M10	8,200	ITB (KOT), CE, ETA, RAL-GZ 655/B, EPD

Walraven Heavy Duty Clamp HD500 (1/2") (BUP1000)

(B1009)

for steel pipes

Product Number	Outside Pipe Diameter	DN	Pipe Diameter Imperial	Connection Thread	Total Height	Total Width	Total Depth	Material Width	Material Thickness	Screw Size	Maximum Allowed Load Faz	Approvals
Reference Letter	D	D	D	G	H	W	DtT	MW	MT	ds	Fa,z	
Unit description	mm		"		mm	mm	mm	mm	mm		N	
33078219	208 - 219	-	-	G1/2"	245	291	38	38	4.00	M10	8,200	ITB (KOT), CE, ETA, RAL-GZ 655/B, EPD
33078227	217 - 227	DN 200	8	G1/2"	253	299	38	38	4.00	M10	8,200	ITB (KOT), CE, ETA, RAL-GZ 655/B, EPD
33078254	244 - 254	-	-	G1/2"	280	335	38	38	4.00	M12	8,200	ITB (KOT), CE, ETA, RAL-GZ 655/B, EPD
33078279	267 - 279	DN 250	10	G1/2"	305	360	38	38	4.00	M12	8,200	ITB (KOT), CE, ETA, RAL-GZ 655/B, EPD
33078289	279 - 289	-	-	G1/2"	314	368	48	48	5.00	M12	12,000	ITB (KOT), CE, ETA, RAL-GZ 655/B
33078325	315 - 325	DN 300	12	G1/2"	350	404	48	48	5.00	M12	12,000	ITB (KOT), CE, ETA, RAL-GZ 655/B
33078360	350 - 360	-	-	G1/2"	385	439	48	48	5.00	M12	12,000	ITB (KOT), CE, ETA, RAL-GZ 655/B, EPD
33078408	398 - 408	DN 400	16	G1/2"	433	487	48	48	5.00	M12	12,000	ITB (KOT), CE, ETA, RAL-GZ 655/B, EPD
33078436	424 - 436	-	-	G1/2"	461	515	48	48	5.00	M12	12,000	ITB (KOT), CE, ETA, RAL-GZ 655/B, EPD
33078458	448 - 458	DN 450	18	G1/2"	483	538	48	48	5.00	M12	12,000	ITB (KOT), CE, ETA, RAL-GZ 655/B, EPD
33078509	499 - 509	DN 500	20	G1/2"	534	589	48	48	5.00	M12	12,000	ITB (KOT), CE, ETA, RAL-GZ 655/B, EPD
33078564	554 - 564	-	-	G1/2"	589	644	48	48	5.00	M12	12,000	ITB (KOT), CE, ETA, RAL-GZ 655/B, EPD