

## Walraven Bifix® 300 Stainless Steel (M10)

(M1006)

for stainless steel and plastic pipes

### Features & benefits

- two-screw clamp
- with quick locking system
- material: stainless steel 1.4404 (AISI 316L)

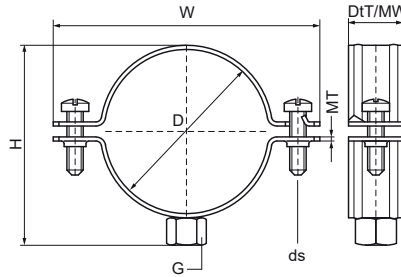

| Product Number   | VVS Number | Outside Pipe Diameter | DN     | Pipe Diameter Imperial | Connection Thread | Total Height | Total Width | Total Depth | Material Width | Material Thickness | Screw Size | Maximum Allowed Load Faz | Approvals                    |
|------------------|------------|-----------------------|--------|------------------------|-------------------|--------------|-------------|-------------|----------------|--------------------|------------|--------------------------|------------------------------|
| Reference Letter |            | D                     | D      | D                      | G                 | H            | W           | Dt          | MW             | MT                 | ds         | Fa,z                     |                              |
| Unit description |            | mm                    |        | "                      |                   | mm           | mm          | mm          | mm             | mm                 |            | N                        |                              |
| 3027068          | 18014262   | 62 - 68               | -      | -                      | M10               | 80           | 102         | 20          | 20             | 1.25               | M6         | 1,500                    | RAL-GZ 655/B, ITB (KOT), EPD |
| 3027076          |            | 72 - 76               | -      | -                      | M10               | 87           | 109         | 20          | 20             | 2.00               | M6         | 1,500                    | RAL-GZ 655/B, ITB (KOT), EPD |
| 3027085          | 18014264   | 79 - 85               | -      | -                      | M10               | 97           | 118         | 20          | 20             | 2.00               | M6         | 1,500                    | RAL-GZ 655/B, ITB (KOT), EPD |
| 3027089          | 18014265   | 85 - 89               | DN 80  | 3                      | M10               | 102          | 124         | 20          | 20             | 2.00               | M6         | 1,500                    | RAL-GZ 655/B, ITB (KOT), EPD |
| 3027105          | 18014270   | 100 - 105             | -      | -                      | M10               | 117          | 139         | 20          | 20             | 2.00               | M6         | 1,500                    | RAL-GZ 655/B, ITB (KOT), EPD |
| 3027111          | 18014272   | 106 - 111             | -      | -                      | M10               | 124          | 146         | 20          | 20             | 2.50               | M6         | 1,900                    | RAL-GZ 655/B, ITB (KOT), EPD |
| 3027118          | 18014275   | 110 - 118             | DN 100 | 4                      | M10               | 132          | 154         | 20          | 20             | 2.50               | M6         | 1,900                    | RAL-GZ 655/B, ITB (KOT), EPD |
| 3027127          |            | 122 - 127             | -      | -                      | M10               | 140          | 163         | 20          | 20             | 2.50               | M6         | 1,900                    | RAL-GZ 655/B, ITB (KOT), EPD |
| 3027134          | 18014278   | 129 - 134             | -      | -                      | M10               | 148          | 170         | 20          | 20             | 2.50               | M6         | 1,900                    | RAL-GZ 655/B, ITB (KOT), EPD |
| 3027144          | 18014280   | 139 - 144             | DN 125 | 5                      | M10               | 157          | 179         | 20          | 20             | 2.50               | M6         | 1,900                    | RAL-GZ 655/B, ITB (KOT), EPD |
| 3027155          |            | 150 - 155             | -      | -                      | M10               | 172          | 192         | 20          | 20             | 2.50               | M6         | 1,900                    | RAL-GZ 655/B, ITB (KOT), EPD |
| 3027162          | 18014282   | 157 - 162             | -      | -                      | M10               | 174          | 196         | 20          | 20             | 2.50               | M6         | 1,900                    | RAL-GZ 655/B, ITB (KOT), EPD |
| 3027169          |            | 164 - 169             | DN 150 | 6                      | M10               | 182          | 204         | 20          | 20             | 2.50               | M6         | 1,900                    | RAL-GZ 655/B, ITB (KOT), EPD |
| 3027200          | 18014285   | 193 - 200             | -      | -                      | M10               | 216          | 256         | 25          | 20             | 2.50               | M8         | 1,900                    | RAL-GZ 655/B, ITB (KOT), EPD |
| 3027219          | 18014286   | 212 - 219             | DN 200 | 8                      | M10               | 233          | 273         | 25          | 25             | 2.50               | M8         | 1,900                    | RAL-GZ 655/B, ITB (KOT), EPD |