

# Circularity Profile

## SCADAPack 474 Smart RTU

### Remote Programmable Smart RTUs 470 / 474





## Potential disassembly risks

The Circularity profile provides information about preparation for re-use and treatment. It identifies the relevant EEE components and materials as well as their location. Safety instructions for product dismantling and depollution are provided into the User manual or maintenance guide.



## End of Life Instructions

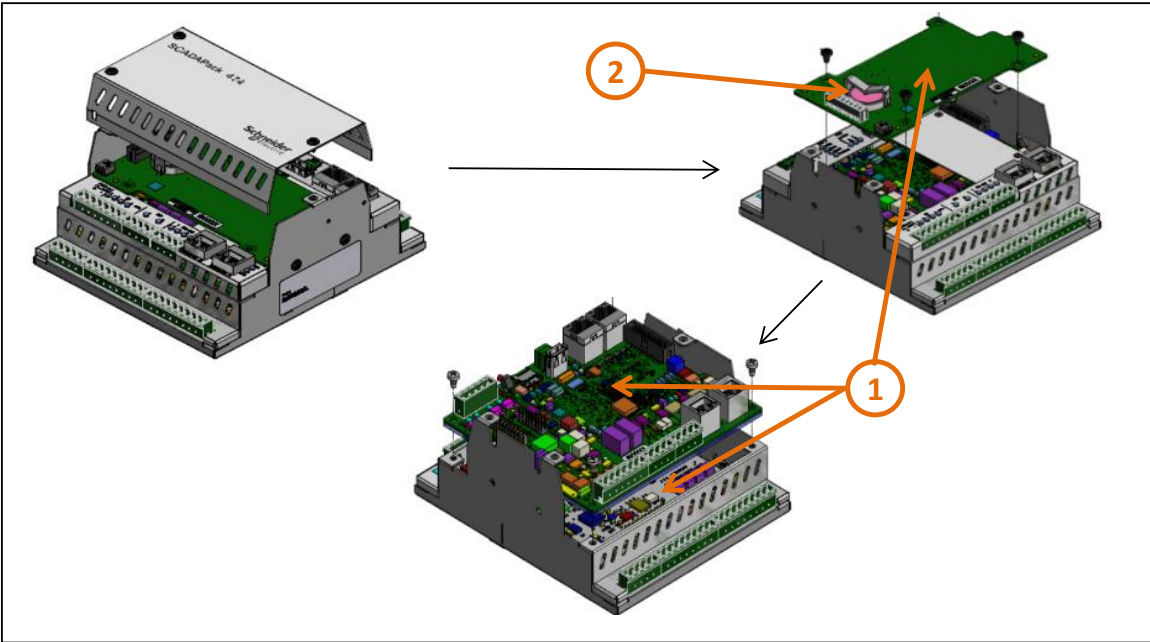

Recommendation	Number on drawing	Component / Material	Weight (in g)	Comment
To be depolluted	1	Electronic Board (Communication) > 10cm <sup>2</sup>	334.4	Three PCBAs > 10cm <sup>2</sup>
To be depolluted	2	Other battery	6	
Other			806.87	



## Product description

Manufacturer identification	Schneider Electric Industries SAS
Brand name	Schneider Electric
Product function	The representative product used for the analysis is TBUP474-UA50-BB10S which is a compact Programmable RTU (Remote Terminal Unit) that provides Remote Telemetry functions for use in SCADA and telemetry applications.
Product reference	TBUP474-UA50-BB10S
Additional similar product references	TBUP470-xxxx-xxxxx and TBUP474-xxxx-xxxxx
Total representative product mass	1134 g
Representative product dimensions	166 mm x 142 mm x 88 mm
Accessories	None
Date of information release	11/2019



## Additional information

Legal information	This product family is in the scope of European Union directive 2012/19/EU on Waste Electrical and Electronic Equipment (WEEE). The product family must be disposed according to the legislation of the country. This document is intended for use by end of life recyclers or treatment facilities. It provides the basic information to assure an appropriate end of life treatment for the components and materials of the product.	
In case of special transportation: transportation method	None	
Recyclability potential	<b>61%</b>	Based on "ECO'DEEE recyclability and recoverability calculation method" (version V1, 20 Sep. 2008 presented to the French Agency for Environment and Energy Management: ADEME).

Schneider Electric Industries SAS

Country Customer Care Center  
<http://www.schneider-electric.com/contact>

35, rue Joseph Monier  
CS 30323  
F- 92506 Rueil Malmaison Cedex  
RCS Nanterre 954 503 439  
Capital social 896 313 776 €

[www.schneider-electric.com](http://www.schneider-electric.com)

ENVEOLI1911017

Published by Schneider Electric

© 2019 - Schneider Electric – All rights reserved

11/2019

ENVEOLI1911017