







**CL.1 Wall valve clockwise closing 3/4" - Brushed Platinum**

CL.1

36 608 705 Product version up to 10/14/2020



- rosette 60 x 60 mm
- without marking
- head part with cut-to-length spindle and sleeve
- WRAS

	Brushed Platinum	36 608 705-06
	Chrome	36 608 705-00
	Dark Chrome	36 608 705-19
	Brushed Light Gold (PVD)	36 608 705-27
	Brushed Champagne (22kt Gold)	36 608 705-46
	Champagne (22kt Gold)	36 608 705-47
	Brushed Dark Platinum	36 608 705-99

**Required miscellaneous**



- Wall valve 3/4" - 35 608 970 90**
- min. recess depth 105 mm
  - max. recess depth 150 mm

36 608 705 Product version up to 10/14/2020

mm [inches]



**Flow rate chart**

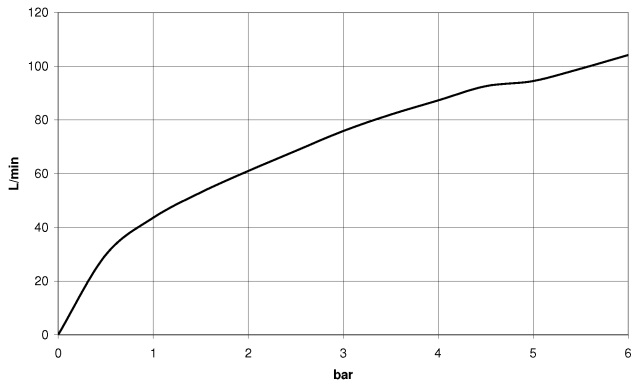

**Codes & Standards**

ASME A112.18.1

cUPC

Scottish Water  
Byelaws

UK Water Supply  
Regulations



## CL.1 Wall valve clockwise closing 3/4" - Brushed Platinum

CL.1

36 608 705 Product version up to 10/14/2020

### Certificates and sustainability

WRAS_2010	IAPMO_4976 (	EPD-DOR-20230287 -IBA1-EN Environmental.prod uct-declarat
-----------	--------------	--------------------------------------------------------------------

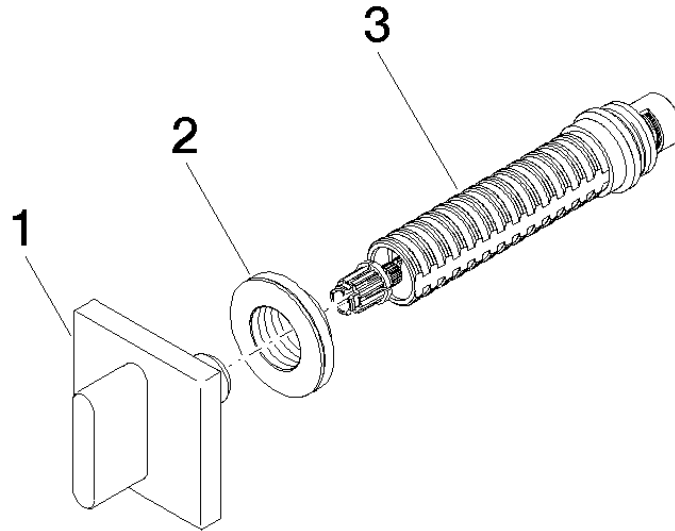

### Spare parts list

No.	Item Number	Name	Quantity used	Delivery time
3	90 90 03 127 00 90	Head part clockwise closing 3/4" -	1.00	14
1	90 20 70 051 01-06	Handle for concealed wall mounting Neutral oval pure 60 x 60 x 40 mm - Brushed Platinum	1.00	20
2	09 21 02 108 90	Sleeve Ø 43,1 x 13 mm -	1.00	-
Spare part can no longer be ordered, please order the replacement item				
	9021021080090	Wall disc complete -		