







CL.1 Wall valve anti-clockwise closing hot 1/2" - Chrome

CL.1

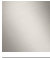
36 607 707 Product version up to 10/14/2020



- rosette 60 x 60 mm
- with hot marking
- head part with cut-to-length spindle and sleeve
- WRAS

	Chrome	36 607 707-00
	Brushed Platinum	36 607 707-06
	Dark Chrome	36 607 707-19
	Brushed Light Gold (PVD)	36 607 707-27
	Brushed Champagne (22kt Gold)	36 607 707-46
	Champagne (22kt Gold)	36 607 707-47
	Brushed Dark Platinum	36 607 707-99

Required miscellaneous



- Wall valve 1/2" -** 35 607 970 90
- min. recess depth 105 mm
 - max. recess depth 150 mm

36 607 707 Product version up to 10/14/2020

mm [inches]



Flow rate chart

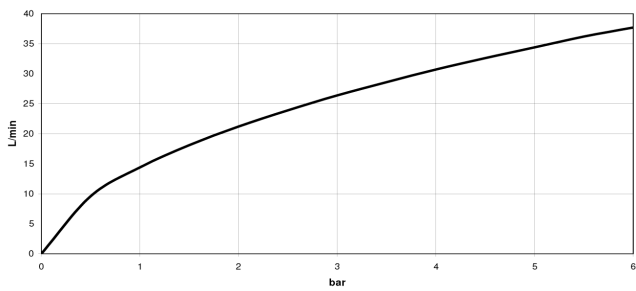

Codes & Standards

ASME A112.18.1	cUPC	DIN 4109	EN 200
ISO 3822	Scottish Water Byelaws	UK Water Supply Regulations	Ü-Zeichen



CL.1 Wall valve anti-clockwise closing hot 1/2" - Chrome

CL.1

36 607 707 Product version up to 10/14/2020

Certificates and sustainability

DVGW_DW- 6501DN0	LGA_29	WRAS_2010	LGA_29	IAPMO_4976 (
EPD-DOR-20230287 -IBA1-EN Environmental.prod uct-declarat				

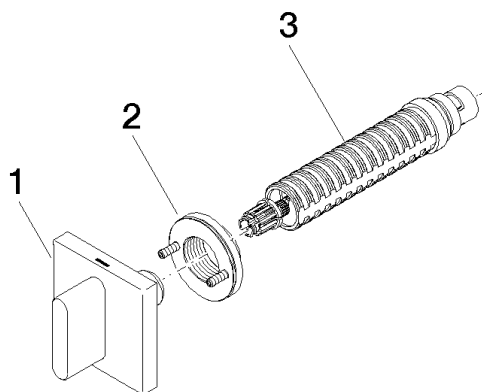

Spare parts list

No.	Item Number	Name	Quantity used	Delivery time
2	90 21 02 108 00 90	Wall disc complete -	1.00	14
3	90 90 03 142 00 90	Head part anti-clockwise closing 1/2" -	1.00	14
1	90 20 70 051 03-00	Handle for concealed wall mounting Hot oval pure 60 x 60 x 40 mm - Chrome	1.00	20