





36 212 705

- Drehumstellung
- Rosette 60 x 60 mm

Passt zu CL.1

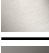
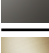

	Champagne (22kt Gold)	36 212 705-47
	Chrom	36 212 705-00
	Platin gebürstet	36 212 705-06
	Dark Chrome	36 212 705-19
	Champagne gebürstet (22kt Gold)	36 212 705-46
	Dark Platinum gebürstet	36 212 705-99

36 212 705

mm [inches]

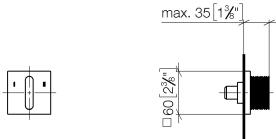

**Durchflussdiagramm**

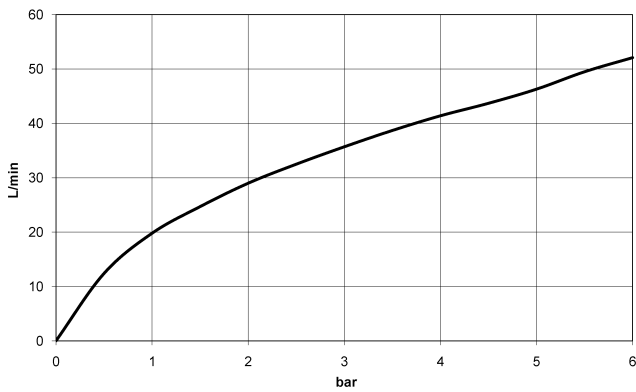

**Codes & Standards**

DIN 4109

ISO 3822

Scottish Water  
Byelaws

UK Water Supply  
Regulations

**Ü-Zeichen**



CL.1 UP-Dreiwege-Umstellung - Champagne (22kt Gold)

---

CL.1

36 212 705

Zertifikate

---

WRAS\_2307

LGA\_38

36 212 705

Ersatzteile für die  
anderen  
Oberflächenvarianten  
finden Sie hier:  
Chrom

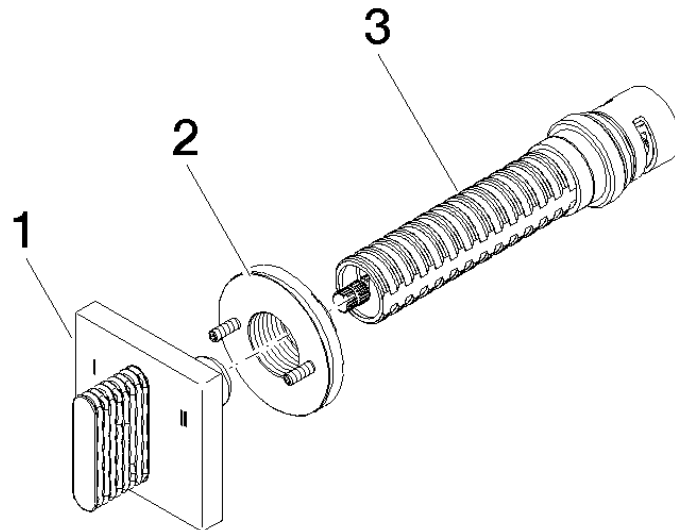



## CL.1 UP-Dreiwege-Umstellung - Champagne (22kt Gold)

CL.1

36 212 705

### Ersatzteilstückliste

Nr.	Artikelnummer	Benennung	Verbaumenge	Lieferzeit
	90 20 70 053 10-47	Griff - Champagne (22kt Gold)	3	30