

# Bridge Energy Control for smart meter interface

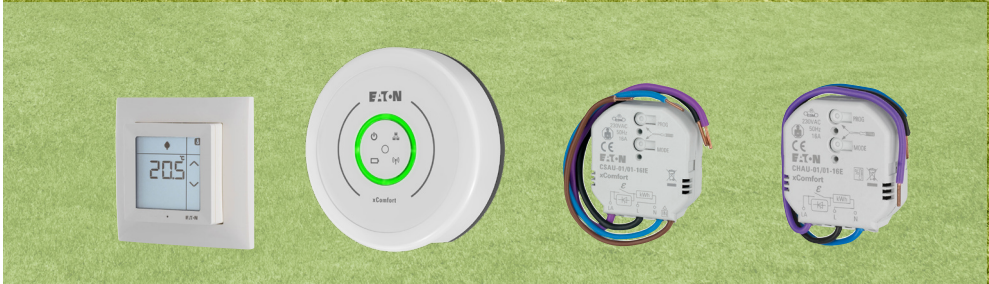

Powering Business Worldwide



## DISCLAIMER OF WARRANTIES AND LIMITATION OF LIABILITY

The information, recommendations, descriptions and safety notations in this document are based on Eaton Corporation's ("Eaton") experience and judgment and may not cover all contingencies. If further information is required, an Eaton sales office should be consulted. Sale of the product shown in this literature is subject to the terms and conditions outlined in appropriate Eaton selling policies or other contractual agreement between Eaton and the purchaser.

THERE ARE NO UNDERSTANDINGS, AGREEMENTS, WARRANTIES, EXPRESSED OR IMPLIED, INCLUDING WARRANTIES OF FITNESS FOR A PARTICULAR PURPOSE OR MERCHANTABILITY, OTHER THAN THOSE SPECIFICALLY SET OUT IN ANY EXISTING CONTRACT BETWEEN THE PARTIES. ANY SUCH CONTRACT STATES THE ENTIRE OBLIGATION OF EATON. THE CONTENTS OF THIS DOCUMENT SHALL NOT BECOME PART OF OR MODIFY ANY CONTRACT BETWEEN THE PARTIES.

In no event will Eaton be responsible to the purchaser or user in contract, in tort (including negligence), strict liability or other-wise for any special, indirect, incidental or consequential damage or loss whatsoever, including but not limited to damage or loss of use of equipment, plant or power system, cost of capital, loss of power, additional expenses in the use of existing power facilities, or claims against the purchaser or user by its customers resulting from the use of the information, recommendations and descriptions contained herein. The information contained in this manual is subject to change without notice.

- For additional languages and information about xComfort, visit [www.eaton.com/bridgeenergycontrol](http://www.eaton.com/bridgeenergycontrol) or use the QR-code.
- Für weitere Sprachen und Informationen zum xComfort System besuchen Sie [www.eaton.com/bridgeenergycontrol](http://www.eaton.com/bridgeenergycontrol) oder verwenden Sie den QR-code.
- Besøk [www.eaton.com/bridgeenergycontrol](http://www.eaton.com/bridgeenergycontrol) for andre språk og mer informasjon om xComfort eller bruk QR-koden.
- Pro další jazyky informace o xComfort návštěvy [www.eaton.com/bridgeenergycontrol](http://www.eaton.com/bridgeenergycontrol) nebo použijte QR kód.
- Voor andere talen en meer informatie over xComfort ga naar [www.eaton.com/bridgeenergycontrol](http://www.eaton.com/bridgeenergycontrol) of maak gebruik van de QR-code.



# Content overview

- 1. SMART METER INTERFACE PACKAGE..... 4**
- 2. INSTALLATION..... 5**
- 3. ADDING DEVICES IN THE BRIDGE..... 5**
- 4. SETTING UP ENERGY MONITORING AND CONTROL IN THE BRIDGE.....**
  - 4.1 Setting up monitoring of the Grid ..... 5
  - 4.2 Setting up monitoring of your home energy consumption ..... 5
  - 4.3 Setting up your tariff..... 6
  - 4.4 Setting up control of your electrical loads ..... 6
  - 4.5 Setting up control of your heating..... 6
  - 4.6 Setting up push notifications for maximum power consumption (kWh)..... 6
  - Notes ..... 7

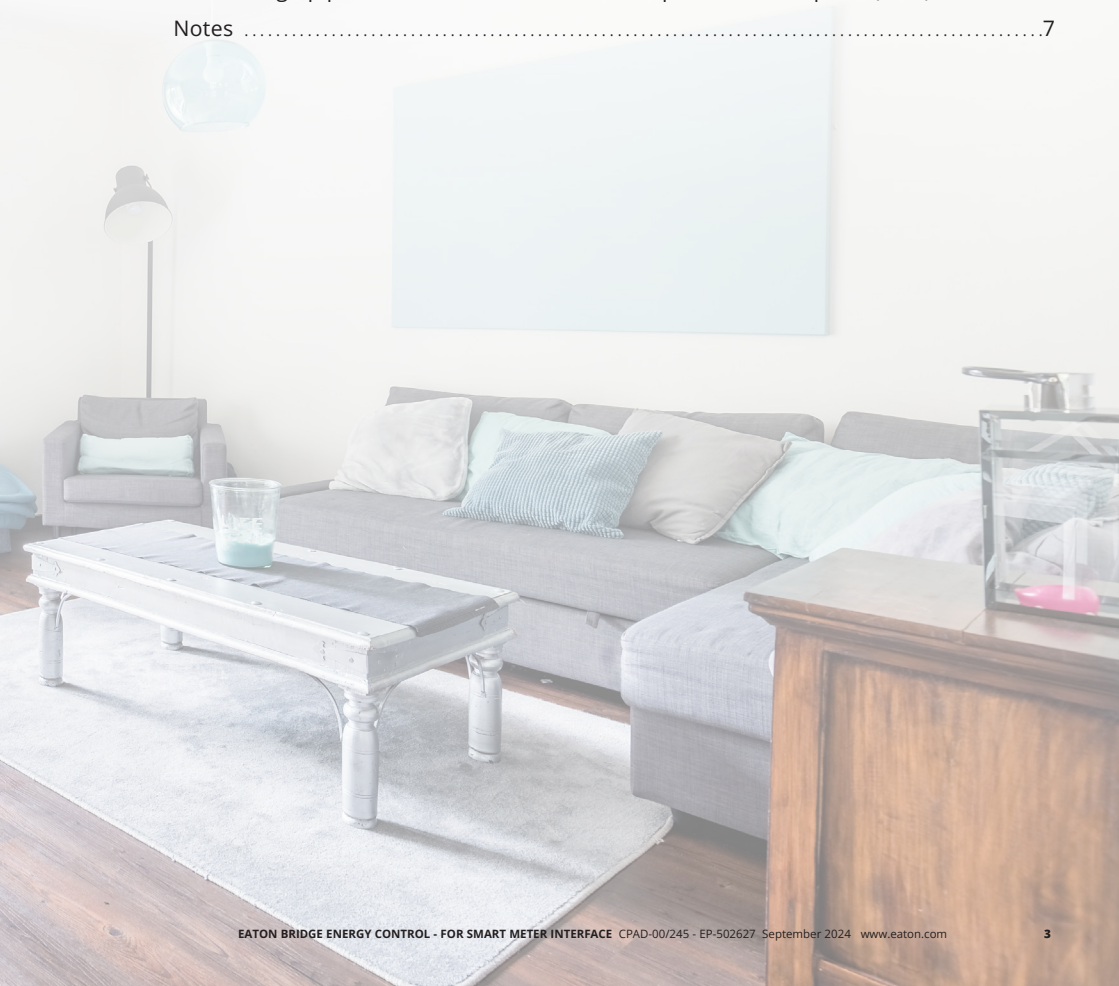



## 1. SMART METER INTERFACE PACKAGE

Bridge Energy Control extends the possibilities of your xComfort Bridge installations beyond classic control of lights, shading, indoor climate and loads by introducing load control based on electricity tariffs and monitoring of your home's total energy consumption through third party smart meter interface and xComfort actuators.

### What is in the box?



16 A heating actuator  
CHAU-01/01-16E



Room Controller Touch,  
complete, White, CPAD-00/198



xComfort Bridge  
CBCA-00/01



16 A switching actuator  
CSAU-01/01-16IE

### Control the energy based on the tariffs by

- Monitoring the grid and home energy consumption
- Controlling your heating
- Controlling your electrical loads
- Reading the tariffs

## 2. INSTALLATION

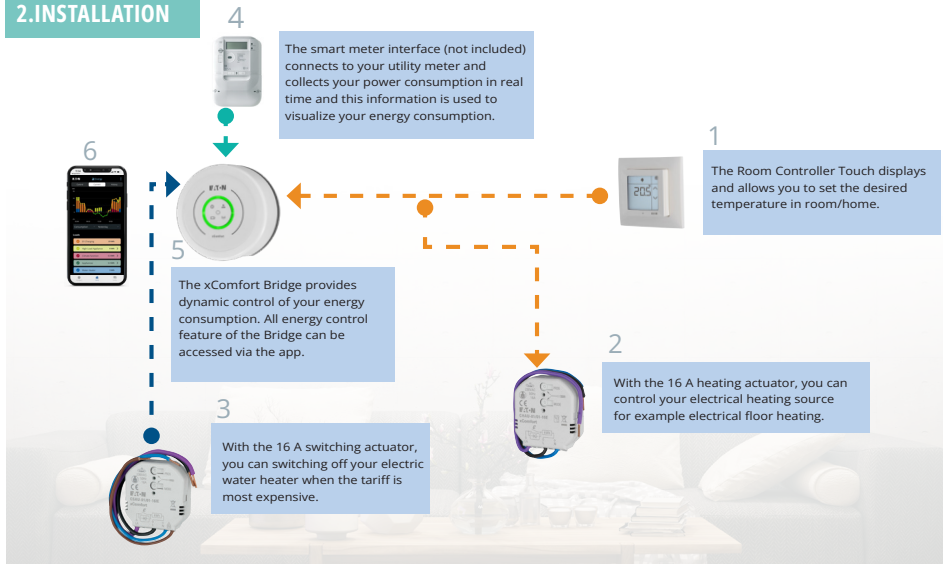

	Installation instructions	Used for
1. Room Controller Touch	For installation see IL	Controlling your heating
2. 16 A heating actuator	For installation see IL	Controlling your heating
3. 16 A switching actuator	For installation see IL	Switching your electrical loads
4. Smart Meter Interface (not included)	For installation see IL	Monitoring the grid energy consumption
5. xComfort Bridge	For installation see IL	Dynamic control of your energy consumption
6. Bridge App (iOS or Android)	To download app scan QR code	Visualization of your energy consumption



IOS



Android

### 3. ADDING DEVICES IN THE BRIDGE

To add devices 1, 2 and 3 to the Bridge follow these steps or scan QR code to watch video **How to connect the xComfort Actuators & Sensors to the xComfort Bridge?**



After adding a device, finalize its setup by performing the following actions:

**Name the device:** Give it a unique name for easy identification. (1, 2 and 3)

**Assign a room:** Specify the room where the device is located. (1, 2 and 3)

**Configure the device type:** The devices should be configured with any of the following usage type when used in energy control.

#### 16 A Switching actuator CSAU-01/01-16IE (3)

- Water heater, vehicle charger or high load appliances depending on the application
- Appliance when only energy monitoring is needed.

#### 16 A Heating actuator CHAU-01/01-16E (2)

- Heating, cooling or heating and cooling and cooling device type depending on the application.
- Finalize settings: Adjust its settings according to its functionalities and save.

### 4. SETTING UP ENERGY MONITORING AND CONTROL IN THE BRIDGE

#### 4.1 Setting up monitoring of the Grid

Once have installed your chosen metering device, it will need to be set up in the Bridge.

- Step 1:** Navigate to the **"Configure"** menu and select **"Energy Monitoring & Control"**.
- Step 2:** In the **integration section** select **"Energy Meters"** then select **"Setup Energy Meter"** if your meter is on the same Local Area Network (LAN) as the Bridge, it should be automatically discovered.

#### 4.2 Setting up monitoring of your home energy consumption

To monitor individual loads in your home, the following steps are required.

- Step 1:** Navigate to the **"Configure"** menu and select **"Energy Monitoring & Control"**.
- Step 2:** Select the devices and rooms you want to monitor. This includes options such as climate function, water heating, vehicle charger, high-load appliance, appliance, and main meter.
- Step 3:** To customize the three elements (**Combined Electric Energy, Combined Active Power, and Combined Costs**) on the current page, navigate to **"Quick View Settings"** and select a defined time range (last hour, today, current week, month, or year).

### 4.3 Setting up your tariff

To control the energy use based on the tariff, the applicable tariffs needs to be configured.

**Step 1:** Navigate to the **"Configure"** menu and select **"Energy Monitoring & Control"**.

**Step 2:** Choose **"Tariff Settings"**.

For more information refer to the Bridge help in the app.

By doing this, you can ensure that your defined loads are switched off when the tariffs are at their highest, thus using energy only when it's most affordable. Do not forget to save your settings after each step.

For more information on your tariff markup, please contact your energy provider.

### 4.4 Setting up control of your electrical loads

You can control various electrical loads such as your water heater/boiler, electric vehicle charger, and other high-load appliances. By selecting these options, you can ensure that these loads respond dynamically to changes in the tariff, helping you to save energy and reduce costs.

**Step 1:** Open the **"Configure"** menu.

**Step 2:** Choose **"Energy Monitoring & Control"**.

**Step 3:** In the **"Controlled Loads"** section, select the loads you wish to control.

### 4.5 Setting up control of your heating

You can control your home's heating based on predefined setpoints for heating modes. When the tariff is high, the heating switches to eco mode. Conversely, when the tariff is low, it switches to comfort mode for optimal warmth. This allows you to manage your energy costs without compromising comfort.

**Step 1:** Open the **"Configure"** menu and select **"Climate function"**.

**Step 2:** Choose the room you wish to control.

**Step 3:** Adjust the setpoints according to your preference.

**Step 4:** Return to the **"Configure"** menu and choose **"Energy Monitoring & Control"**.

**Step 5:** Under the **"Controlled Loads"** section, select the rooms for control.

### 4.6 Setting up push notifications for maximum power consumption (kWh)

To get notified when your consumption exceeds a threshold, use the smart scene feature.

**Step 1:** Open the **"Configure"** menu and select **"Scenes"**.

**Step 2:** Select the **"+"** to create a new scene.

**Step 3:** Name the scene and select **"Is a smart scene"**

**Step 4:** For condition type, select **"Power value"** and then choose **"main meter"** under Device / Energy meter.

**Step 5:** Set the operation condition to **"Greater Than"**, Device / Energy Meter to **"Fixed"**, and power value usage to **"Power consumption"**

**Step 6:** Enter the desired value, e.g., 10000 W, and save. (It's advisable to set this 10% lower than your desired maximum and a minimum time of 1 minute to avoid frequent push notifications.)

**Step 7:** In Triggered Devices and Actions, select the **"+"** to add a new action, choose **"Push notification"** from the list, edit it, change the type to **"Custom Push Note,"** and define the title and text.



Eaton is an intelligent power management company dedicated to protecting the environment and improving the quality of life for people everywhere. We make products for the data center, utility, industrial, commercial, machine building, residential, aerospace and mobility markets. We are guided by our commitment to do business right, to operate sustainably and to help our customers manage power - today and well into the future. By capitalizing on the global growth trends of electrification and digitalization, we're accelerating the planet's transition to renewable energy sources, helping to solve the world's most urgent power management challenges, and building a more sustainable society for people today and generations to come.

Eaton was founded in 1911 and has been listed on the New York Stock Exchange for more than a century. We reported revenues of \$23.2 billion in 2023 and serve customers in more than 160 countries. For more information, visit [www.eaton.com](http://www.eaton.com). Follow us on [LinkedIn](#).



To contact us please visit: [www.eaton.com/contacts](http://www.eaton.com/contacts)  
For technical questions please contact your local Eaton team

For more information, please visit:  
[eaton.com/bridgeenergycontrol](http://eaton.com/bridgeenergycontrol)



Eaton Industries (Austria) GmbH  
Scheidgasse 42  
1210 Vienna  
Austria

**Eaton**  
EMEA Headquarters  
Route de la Longeraie 7  
1110 Morges, Switzerland  
Eaton.com

©2024 Eaton  
All Rights Reserved  
Publication No. MND05002EN  
September 2024

Changes to the products, to the information contained in this document, and to prices are reserved; so are errors and omissions. Only order confirmations and technical documentation by Eaton is binding. Photos and pictures also do not warrant a specific layout or functionality. Their use in whatever form is subject to prior approval by Eaton. The same applies to Trademarks (especially Eaton, Moeller, and Cutler-Hammer). The Terms and Conditions of Eaton apply, as referenced on Eaton internet pages and Eaton order confirmations.

Eaton is a registered trademark.

All other trademarks are property of their respective owners.