

	(KSA) (UAE)	(KSA) (UAE)	(KSA) (UAE)		
X	13 348	13 440	13 096	13 442	13 043
Y	64 186	64 196	13 928	13 954	13 954

*19 017		13mm	
*40 684		60-75	

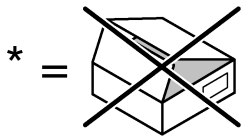



DIN EN 806
DIN EN 1717
DIN 1988



bar
max. 10
0,5 5 1

°C
max. 70°
60°

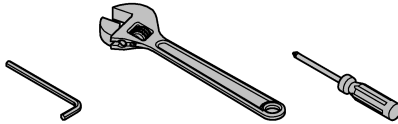
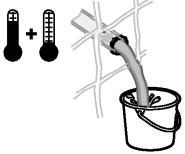

13mm
*19 017

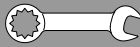

1

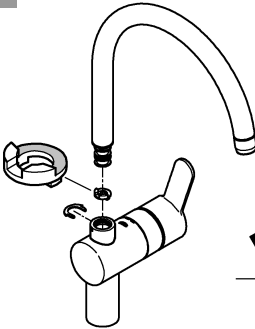

	150°
	0°
	360°

2

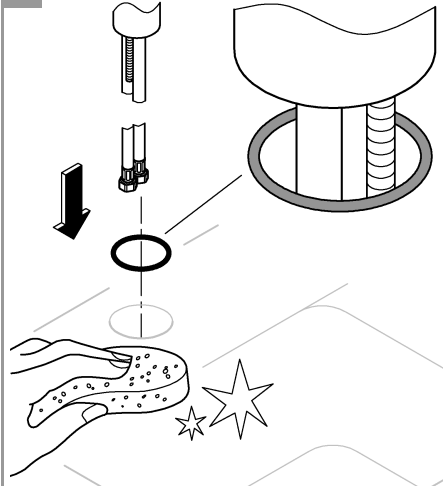

≥75

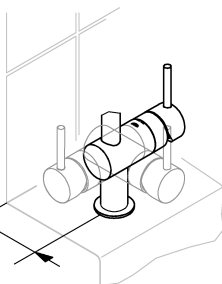

60-75

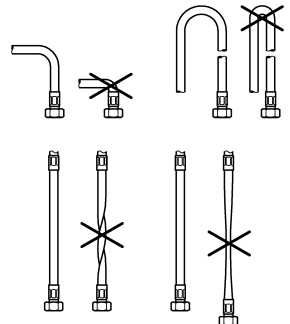
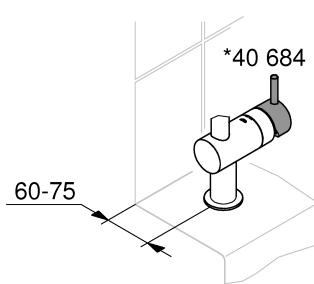



3

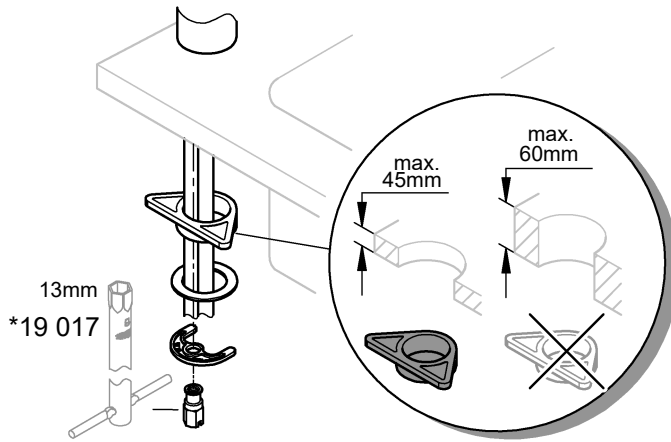

4

