

FOR RECYCLING PURPOSES ONLY

Disassembly Instructions

Change-over switches OT315–400_C

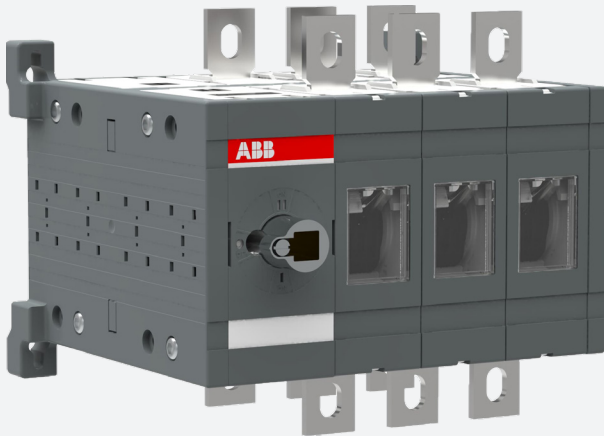

Table of contents

003	Important information
004–005	Disassembly of the change-over switch
006–007	Disassembly of the pole
008	Disassembly of the mechanism
009–010	Component list
011	Recycling information in accordance with the WEEE

Important information

This document shows the disassembly process of OT315-400_C change-over switches. Accessories, such as shafts, clamps, shrouds, neutral links and auxiliary contacts are not included. **Note! This document is for recycling purposes only.**

Safety Notes

Before starting the disassembly process it is mandatory to put the change-over switch in open position.

Disassembly of change-over switches must be performed by qualified and skilled personnel in the electrical field (IEV 195-04-01: person with relevant education and experience to enable him or her to perceive risks and to avoid hazards which electricity can create) and having a detailed knowledge of change-over switches.

Disassembly must be done in an ergonomic workspace which can ensure the protection of the person doing the disassembling.

Applicable national legislation and international standards in force at the time of the disassembly of the change-over switches must be taken into account in addition to the prescriptions illustrated in this document.

ABB declines any responsibility for injury to people or damage to property resulting from a failure to comply with the instructions set out in this document and with any applicable safety standard.

Personal Protective Equipment (PPE)

When doing the disassembling following safety Personal Protective Equipment (PPE) must be worn:

Glasses



Gloves



Safety shoes



Protective clothes



Tools

The disassembly process requires the use of tools (e.g. screwdriver, torx key, pliers). Tools to be used are specified inside each phase of the disassembly process.

Disassembly process

For each phase of the disassembly process the following information is provided:

- Part/parts to be disassembled (title of the phase)
- Tools to be used
- Description of actions to be performed
- Pictures showing actions to be performed
- List, quantity and picture of disassembled parts with an indication about separate treatment (when applicable)
- In case of potential hazards signal below is reported:



Disassembly of the change-over switch

Phase 1 & 2 – End plates and switch-disconnectors

1. Use a torx key (size 25) to unscrew the 8 screws fixing the end plates to the switch-disconnectors.

2. Separate the switch-disconnectors, interm covers and contact guide supports from each other manually.

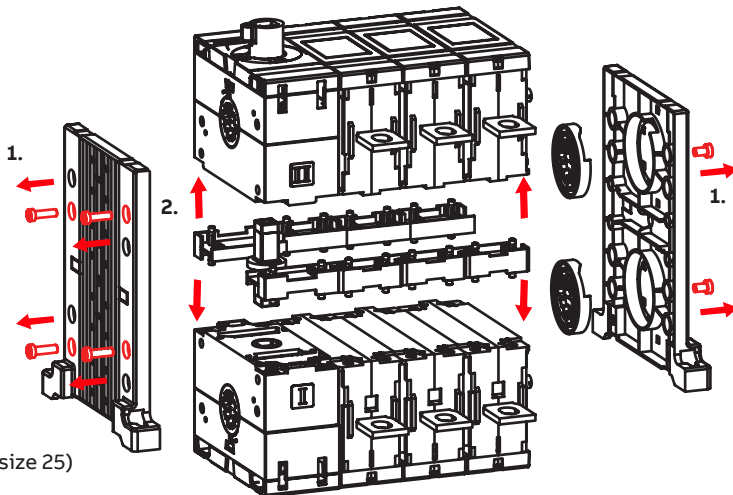

Tools

Torx key (size 25)

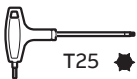

Disassembled parts

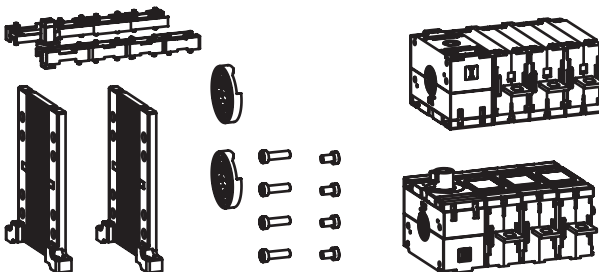

- 4 screws
- 4 screws
- 2 end plates
- 2 contact guide supports
- 1 connecting part 6 poles
- 2 interm covers
- 6-8 interm covers
- 2 switch-disconnectors

Phase 3 – Stud screws

Use a flat screwdriver to unscrew the stud screws fixing the poles to the mechanism.

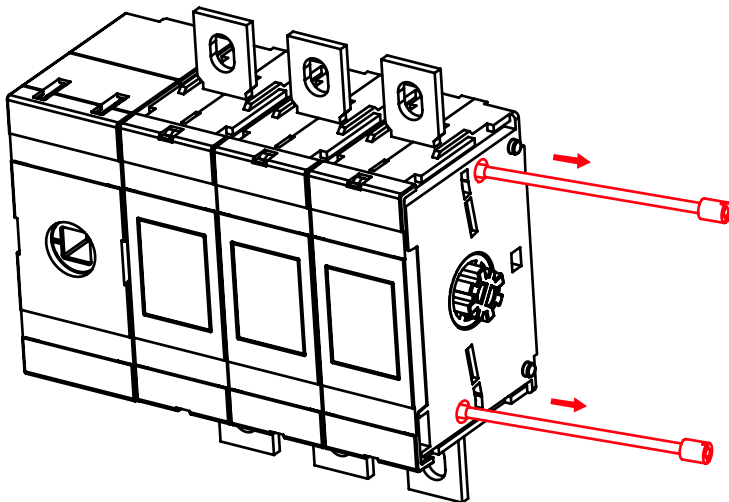

Tools

Flat screwdriver

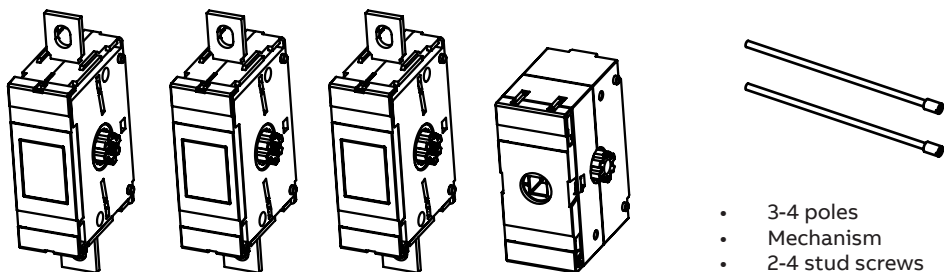

Disassembled parts

- 3-4 poles
- Mechanism
- 2-4 stud screws

Disassembly of the pole

Phase 1 & 2 – Cover, frames and inner parts

1. Use a flat screwdriver to remove the cover.

2. Separate the frames and remove contact construction, arc plates, fixed contacts and window manually.

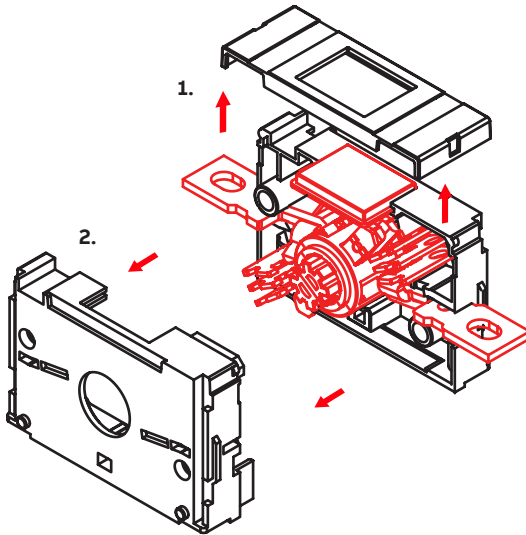

Tools

Flat screwdriver



Disassembled parts

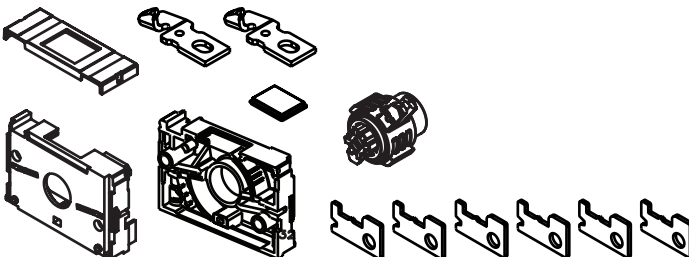

- Frame A
- Frame B
- Contact construction
- 2 fixed contacts
- 6 arc plates
- Cover
- Window

Phase 3 & 4 – Contact construction

3. Remove the knife structure from the roll manually.

4. Remove the spring guide and separate contact knives, contact springs and contact irons from each other manually.

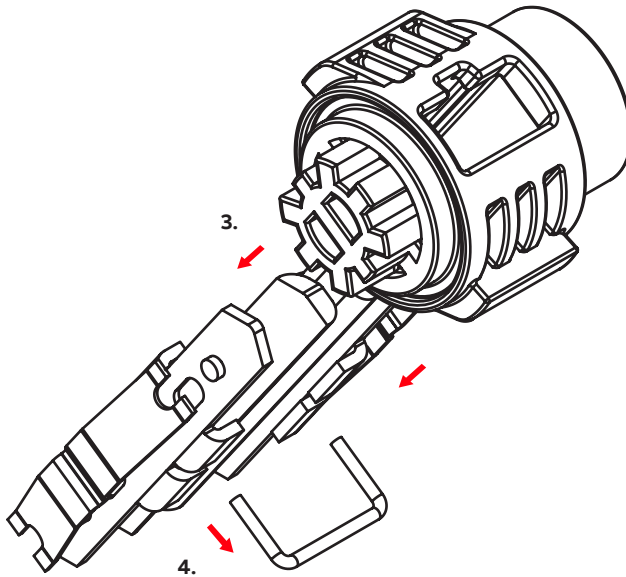

Disassembled parts

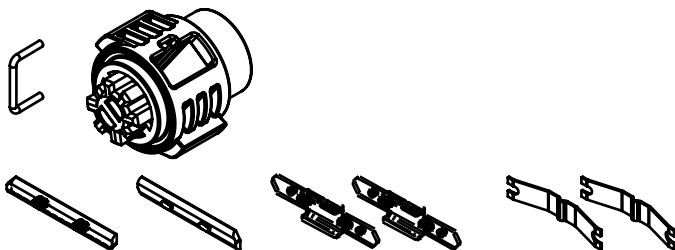

- Roll
- 1 contact knife
- 1 contact knife
- 2 contact irons
- 2 contact springs
- 1 spring guide

Disassembly of the mechanism

1. Remove the cover with the help of a flat screwdriver.

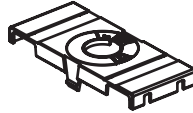

2. Unscrew the 4 screws with a torx key to remove the upper frame. Remove contact guide support and two steel nuts manually.

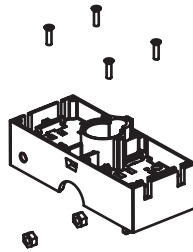

3. Remove the lever.

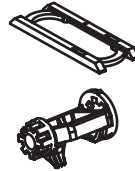

4. Remove pipeshaft, lever and rhythm spring.



5. Remove the springs using pliers. Remove the two steel nuts manually.

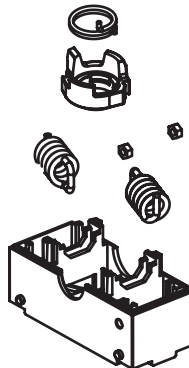

Tools

Torx key (size 8)

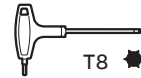

Flat screwdriver



Pliers



Disassembled parts

- Frame
- 2 springs
- 4 steel hex nuts
- Lever
- Pipeshaft
- Lever
- Rhythm spring
- Frame
- 4 screws
- Cover
- Contact guide support



Note! Pay special attention to tensioned springs. Use personal protective equipment.

Component list

Change-over switch OT315-400_C

Component name	Quantity	Material(s)	Weight (g/pc)
OT315-400_C1	1	See component list below	2231,5
OT315-400_C2	1	See component list below	2365,1
Connecting part 6 poles	1	Zinc alloy	54,6
Interm cover	2	Polycarbonate	6,5
Interm cover	6-8	Polycarbonate	5,5
End plate	2	Polyamide	100,4
Contact guide support	2	Polyamide	7,8
Screw	4	Steel	2,6
Screw	4	Steel	4,1
Lock spring	1	Steel	0,2
Slot screw	1	Steel	1,3
Spring washer	1	Steel	0,2
O-ring	1	Rubber	0,0
Address plate	1	Polyest-resin	0,0

Switch-disconnector OT315-400_C1

Component name	Quantity	Material(s)	Weight (g/pc)
Mechanism	1	See component list	448,2
Pole	3-4	See component list	582,6
Stud screw	2-4	Steel	10,0-25,0

Switch-disconnector OT315-400_C2

Component name	Quantity	Material(s)	Weight (g/pc)
Mechanism	1	See component list	581,8
Pole	3-4	See component list	582,6
Stud screw	2-4	Steel	10,0-25,0

—
Pole

Component name	Quantity/pole	Material(s)	Weight (g/pc)
Frame A	1	Polyest-resin	148,3
Frame B	1	Polyest-resin	166,4
Contact knife	1	Copper	23,8
Contact knife	1	Copper	23,8
Contact iron	2	Steel	17,7
Contact spring	2	Chromium steel	3,4
Spring guide	1	Chromium steel	1,0
Roll	1	Polyest-resin	35,0
Arc plate	6	Steel	8,0
Fixed contact	2	Copper	57,3
Window	1	Polycarbonate	3,960
Cover	1	Polycarbonate	10,8

—
Mechanism

Component name	Quantity	Material(s)	Weight (g/pc)
Frame	1	Polyamide	114,5
Frame	1	Polyamide	67,5
Cover	1	Polycarbonate	15,7
Pipeshaft	1	Zinc alloy	12,7
Lever	1	Zinc alloy	71,6
Lever	1	Zinc alloy	89,6
Spring	2	Steel	29,5
Rhythm spring	1	Chromium steel	7,8
Steel hex nut	4	Steel	1,5
Screw	4	Chromium steel	1,0

Recycling information in accordance with the WEEE

The product is marked with the wheelie bin symbol. It indicates that at the end of life the product should enter the recycling system.

You should dispose of it separately at an appropriate collection point and not place it in the normal waste stream.

The figure below shows the wheelie bin symbol indicating separate collection for electrical and electronic equipment (EEE).



The horizontal bar underneath the crossed-out wheelie bin indicates that the equipment has been manufactured after the Directive came into force in 2005.

The wheelie bin symbol is added to the type designation label of the product since 2017.



Contact us

ABB Oy

P.O. Box 622
FI-65101 Vaasa
Finland

abb.com/lowvoltage