

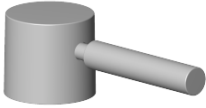









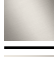





**Handle Lever for washstand deck mounting 52 x 35 x 117 mm - Brushed
Bronze (PVD)**

SPARE PARTS

90 20 66 003 00 Product version from 4/1/2025



	Brushed Bronze (PVD)	90 20 66 003 00-42
	Chrome	90 20 66 003 00-00
	Brushed Platinum	90 20 66 003 00-06
	Platinum	90 20 66 003 00-08
	Durabronze (23kt Gold)	90 20 66 003 00-09
	Dark Chrome	90 20 66 003 00-19
	Light Gold (PVD)	90 20 66 003 00-26
	Brushed Light Gold (PVD)	90 20 66 003 00-27
	Brushed Durabronze (23kt Gold)	90 20 66 003 00-28
	Matte Black	90 20 66 003 00-33
	Brushed Gold (PVD)	90 20 66 003 00-37
	Brushed Dark Brass (PVD)	90 20 66 003 00-39
	Brushed Dark Bronze (PVD)	90 20 66 003 00-43
	Brushed Champagne (22kt Gold)	90 20 66 003 00-46
	Champagne (22kt Gold)	90 20 66 003 00-47
	Brushed Chrome	90 20 66 003 00-93
	Brushed Dark Platinum	90 20 66 003 00-99



Handle Lever for washstand deck mounting 52 x 35 x 117 mm - Brushed
Bronze (PVD)

SPARE PARTS

90 20 66 003 00 Product version from 4/1/2025



Handle Lever for washstand deck mounting 52 x 35 x 117 mm - Brushed
Bronze (PVD)

SPARE PARTS

90 20 66 003 00 Product version from 4/1/2025

**Handle Lever for washstand deck mounting 52 x 35 x 117 mm - Brushed
Bronze (PVD)**

SPARE PARTS

90 20 66 003 00 Product version from 4/1/2025

Parts for other
finishes can be found
here: [Chrome](#)

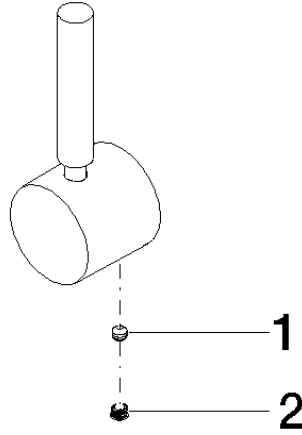

Spare parts list

No.	Item Number	Name	Quantity used	Delivery time
2	90 31 20 109 00 90	Plug -	1.00	14
1	90 31 11 063 00 90	Mounting Threaded pin with hexagon socket with cup point M5 x 4 mm -	1.00	14