

TRONIX

Waterproof lightbar

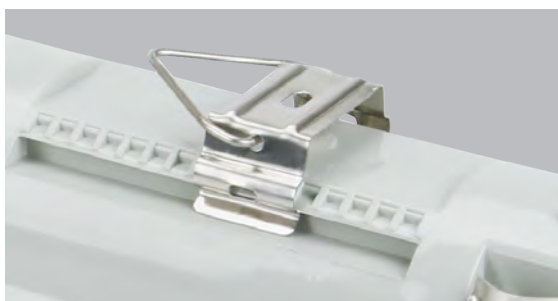

Introduction



This water-proof LED light is an ideal alternative to fluorescent lamps. It adopts high lumen SMD light source and high transmittance PC cover, prism design for lamp shade . which make a uniform and soft light output. With stainless steel buckle for easily assembly and disassembly. It can be widely used in various application, surface mounted and pendant installation optional.

Features

- 6063 aluminum heat sink provides excellent thermal management
- High lumen efficiency of 130Lm/W
- IP65 IK08 high protection level
- Surface mounted and pendant installation

Application notes

- IP65 for in and outdoor use
- Professional electrician for installation only
- Switch off before installation
- Do not touch when in use
- Keep away from hot steam and corrosive gas

Application Areas

Tri-proof LED light can be used in factory, warehouse, workshop, and other lighting area with high humidity and dusty places .

Certificate

CE RoHS SAA

Product Information

Technical Specifications

Code No.	950-080 Single	950-081 Twin	950-082 Single	950-083 Twin	950-084 Single	950-085 Twin
Dimension(mm)	660*90*90	664*140*90	1274*90*90	1274*140*90	1574*90*90	1574*140*90
Watt(W)	10W	19W	19W	38W	38W	57W
Rated Input Voltage(V)	AC230V					
Input Voltage(V)	AC200V-240V					
LED Module Input	DC24-29V	DC44-52V	DC44-52V	DC44-52V	DC44-52V	DC44-52V
Light Source	SMD					
SDCM	<6					
CCT(K)	5000K					
CCT Selection DIP Switch	NO					
Luminous Flux (lm) ±5%	1300	2470	2470	4940	4940	7410
CRI	≥80					
Beam Angle (°)	120°					
UGR	-					
LED Driver	Built-in					
Dimming Option	NO					
Emergency Kits	NO					
Electrical Class	Class I					
Ingress Protection (IP Rating)	IP65					
Impact Resistance (IK Rating)	IK08					
Product Finishing(Base)	Grey					
Materials of Optics	PC					
Materials of Housing	PC					
Lifetime (hr)	30000h					
Glow wire test ()	750					
Operating Temp. ()	-20 ~45					
Storage Temp. ()	-20 ~65					
Installation	Suspended/Surface Mounted					



Measurement

Code	Dimension(mm)				Size(mm)	Product Weight (Kg)		Package weight (Kg)		Carton Size(cm)	Qty/ CTN
	L	W	H	LF		N.W/PC	G.W/PC	N.W/CTN	G.W/CTN		
950-080	664	90	90	350	660*90*90	0.9	1.08	10.8	13.0	68.5*39.5*30	12PCS
950-081	664	140	90	350	664*140*90	1.16	1.41	10.44	12.7	68.5*45*30	9PCS
950-082	1274	90	90	900	1274*90*90	1.62	1.96	14.58	17.66	129.5*30*30	9PCS
950-083	1274	140	90	900	1274*140*90	2.26	2.69	13.56	16.12	129.5*45*20.5	6PCS
950-084	1574	90	90	1200	1574*90*90	1.96	2.4	17.64	21.6	159.5*30*30	9PCS
950-085	1574	140	90	1200	1574*140*90	2.65	3.25	15.9	19.52	159.5*45*20.5	6PCS

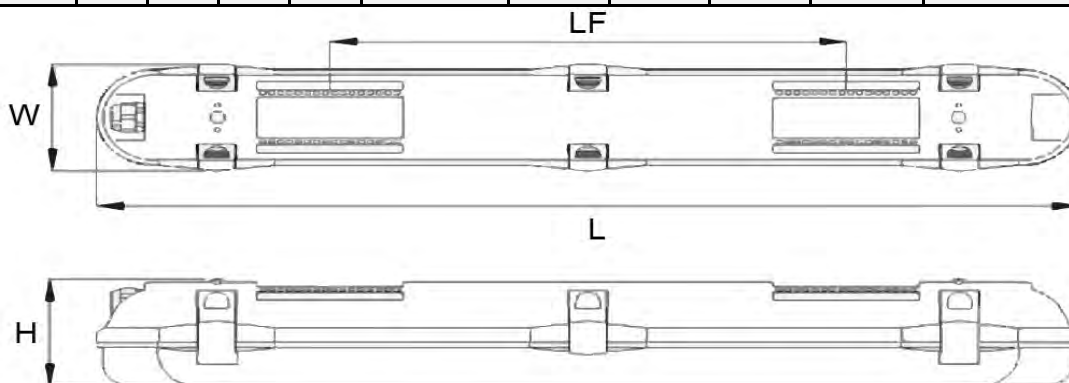

Driver data Sheet

Brand: Tridonic		10W	19W	38W	57W	75W
Output	Output Voltage range	DC14-29V	DC27-54V	DC27-54V	DC27-54V	DC27-54
	Rated output current	350mA	350mA	700mA	1050mA	1400mA
	Line Regulation	±5%				
	Setup, Rise Time	≤0.5S				
	Flickering Index	<1%				
Input	Input Voltage	AC200-240V				
	Rated Input Voltage(V)	AC230V				
	Frequency	50/60Hz				
	Input Current	0.06A	0.1A	0.2A	0.3A	0.4A
	Rated Input Current	0.08A	0.1A	0.2A	0.3A	0.4A
	Power Factor	0.9				
	THD	<20% @230V				
	Efficiency	80%	86%	87%	88%	90%
No load wattage	<1W					
Protection	Short circuit protection	Pass				
	Over voltage protection	Pass				
	Over temperature protection	Pass				
Safety & EMC	Withstand voltage	I/P-O/P:3.75KVac,<5mA 60S; I/P-FG:1.6KVac,<5mA 60S; O/P-FG:0.5KVac,<5mA 60S				
	Isolation Resistance	I/P-O/P: 500VDC, ≥100M Ω (Lamp test)				
	Surge	LN:0.5KV/LN-PE:1KV		IEC61000-4-5(L-N:1KV, L/N-PE:2KV)		
	EMC Emission	EN55015, EN61000-3-2				
	EMC Immunity	EN61000-4-2,3,4,5,6,8,11; EN61547				

Installation

Surface Mounted Installation

1. Open the lamp by screw driver, take out the accessory pack from the lamp

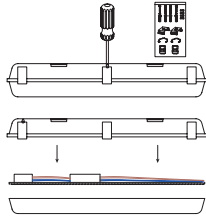

2. Cut off the power, fix the mounting brackets on the ceiling.

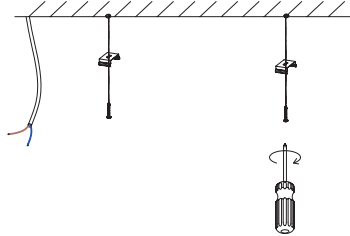

3. (a) Connect the AC cables to the terminal block (inside wire 1-2.5mm²);
(b) Protect the PCB from being damaged in the whole installation process.

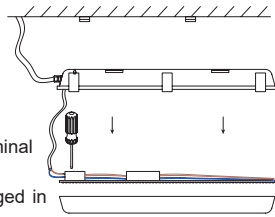

4. Assemble the lamp

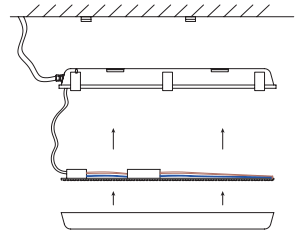

5. Lock the lamp fixture with screws.

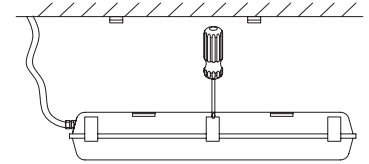

6. Firmly attach the lamp to the mounting bracket

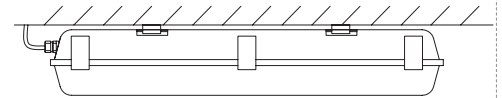

Suspended Installation (with 950-090)

1. Open the lamp by screw driver, take out the accessory pack from the lamp

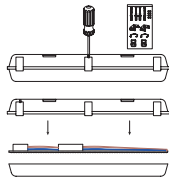

2. Cut off the power, fix the holders of suspending ropes on the ceiling

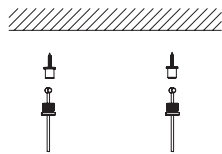

3. (a) Connect the AC cables to the terminal block (inside wire 1-2.5mm²);
(b) Protect the PCB from being damaged in the whole installation process.

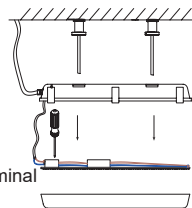

4. Assemble the lamp

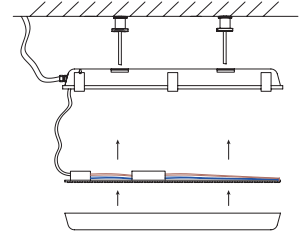

5. Lock the lamp fixture with screws, fix the mounting brackets on the back of the lamp

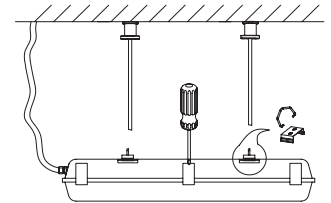

6. Connect the suspending ropes to the lamp

