

Exhaust Air Valve Metal Clips

EAV-C



Specifications

- Item code: EAV-C
- Good adjustment options
- Low noise level
- Quick and easy to install
- Airflow easy to measure
- Available sizes in mm: 80, 100, 125, 160, 200

Description

This valve is equipped with clamping springs and can be mounted in a recess or pipe. This return air valve is suitable for the exhaust of ventilation air. Also the valve is adjustable for the desired air volume and finished in RAL 9010 as a standard. This model is the successor a previous type (DVSER) and offers the same high quality.

Dimensions

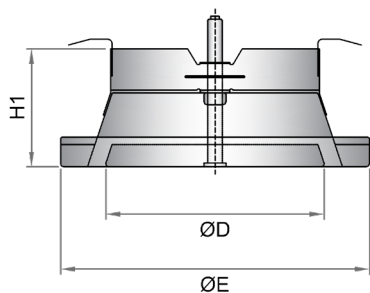

Dimensions

Model	H1 (mm)	ØD (mm)	ØE (mm)
EAV-C80	56	60	108
EAV-C100	56	79	135
EAV-C125	56	102	160
EAV-C160	56	140	195
EAV-C200	56	175	230

Properties

EAV-C80

m³/h	dB(A)	PA
25	10	10
50	30	40
75	N/A	N/A
100	N/A	N/A
125	N/A	N/A

EAV-C100

m³/h	dB(A)	PA
25	<10	<10
50	15	15
75	26	36
100	28	63
125	40	100

EAV-C125

m³/h	dB(A)	PA
50	<10	11
75	16	26
100	25	40
125	30	60
150	38	100

EAV-C160

m³/h	dB(A)	PA
75	<10	10
100	12	17
125	20	25
150	24	41
200	32	70

EAV-C200

m³/h	dB(A)	PA
200	30	50
250	34	71
300	42	100