

Walraven starQuick® Duo Wall Plate

(C0520)

for use with Walraven starQuick®

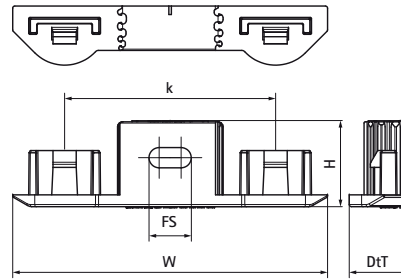

Features & benefits

- for fixing of two pipes with Walraven starQuick® clamps
- suitable for Walraven starQuick® dimensions up to 20mm
- the distance between the pipe and the wall is equal to that of a single clip
- material: modified PA6 (polyamide), grey or white
- resistant to UV, ageing, oil and petrol
- no corrosion, recyclable, halogen free
- temperature resistance from approx. -40 °C to approx. +90 °C (constant); short to approx. +130 °C
- 0854300 supplied with a hammer-in screw

Product Number	Total Width x Total Height x Total Depth	Fixing Slot	Heart To Heart Distance	Colour	Maximum Allowed Load $F_{a,z}$
Reference letter	$W \times H \times DtT$	FS	k		$F_{a,z}$
Unit description	$mm \times mm \times mm$	mm	mm		N
0854000	75 x 20 x 14	10x4,8	50	Grey	600
0855000	75 x 20 x 14	10x4,8	50	White	600