

Walraven starQuick® Duo Wall Plate with Hammer-in Screw

(C0521)

for use with Walraven starQuick®

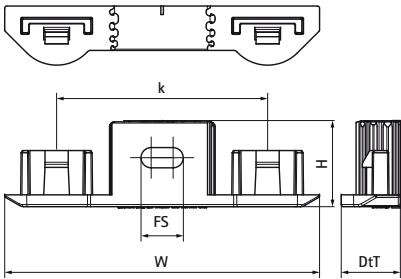

Features & benefits

- for fixing of two pipes with Walraven starQuick® clamps
- suitable for Walraven starQuick® dimensions up to 20mm
- the distance between the pipe and the wall is equal to that of a single clip
- material: screw made of steel, plug made of PA (polyamide), grey
- suitable for fixing to concrete, aerated concrete, brick
- temperature resistance from approx. -40 °C to approx. +90 °C (constant); short to approx. +130 °C

Product Number	Total Width	Total Height	Total Length	Total Depth
Reference letter	W	H	L	DtT
Unit description	mm	mm	mm	mm
0854300	75	20	14	14