

Walraven Stainless Steel Wall Plate CO₂ Welded

(M6507)

fixing to wall or ceiling

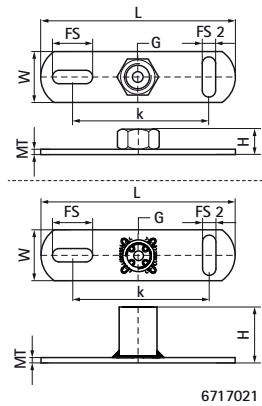

Features & benefits

- fixings to wall, ceiling or floor (tension and bending loads allowed)
- slots at 90° to each other to simplify fixing
- material: stainless steel A4 (1.4401 / AISI 316)

| Product Number | Connection Thread | Total Length | Total Width | Total Height | Material Thickness | Fixing Slot | Fixing Slot 2 | Heart To Heart Distance | Maximum Allowed Load Faz |
|-------------------------|-------------------|--------------|-------------|--------------|--------------------|-------------|---------------|-------------------------|--------------------------|
| <i>Reference letter</i> | <i>G</i> | <i>L</i> | <i>W</i> | <i>H</i> | <i>MT</i> | <i>FS</i> | <i>FS 2</i> | <i>k</i> | <i>F_{a,z}</i> |
| <i>Unit description</i> | | <i>mm</i> | <i>mm</i> | <i>mm</i> | <i>mm</i> | <i>mm</i> | <i>mm</i> | <i>mm</i> | <i>N</i> |
| 6717010 | M10 | 145 | 35 | 11 | 3.00 | 30x11 | 25x11 | 100 | 3,000 |
| 6717012 | M12 | 145 | 35 | 13 | 3.00 | 30x11 | 25x11 | 100 | 3,500 |
| 6717016 | M16 | 145 | 35 | 16 | 3.00 | 30x11 | 25x11 | 100 | 3,500 |
| 6717021 | G½" | 145 | 35 | 37 | 3.00 | 30x11 | 25x11 | 100 | 3,000 |