

Walraven Stainless Steel Wall Plate CO₂ Welded

(M6507)

fixing to wall or ceiling

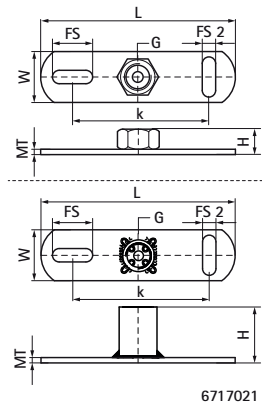

Features & benefits

- fixings to wall, ceiling or floor (tension and bending loads allowed)
- slots at 90° to each other to simplify fixing
- material: stainless steel A4 (1.4401 / AISI 316)

Product Number	VVS Number	Connection Thread	Total Length	Total Width	Total Height	Material Thickness	Fixing Slot	Fixing Slot 2	Heart To Heart Distance	Maximum Allowed Load Faz
<i>Reference letter</i>		<i>G</i>	<i>L</i>	<i>W</i>	<i>H</i>	<i>MT</i>	<i>FS</i>	<i>FS 2</i>	<i>k</i>	<i>Fa,z</i>
<i>Unit description</i>			<i>mm</i>	<i>mm</i>	<i>mm</i>	<i>mm</i>	<i>mm</i>	<i>mm</i>	<i>mm</i>	<i>N</i>
6717010	018056110	M10	145	35	11	3.00	30x11	25x11	100	3,000
6717012		M12	145	35	13	3.00	30x11	25x11	100	3,500
6717016		M16	145	35	16	3.00	30x11	25x11	100	3,500
6717021	018056104	G½"	145	35	37	3.00	30x11	25x11	100	3,000