

Handle Lever 30 x 40 x 95 mm - Brushed Bronze (PVD)

SPARE PARTS

90 20 78 040 00 Product version from 3/6/2019

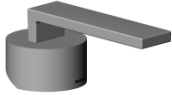

	Brushed Bronze (PVD)	90 20 78 040 00-42
	Chrome	90 20 78 040 00-00
	Brushed Platinum	90 20 78 040 00-06
	Platinum	90 20 78 040 00-08
	Dark Chrome	90 20 78 040 00-19
	Brushed Durabronze (23kt Gold)	90 20 78 040 00-28
	Brushed Champagne (22kt Gold)	90 20 78 040 00-46
	Champagne (22kt Gold)	90 20 78 040 00-47
	Brushed Dark Platinum	90 20 78 040 00-99



Handle Lever 30 x 40 x 95 mm - Brushed Bronze (PVD)

SPARE PARTS

90 20 78 040 00 Product version from 3/6/2019



Handle Lever 30 x 40 x 95 mm - Brushed Bronze (PVD)

SPARE PARTS

90 20 78 040 00 Product version from 3/6/2019

90 20 78 040 00 Product version from 3/6/2019

Parts for other finishes can be found here: [Chrome](#)

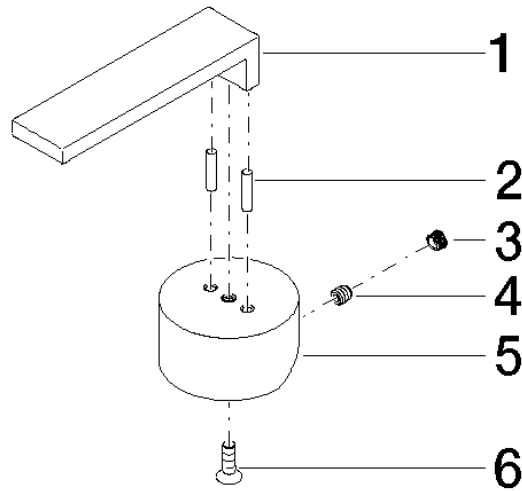

Spare parts list

No.	Item Number	Name	Quantity used	Delivery time
5	09 20 78 040-42	Handle Lever 43 x 23,5 x 43 mm - Brushed Bronze (PVD)	1.00	82
2	09 31 11 109 90	Straight pin Ø 6 x 14 mm -	2.00	14
1	09 20 78 010-42	Handle Lever 86 x 18 x 22,5 mm - Brushed Bronze (PVD)	1.00	82
6	90 30 30 124 00 90	Mounting Countersunk screw with hexagon socket M4 x 10 mm -	1.00	14
4	90 31 11 030 00 90	Mounting Threaded pin with hexagon socket with cup point M5 x 5 mm -	1.00	14
3	90 31 20 109 00 90	Plug -	1.00	14