

Dispenser Pump head, complete Installation variant without rosette - Matte Black

SPARE PARTS

90 10 10 539 00 Product version from 4/1/2025



	Matte Black	90 10 10 539 00-33
	Chrome	90 10 10 539 00-00
	Brushed Platinum	90 10 10 539 00-06
	Platinum	90 10 10 539 00-08
	Matte White	90 10 10 539 00-10
	Dark Chrome	90 10 10 539 00-19
	Brushed Light Gold (PVD)	90 10 10 539 00-27
	Brushed Durabronze (23kt Gold)	90 10 10 539 00-28
	Brushed Bronze (PVD)	90 10 10 539 00-42
	Brushed Champagne (22kt Gold)	90 10 10 539 00-46
	Champagne (22kt Gold)	90 10 10 539 00-47
	Brushed Chrome	90 10 10 539 00-93
	Brushed Dark Platinum	90 10 10 539 00-99



Dispenser Pump head, complete Installation variant without rosette - Matte
Black

SPARE PARTS

90 10 10 539 00 Product version from 4/1/2025



Dispenser Pump head, complete Installation variant without rosette - Matte
Black

SPARE PARTS

90 10 10 539 00 Product version from 4/1/2025

90 10 10 539 00 Product version from 4/1/2025

Parts for other finishes can be found here: [Chrome](#)

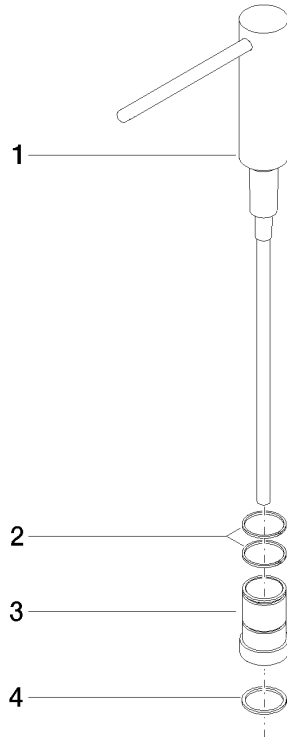

Spare parts list

No.	Item Number	Name	Quantity used	Delivery time
2	09 14 15 014 90	Ring Ø 27,1 x Ø 24,4 x 1,5 mm -	2.00	14
3	08 10 10 539-33	Retainer for lotion dispenser Integrated with rosette Ø 30 x 38 mm - Matte Black	1.00	40
4	08 10 10 620 90	Disc Ø 27,5 x 23,5 x 1,5 mm -	1.00	14
1	90 10 10 534 00-33	Dispenser Pump head, complete Installation variant - Matte Black	1.00	40