

MEM Wall-mounted basin mixer without pop-up waste - Chrome

MEM

36 712 782 Product version from 3/10/2014 to 10/27/2020



- 200mm projection
- fixed spout
- rectangular, air-enriched flow
- hole diameter valve 35 mm
- hole diameter spout 35 mm
- individual rosettes 60 x 60 mm
- max. flow 5.7 l/min
- lead-free
- This product can help a building meet the requirements of Green Building Rating Systems, e.g. LEED®, BREEAM®, DGNB
- WRAS

	Chrome	36 712 782-00
	Brushed Platinum	36 712 782-06
	Platinum	36 712 782-08
	Dark Chrome	36 712 782-19
	Brushed Light Gold (PVD)	36 712 782-27
	Brushed Durabrass (23kt Gold)	36 712 782-28
	Brushed Gold (PVD)	36 712 782-37
	Brushed Dark Brass (PVD)	36 712 782-39
	Brushed Bronze (PVD)	36 712 782-42
	Brushed Dark Bronze (PVD)	36 712 782-43
	Brushed Champagne (22kt Gold)	36 712 782-46
	Champagne (22kt Gold)	36 712 782-47
	Brushed Dark Platinum	36 712 782-99

Required miscellaneous



Concealed wall-mounted mixer centred spout - 35 700 970 90

- min. recess depth 110 mm
- max. recess depth 150 mm

Required miscellaneous



Concealed wall-mounted mixer variable positioning - 35 720 970 90

- min. recess depth 110 mm
- max. recess depth 150 mm

36 712 782 Product version from 3/10/2014 to 10/27/2020

mm [inches]

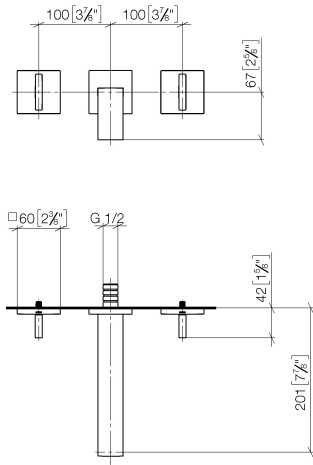

Flow rate chart



Codes & Standards

DIN 4109

EN 200

ISO 3822

Scottish Water
Byelaws

UK Water Supply
Regulations

Ü-Zeichen

VA-Zeichen



MEM Wall-mounted basin mixer without pop-up waste - Chrome

MEM

36 712 782 Product version from 3/10/2014 to 10/27/2020

Certificates and sustainability

LGA_18

ETA_19

WRAS_2204

EPD-DOR-20230287
-IBA1-EN
Environmental.prod
uct-declarat

36 712 782 Product version from 3/10/2014 to 10/27/2020

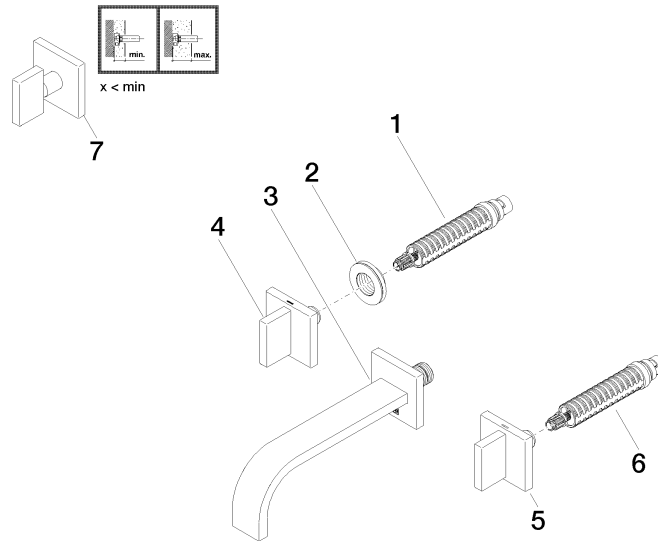

Spare parts list

No.	Item Number	Name	Quantity used	Delivery time
1	90 90 03 156 00 90	Head part anti-clockwise closing 1/2" -	1.00	14
2	09 21 02 108 90	Sleeve Ø 43,1 x 13 mm -	2.00	-
Spare part can no longer be ordered, please order the replacement item				
	9021021080090	Wall disc complete -		
4	90 20 78 002 07-00	Handle for wall valve Hot 60 x 75 x 60 mm - Chrome	1.00	20
5	90 20 78 002 06-00	Handle for wall valve Cold 60 x 75 x 60 mm - Chrome	1.00	20
3	13 800 782-00	MEM Wall-mounted basin spout without pop-up waste - Chrome	1.00	20
7	90 20 78 002 01-00	Handle 60 x 60 x 55 mm - Chrome	2.00	20
6	90 90 03 157 00 90	Head part clockwise closing 1/2" -	1.00	14