

**U-PKZ0, A-PKZ0, AGM2...-PKZ0, NHI...-PKZ0, NHI-E-PKZ0,  
XTPAXUVR..., XTPAXSR..., XTPAXSATR..., XTPAXSA..., XTPAXFA...**

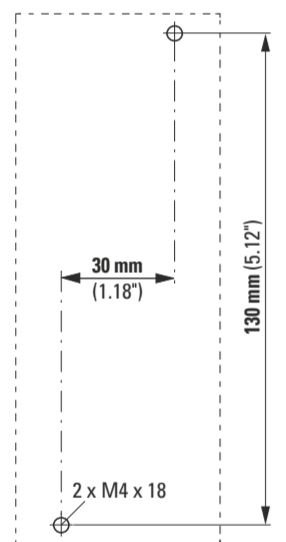
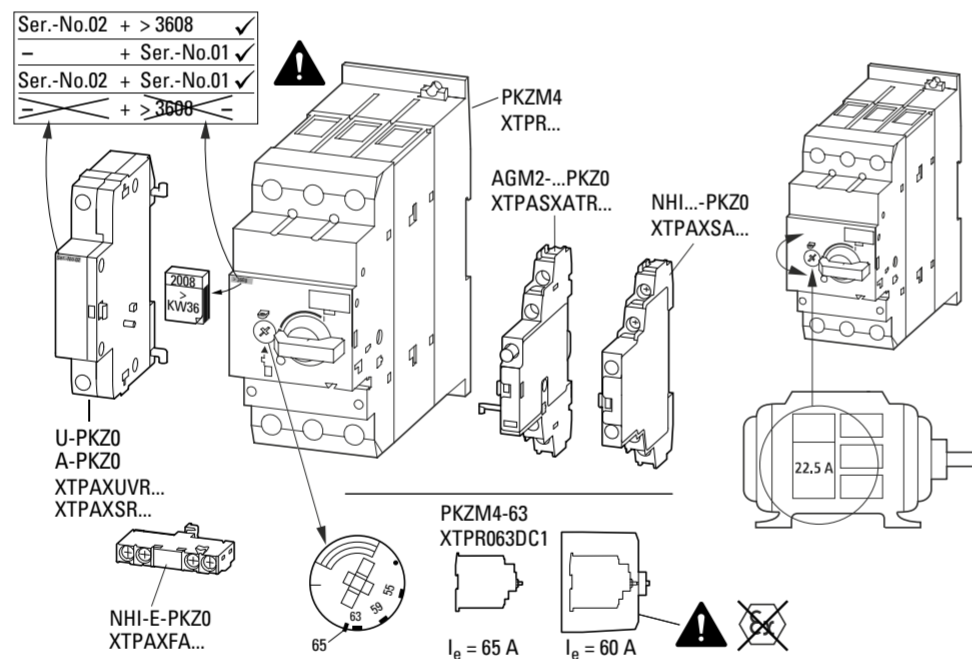

**Terminations**

Termination Type	mm <sup>2</sup>	mm <sup>2</sup>	mm <sup>2</sup>	Torque
	0.75 - 16	0.75 - 16	0.75 - 16	3.3 Nm (29.2 lb-in)
	0.75 - 35	0.75 - 35	0.75 - 35	
	16 - 50	16 - 50	16 - 35	

14 mm (0.55")

**for Canada:**  
**CAUTION**

Manufacturer's instructions for selecting overload and short-circuit protection must be followed. If an overload or fault current interruption has occurred, current-carrying components or the controller should be examined and replaced if damaged.

**pour Canada:**  
**AVERTISSEMENT**

Il est impératif de respecter les instructions du fabricant en choisissant les dispositifs de protection contre les surcharges et les court-circuits. En cas de coupure due à une surcharge ou à un courant de défaut, examiner les éléments porteurs de courant et le contrôleur et les remplacer s'ils sont endommagés.

Model	Lead Length (mm)
U(A)-PKZ0...	9 mm (0.35")
AGM2...	9 mm (0.35")
NHI...-PKZ0	9 mm (0.35")
NHI-E...PKZ0	6 mm (0.24")

**U(A)-PKZ0...**

	1 x (0.75 - 2.5 mm <sup>2</sup> )	1.2 Nm (10.6 lb-in)
	2 x (0.75 - 2.5 mm <sup>2</sup> )	
	1 x (0.75 - 2.5 mm <sup>2</sup> )	AWG18 - 16
	2 x (0.75 - 2.5 mm <sup>2</sup> )	

**AGM2...-PKZ0, NHI...-PKZ0**

	1 x (0.75 - 1.5 mm <sup>2</sup> )	1 Nm (8.85 lb-in)
	2 x (0.75 - 1.5 mm <sup>2</sup> )	
	1 x (0.75 - 1.5 mm <sup>2</sup> )	AWG18 - 14
	2 x (0.75 - 1.5 mm <sup>2</sup> )	

**NHI-E...PKZ0**

	1 x (0.75 - 1.5 mm <sup>2</sup> )	1.2 Nm (10.6 lb-in)
	2 x (0.75 - 1.5 mm <sup>2</sup> )	
	1 x (0.75 - 1.5 mm <sup>2</sup> )	AWG18 - 16
	2 x (0.75 - 1.5 mm <sup>2</sup> )	

**PKZM4...  
XTPR...**

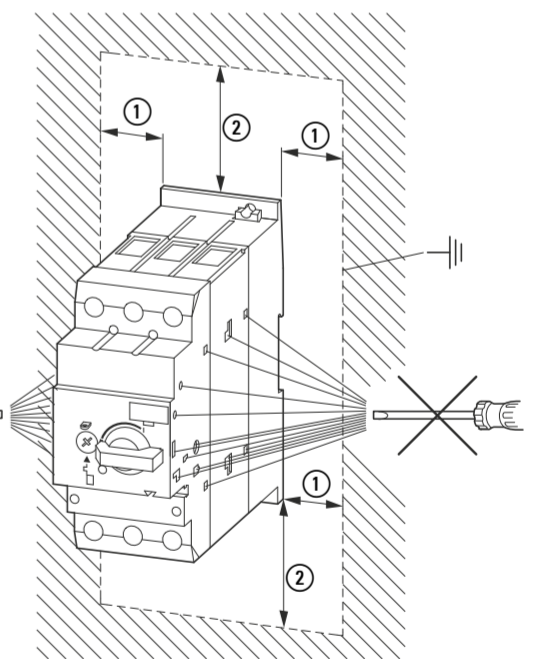
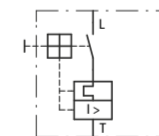
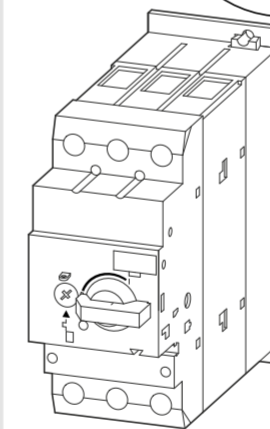
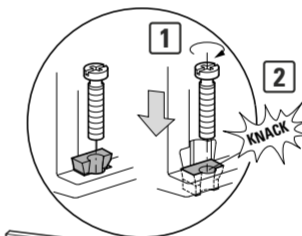
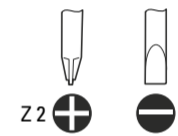

① ≥ 15 mm (≥ 0.59")  
② ≥ 55 mm (≥ 2.17")

EU: Eaton Industries GmbH, Hein-Moeller-Straße 7-11, 53115 Bonn, Germany  
UK: Eaton Electric Ltd., P.O. Box 554, Abbey Park, Southampton Road, Titchfield, PO14 4QA, United Kingdom  
اتون الكترک تقسیم ابنال 6، شارع سقرأط، معاريف امتداد، طابق 1، الرمزا البريدي 20370، الدار البيضاء، المغرب

