

3SK-200420BP: Double Backplate elbow female short model 20x1/2"x20

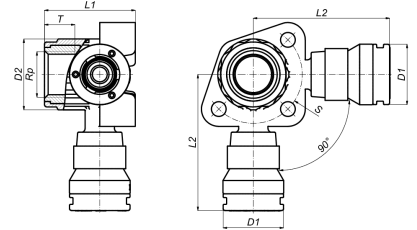

Commercial information

The construction of the push fitting shows that Henco Vision is the result of sophisticated product development. All of its components have been made with the greatest precision and are manufactured from the best materials. Henco Vision push fittings are made from a high-quality synthetic material with a unique range of properties:

- Extremely resistant to pressure and temperature.
 - Outstanding mechanical strength.
 - Enormous flexibility: can bend up to 10° at 95°C.
 - Perfectly suitable for drinking water and foods Henco Vision push fittings can be used for both sanitary and heating applications.
- Ease of use - fast assembly: The Henco push fitting guarantees an extremely fast and reliable connection. All you need to make a perfect connection is a pipe cutter and a calibrator. Pressing tools are not required. You only need to follow three steps for a fast and reliable connection, in combination with the Henco PE-Xc/AL/PE-Xc multilayer pipe.

Basic unit dimensions

Height	47 mm
Length	87 mm
Width	87 mm
Net weight	0.142 kg

Certificates

ETA, SINTEF, STF, GOST-R, TSU, ATG, RISE, ACS, PZH, EMI, KIWA

Applications

Potable water, Heating, Cooling, Sanitary

Solutions

Building installations, Industry, Utility

Technical characteristics

Housing material	Polyvinylidene fluoride (PVDF)	Outer pipe diameter connection	20 Millimetre
Surface protection	Untreated	Medium temperature (continuous)	-10 70 Degrees celsius
Shape	Right-angled	Max. operating pressure at 20 °C	10 Bar
System specific	✓		
Nominal diameter connection 2	1/2 inch (15)		
Connection	Insert (push-fitting)		
Thread size tap connection	1/2 inch		
DVGW quality mark for gas	✗		
DVGW quality mark for water	✓		
Compliant with NF 545	✗		
KIWA certified	✓		
Gastec QA mark	✗		
KOMO certified	✓		
Type approval according to BBR/EKS	✗		