

Seamless Integration

How to Choose the Right Smart Meter

Which Smart Meter Do I Need?

To select the most suitable smart meter for your EcoFlow PowerOcean system, use our comprehensive flowchart to find the perfect model. Answer the following questions to narrow your options and discover the meter that best fits your needs.

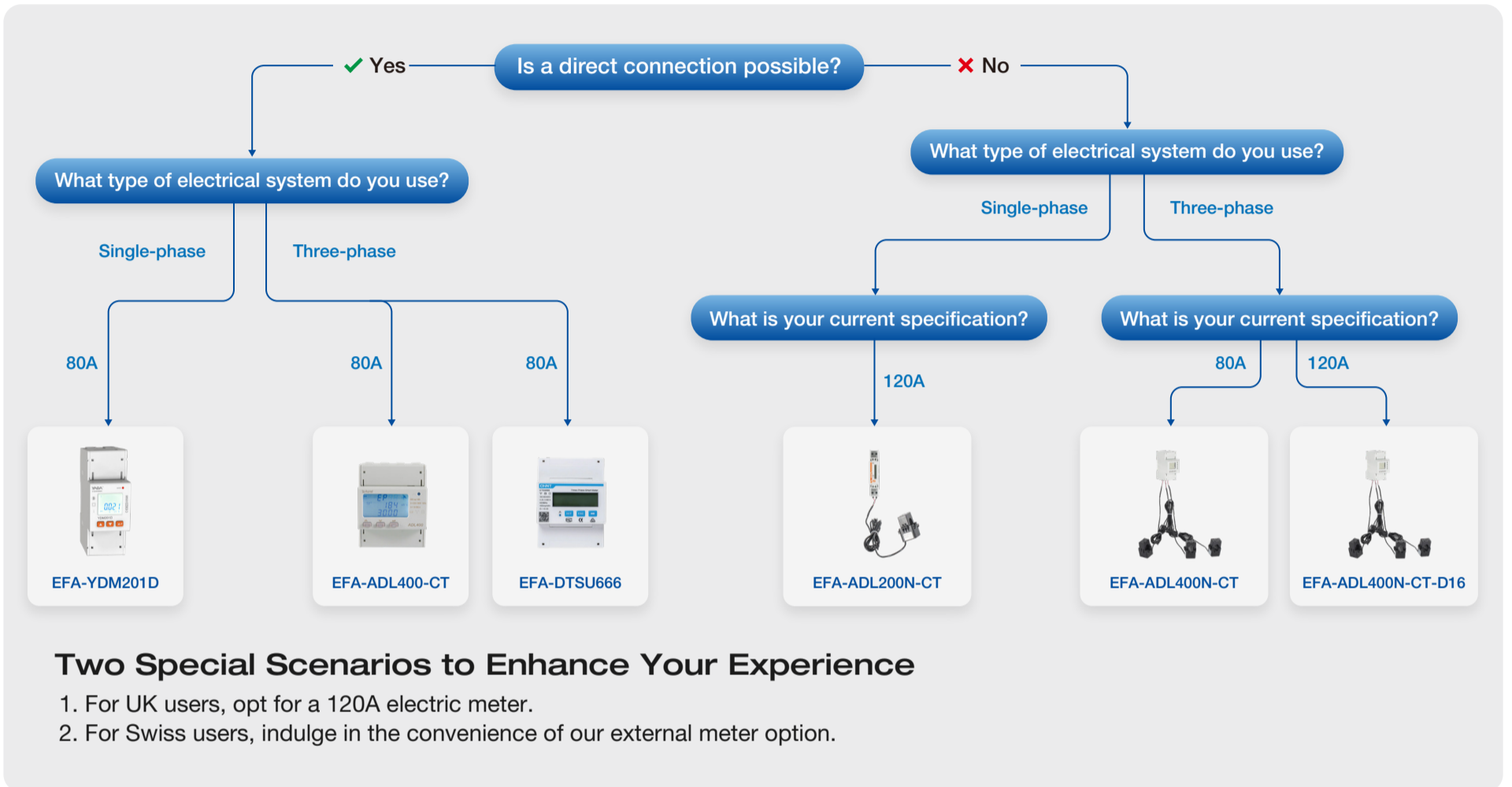

Elevate your energy management with tailored solutions from us.



SKU	EFA-YDM201D	EFA-ADL200N-CT	EFA-ADL400-CT	EFA-DTSU666	EFA-ADL400N-CT	EFA-ADL400N-CT-D16
Size	36×102×65mm	18×90×65mm	72×90×65mm	72×100×65.5mm	45×90×65mm	45×90×65mm
Rated Current	80A	120A	80A	80A	80A	120A
Installation	DIN rail	DIN rail	DIN rail	DIN rail	DIN rail	DIN rail
Communication	RS485	RS485	RS485	RS485	RS485	RS485
Phase Electricity	Single-phase	Single-phase	Three-phase	Three-phase	Three-phase	Three-phase
Current Measurement	Built-in CT	External CT	Built-in CT	Built-in CT	External CT	External CT
Applicable Product	PowerOcean (Single-Phase) PowerOcean DC Fit PowerGlow	PowerOcean (Single-Phase) PowerOcean DC Fit PowerGlow	PowerOcean (Three-Phase) PowerOcean DC Fit PowerPulse PowerGlow PowerOcean Plus	PowerOcean (Three-Phase) PowerOcean DC Fit PowerGlow PowerOcean Plus	PowerOcean (Three-Phase) PowerOcean DC Fit PowerGlow PowerOcean Plus	PowerOcean (Three-Phase) PowerOcean DC Fit PowerGlow PowerOcean Plus

* All specifications and descriptions shown may differ from the actual specification of the product. EcoFlow reserves the right to make changes and amendments to the product shown and described here at any time without prior notice of such change. All functionality, features, specifications, design, and other product information displayed in this document, including, but not limited to, components, performance, availability, and capabilities of the product, are subject to change without notice. The contents and simulated images within the document are for demonstration purposes only.