

Product End of Life Instructions

Universal Power Supply 1 phase 24V 5A

Phaseo ABL8RPS

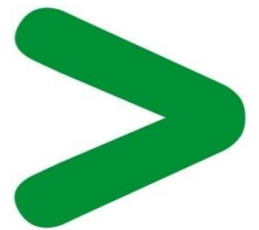



Potential disassembly risks

The information provided in this document assumes that the product is completely de-energized and uninstalled (refer to the instructions provided in the appropriate product manuals).

Dismantling/disassembling the product may entail hazards caused by, for example, sharp edges, chemical aggression or ejected parts.

⚠ WARNING

HAZARD DUE TO INSUFFICIENT PROTECTION

- Implement all safety measures required by the applicable regulations and by the processes used to dismantle/disassemble and dispose of the product.
 - Use all necessary personal protective equipment such as gloves and goggles.
- Failure to follow these instructions can result in death or serious injury.**



End of Life Instructions

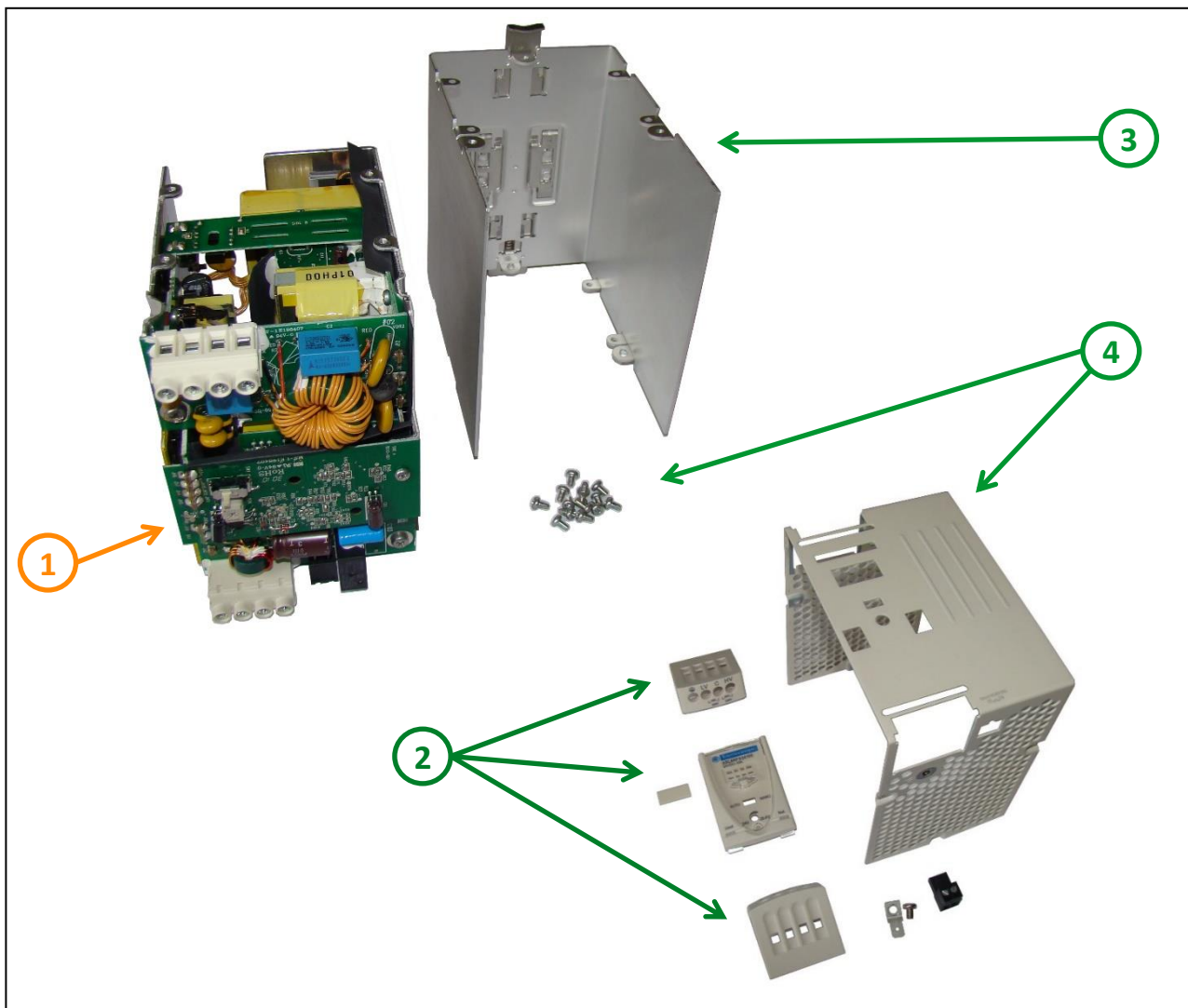

Recommendation	Number on drawing	Component / Material	Weight (in g)	Comment
To be depolluted	1	Electronic Board (Power) > 10cm ²	429,8	PCBA (power)
To be dismantled	2	PC Housing	6,4	
To be dismantled	3	Aluminium	140	
To be dismantled	4	Steel	132,5	
Other			47,8	

Product description

Manufacturer identification	Schneider Electric Industries SAS
Brand name	Schneider Electric
Product function	This ABL8 regulated switch mode power supply (SMPS) supplies direct current voltage. It has a rated input of 100V to 500V AC, a rated output current of 5A at 24V DC and a rated power output
Product reference	ABL8RPS24050
Additional similar product references	ABL8RPS24050 ABL8DCC05060 ABL8DCC12020 ABL8RPS24030 ABL8RPS24100
Total representative product mass	756,5 g
Representative product dimensions	78 mm x 165 mm x 145 mm
Accessories	No
Date of information release	14/11/2025

Additional information

Legal information	This product family is in the scope of European Union directive 2012/19/EU on Waste Electrical and Electronic Equipment (WEEE). The product family must be disposed according to the legislation of the country. This document is intended for use by end of life recyclers or treatment facilities. It provides the basic information to assure an appropriate end of life treatment for the components and materials of the product.
In case of special transportation: transportation method	No special transportation
Recyclability potential	40% The recyclability rate was calculated from the recycling rates of each material making up the product based on REEECY'LAB tool developed by Ecosystem, for components/materials not covered by the tool, data from the EIME database and the related PSR was taken. If no data was found a conservative assumption was used (0% recyclability).

Schneider Electric Industries SAS

Country Customer Care Center

<http://www.se.com/contact>

35, rue Joseph Monier

CS 30323

F- 92500 Rueil Malmaison Cedex

RCS Nanterre 954 503 439

Capital social 928 298 512 €

www.se.com

Published by Schneider Electric

ENVEOLI061201_V3

© 2023 - Schneider Electric – All rights reserved

14/11/2025