

# Technical data sheet

90° bend 60, black

Item number: 6043262



90° bend, horizontal, fitting for all cable tray types of 60 mm side height. Black coated.

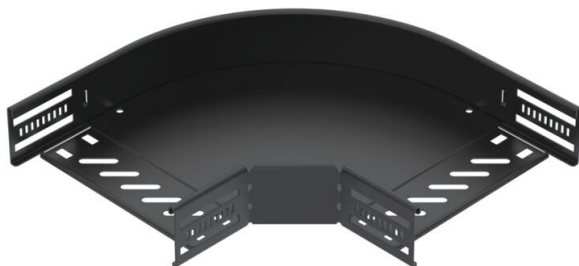

**St** Steel

**P135** PES135 - Polyester

## Master data

Item number	6043262
Type	RB 90 620 FSK SW
Description 1	90° bend
Description 2	for cable tray, horizontal
Manufacturer	OBO
Dimension	60x200
Colour	Jet black; RAL 9005
Material	Steel
Surface	PES135 - Polyester
Surface standard	
Smallest sales unit	1
Unit of quantity	Piece
Weight	99.2 kg
Weight unit	kg/100 pc.
CO2 Footprint (GWP) Cradle-to-Gate	0,1624 kg CO2e / 1 Piece

# Technical data sheet

90° bend 60, black

Item number: 6043262



## Dimensions

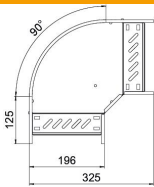

Width	200 mm
Height	60 mm
Dimension B	200 mm

## Technical data

Bend (angle)	90°
Connector version	Integrated connector
Type	Bend, rigid
Maintain electrical functions	yes
Material thickness, floor plate	0.8 mm
With cover	no
Mounting perforation in base	no
Change of direction	Horizontal
Rustproof steel, pickled	no
Side perforation	no
Wide-span version	no
Recommended quantity of bolts	12 St.
Rail thickness	1.25 mm