

4P-1604: Backplate elbow female extended model 16x1/2"

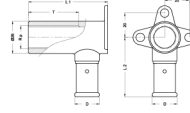
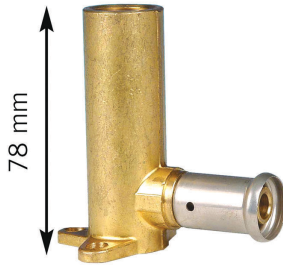

Commercial information

Deze fittingen bieden grote voordelen ten aanzien van corrosie.

- Het huis van de fitting bestaat uit messing CW617N.
- De fitting is voorzien van een stoorring om direct galvanisch contact tussen het aluminium van de buis en het messing van de fitting te voorkomen.
- Elektrolyse is hierdoor uitgesloten.
- De fitting is uitgerust met O-ringen uit EPDM en RVS persulzen met 3 controlevensters.
- Om montagefouten te voorkomen zijn de RVS persulzen voorzien van de maatvoering en het type persprofiel waarmee geperst kan worden.

Certificates

ATG, DVGW Wasser, ETA, KIWA, ÖVGW Wasser, WRAS, KOMO, STF, ÖN EN 21003-2/-3, GOST-R, ITC, TSU, QB (CSTBat), AFNOR, ACS, PZH, DNV-GL, Sans 21003, Kontrol Biro, EMI

Applications

Potable water, Heating, Compressed air, Cooling, Sanitary

Solutions

Building installations, Industry, Utility, Shipbuilding

Technical characteristics

Housing material	Brass	Outer pipe diameter connection	16 Millimetre
Housing material	Brass	Length of connection 1	67 Millimetre
Surface protection	Untreated	Length of connection 2	71.5 Millimetre
Shape	Right-angled	Working length connection 2	54 Millimetre
Thread size	1/2 inch	Length from wall plate	78 Millimetre
System specific	✓	Length of connection 3	0 Millimetre
Nominal diameter connection 2	1/2 inch (15)	Working length connection 3	0 Millimetre
Connection	Press sleeve	Medium temperature (continuous)	-10 70 Degrees celsius
Thread size tap connection	1/2 inch	Max. operating pressure at 20 °C	16 Bar
Contour code	TH		
DVGW quality mark for gas	✗		
DVGW quality mark for water	✓		
KIWA certified	✓		
Gastec QA mark	✗		
KOMO certified	✓		
Type approval according to BBR/EKS	✗		

Related products

Product code	GTIN	Description	Image
BE16	05414764031050	Henco Jaws (universal) BE/TH-Profile 16x2	
PRESSCHECK1432	05414764031050	Henco Tool to control the accuracy of a pressing Ø14-32	