

## Data Sheet | Item Number: 770-977/076-000

Distributor for status queries; 2-pole/3-pole; Cod. B; 1 input; 2 outputs; 3-pole output for status queries; 3 locking levers; light turquoise

<https://www.wago.com/770-977/076-000>

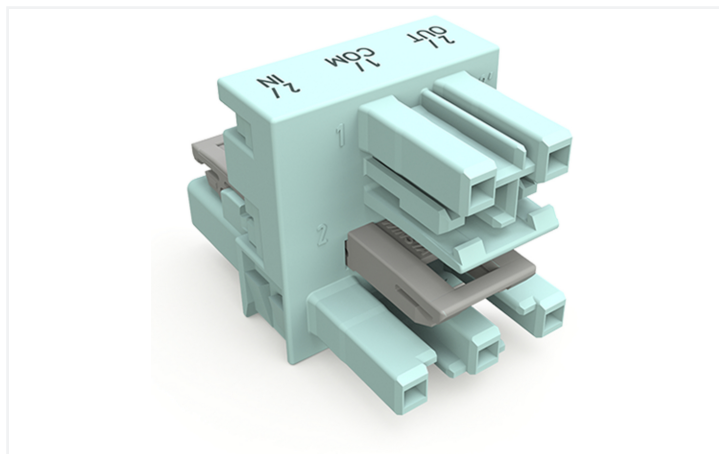
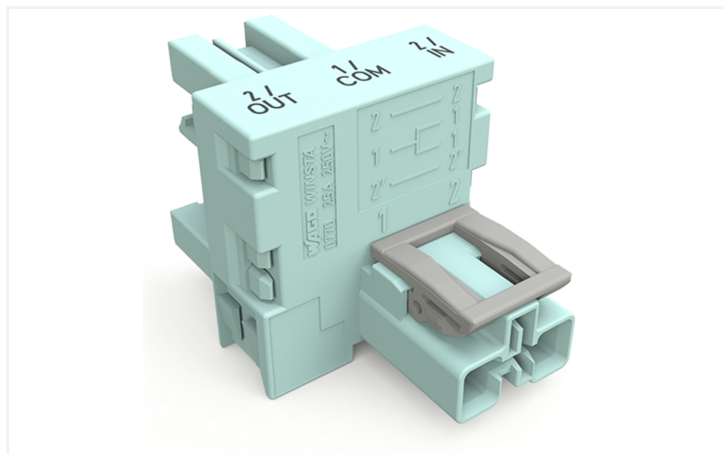

Color: ■ light turquoise

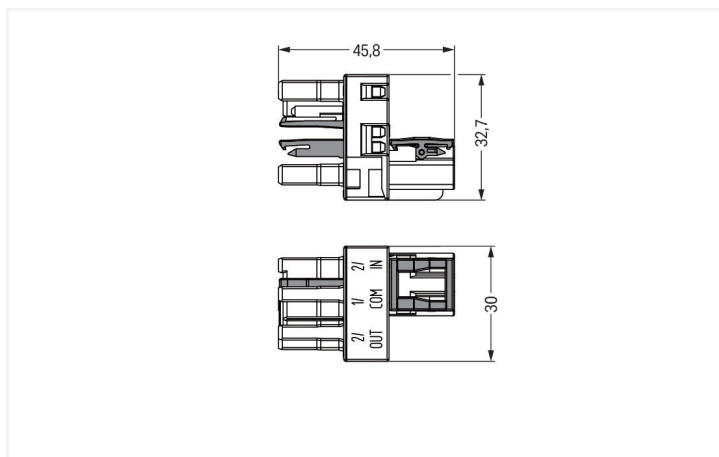
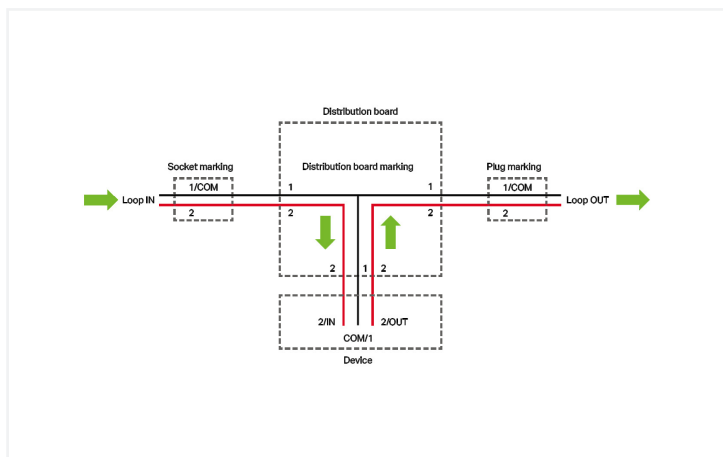

Dimensions in mm

Distribution connector *WINSTA*® MIDI rated current 25 A

Use effective pluggable connections instead of laborious screw connections: With the *WINSTA*® MIDI distribution connector with protection against mismatching, WAGO pluggable installation connectors are used when criteria repeat or are distributed on a specified pattern, for example for installing grid lighting or flush-mount lighting. For greater security in electrical installations, the pluggable installation connector is equipped with mechanical protection against mismatching. The pluggable installation connector is protected in accordance with protection type IP20 (When mated: IP2xC (These compact connectors are not designed for use in open, easily accessible areas!)). This means that users' fingers will never come into contact with energised contact elements. Solutions like the *WINSTA*® MIDI pluggable installation connectors with B coding are suitable for process control, such as for lighting or in data networks. This pluggable installation connector is used for electrical currents up to 25 A. Thus the product is also suitable for high power loads. *WINSTA*® MIDI with Push-in CAGE CLAMP® spring pressure connection technology is used in can be found in a variety of projects you can use for quick, easy, flexible, and secure installation.

Lower costs through fast commissioning and elimination of service expenses – solutions from *WINSTA*® MIDI

The *WINSTA*® Pluggable Connection System allows pluggable electrical installation. This saves time, lowers costs, and reduces the need for servicing. Now you can also reduce installation expenses without compromising safety and quality: with locking lever reduces the need for servicing and prevents unnecessary downtime.

- protection against mismatching eliminates errors
- simple circuits

- for automation controllers
- ready for immediate use
- convenient installation and commissioning

## Notes

Variants:	Other pole markings Other versions (or variants) can be requested from WAGO Sales or configured at <a href="https://configurator.wago.com/">https://configurator.wago.com/</a> .
-----------	---

## Electrical data

Ratings per	IEC/EN 60664-1			Approvals per	UL 1977
Overvoltage category	III	III	II	Rated voltage	600 V
Pollution degree	3	2	2	Rated current	23 A
Nominal voltage	250 V	-	-		
Rated impulse withstand voltage	4 kV	-	-		
Rated current	25 A	-	-		

## General information

Note on contact resistance	approx. 1 mΩ of contact resistance approx. 0.25 mΩ contact transition plug/ socket
----------------------------	--

## Connection Data

Total number of potentials	3	<b>Connection 1</b>	
		Pole number	3

## Physical data

Pin spacing	10 mm / 0.394 inches
Width	30 mm / 1.181 inches
Height	32.7 mm / 1.287 inches
Depth	45.8 mm / 1.803 inches

## Mechanical data

Use	Control technology
Coding	B
Variable coding	No
Marking	2/OUT 1/COM 2/IN
Potential marking	2/OUT 1/COM 2/IN
Mating force of a plug-in connection	Approx. 20 ... 70 N (depending on pole number)
Retention force of a plug-in connection	When locked: > 80 N
Unmating force of a plug-in connection	Unlocked: approx. 20 ... 70 N (depending on pole number)
Number of mating cycles	200, without resistive load
Type of distribution box	h-distribution connector for status queries
Protection type	IP20; When mated: IP2xC (These compact connectors are not designed for use in open, easily accessible areas!)

## Plug-in connection

Mismating protection	Yes
Note on mismating protection	All WINSTA® components are 100% protected against mismating when: a.) plugging different numbers of poles b.) plugging while rotated 180 c.) plugging while laterally staggered d.) plugging one pole
Locking lever	Yes
Locking of plug-in connection	Locking lever
Note on locking system	All connectors for mounted installations (snap-in versions for lighting fixtures or devices, all types of PCB and distribution connectors) are factory-equipped with locking levers to ensure plugs and sockets are securely locked. Additional locking levers are only required for flying leads (plug/socket).
Number of locking levers	3

## Material data

Note (material data)	<a href="#">Information on material specifications can be found here</a>
Color	light turquoise
Insulation material (main housing)	Polyamide (PA66)
Flammability class per UL94	V0
Contact material	Copper or copper alloy; surface-treated
Contact Plating	Tin
Fire load	0.335 MJ
Weight	17.9 g

## Environmental requirements

Processing temperature	-5 ... +40 °C
Continuous operating temperature	-35 ... +85 °C
Note on continuous operating temperature	Insulating parts for temperatures ≤ 105 °C

## Commercial data

PU (SPU)	25 pcs
Packaging type	Box
Country of origin	DE
GTIN	4055143767200
Customs tariff number	85366990990

## Product Classification

UNSPSC	39121421
eCl@ss 10.0	27-44-06-03
eCl@ss 9.0	27-44-06-03
ETIM 9.0	EC002567
ETIM 10.0	EC002567
ECCN	NO US CLASSIFICATION

### Environmental Product Compliance

RoHS Compliance Status Compliant, No Exemption

### Approvals / Certificates

#### Approvals for marine applications



Approval	Standard	Certificate Name
DNV GL Det Norske Veritas, Germanischer Lloyd	-	TAE00001Z6

### Downloads

#### Environmental Product Compliance

Compliance Search	
Environmental Product Compliance 770-977/076-000	<a href="#">↓</a>

### Documentation

Bid Text			
770-977/076-000	19.02.2019	xml 2.98 KB	<a href="#">↓</a>
770-977/076-000	14.01.2019	doc 23.50 KB	<a href="#">↓</a>

### CAD/CAE-Data

CAD data	
2D/3D Models 770-977/076-000	<a href="#">↓</a>

### 1 Compatible Products

#### 1.1 System counterpart

##### 1.1.1 Female connector/socket



**Item No.: 770-1242/076-000**  
Socket; 2-pole; Cod. B; 4,00 mm<sup>2</sup>; light turquoise

**Item No.: 770-1243/076-000**  
Socket; 3-pole; Cod. B; 4,00 mm<sup>2</sup>; light turquoise

### 1.1.2 Male connector/plug



**Item No.:** [770-1252/076-000](#)

Plug; 2-pole; Cod. B; 4,00 mm<sup>2</sup>; light turquoise

**Item No.:** [770-1253/076-000](#)

Plug; 3-pole; Cod. B; 4,00 mm<sup>2</sup>; light turquoise

## 1.2 Required Accessories

### 1.2.1 Locking system

#### 1.2.1.1 Locking system



**Item No.:** [770-101](#)

Locking lever; for flying leads; for manual operation; black



**Item No.:** [770-121](#)

Locking lever; for flying leads; for manual operation; white



**Item No.:** [770-111](#)

Locking lever; for flying leads; for tool operation; black



**Item No.:** [770-131](#)

Locking lever; for flying leads; for tool operation; white

## 1.3 Optional Accessories

### 1.3.1 Cover

#### 1.3.1.1 Cover



**Item No.:** [770-201](#)

Lockout cap; 12-pole, separable; for sockets; Plastic; black



**Item No.:** [770-221](#)

Lockout cap; 12-pole, separable; for sockets; Plastic; white



**Item No.:** [770-360](#)

Lockout cap; for plugs; 5-pole; separable; yellow

## 1.3.2 Installation

### 1.3.2.1 Mounting accessories



**Item No.:** [770-623](#)

Mounting plate; 3-pole; for distribution connectors; Plastic; black



**Item No.:** [770-673](#)

Mounting plate; 3-pole; for distribution connectors; Plastic; white

## Installation Notes

### Installation

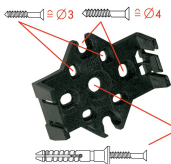

Mounting plates can be secured using commercially available screws or nail-drive anchors.



The distribution connectors snap together when attached to the mounting plate.



To release the distribution connector, unlock the latch using a screwdriver.

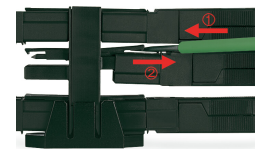

All distribution connector connections are locked and protected against accidental disconnection directly after mating. Locking of any connection is released using a screwdriver, even if all connections are used.