

## VVSK-T26M26: T-piece for supply for manifold Ø26

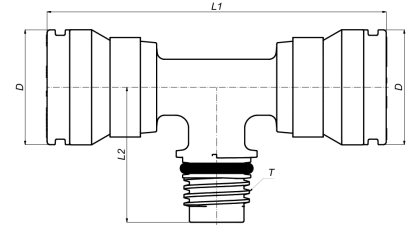

### Commercial information

Synthetic T-piece for manifold, male, with 2x SK connectors

#### Basic unit dimensions

Height	40 mm
Length	117 mm
Width	67 mm
Net weight	0.101 kg

#### Certificates

QB (CSTBat), ETA, KIWA, ÖVGW Wasser, SINTEF, SITAC, KOMO, STF, GOST-R, TSU, EMI

#### Applications

Potable water, Heating, Cooling, Sanitary

#### Solutions

Building installations, Industry, Utility

## Technical characteristics

Material connection 1	Polyvinylidene fluoride (PVDF)	Angle	90 Degrees
Surface protection connection 1	Untreated	Outer pipe diameter connection 1	26 Millimetre
Surface treatment connection 1	Untreated	Outer pipe diameter connection 3	26 Millimetre
Material connection 2	Polyvinylidene fluoride (PVDF)	Wrench width	0 Millimetre
Surface protection connection 2	Untreated	Max. operating pressure at 20 °C	10 Bar
Surface treatment connection 2	Untreated	Wrench width union nut	0 Millimetre
Material connection 3	Polyvinylidene fluoride (PVDF)	Medium temperature (continuous)	-10 70 Degrees celsius
Surface treatment connection 3	Untreated	Standard Dimension Ratio (SDR)	0
Model	T-piece		
Swept entry type (with inner radius)	✘		
Reducing	✘		
System specific	✔		
Connection 1	Insert (push-fitting)		
Contour code connection 1	Other		
Connection 2	Internal thread cylindrical BSPP-G (ISO 228-1)		
Contour code connection 2	Other		
Connection 3	Insert (push-fitting)		
Contour code connection 3	Other		
Flange standard	Other		
Material sealing	Ethylene-propylene diene monomer rubber (EPDM)		
Main colour fitting	White		
High tensile strength	✘		
Ring stiffness class	Other		
With sealing rings/gaskets	✔		
With drain valve	✘		
With de-aerator	✘		
With thermal insulation	✘		
With buffer stud	✘		
Capped	✘		
FM quality mark	✘		
LPCB quality mark	✘		
ULC quality mark	✘		
UL quality mark	✘		
DIN-CERTCO certificate	✘		
VdS quality mark	✘		
With approval for TÜV	✘		
DVGW quality mark for gas	✘		
DVGW quality mark for water	✔		
KIWA certified	✔		
Gastec QA mark	✘		
KOMO certified	✔		
Type approval according to BBR/EKS	✘		