

12PKG-202620: T-enlarged centre Gas 20x26x20

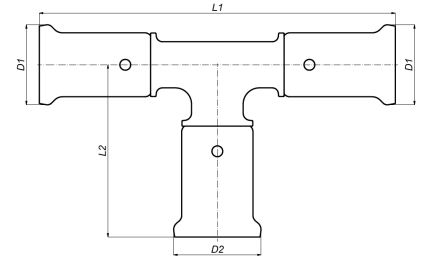

Commercial information

The PVDF press fittings for gas differ in only one significant technical aspect compared to press fittings for sanitary and heating applications. The fittings have a special O-ring that is made from the HNBR and is resistant to gas. To make this difference visible, every pressure sleeve has a yellow band. The fittings for gas should never be used for sanitary applications or heating applications. Similarly, fittings for gas should only be used in combination with the yellow HENCO multilayer pipe for gas. The Henco system for gas is only permitted in countries where a gas quality mark has been granted.

PVDF offers the user a unique combination of properties:

- Highly resistant to pressure and temperature
- Excellent mechanical strength
- Extreme flexibility: bending up to 10° is possible
- Highly resistant to chemicals and corrosion
- Embedding is possible without extra protection

Basic unit dimensions

| | |
|------------|----------|
| Height | 33 mm |
| Length | 107 mm |
| Width | 65 mm |
| Net weight | 0.080 kg |

Certificates

GASTEC, TSU, ROST

Applications

Gas

Solutions

Building installations, Industry, Oil & gas, Utility, Shipbuilding

Technical characteristics

| | | | |
|--------------------------------------|--|----------------------------------|------------------------|
| Material connection 1 | Polyvinylidene fluoride (PVDF) | Angle | 90 Degrees |
| Surface protection connection 1 | Untreated | Outer pipe diameter connection 1 | 20 Millimetre |
| Surface treatment connection 1 | Untreated | Wall thickness, connection 1 | 0.7 Millimetre |
| Material connection 2 | Polyvinylidene fluoride (PVDF) | Outer pipe diameter connection 2 | 26 Millimetre |
| Surface protection connection 2 | Untreated | Wall thickness, connection 2 | 0.95 Millimetre |
| Surface treatment connection 2 | Untreated | Outer pipe diameter connection 3 | 20 Millimetre |
| Material connection 3 | Polyvinylidene fluoride (PVDF) | Wall thickness, connection 3 | 0.7 Millimetre |
| Surface treatment connection 3 | Untreated | Length of connection 1 | 53.5 Millimetre |
| Model | T-piece | Working length connection 1 | 26.5 Millimetre |
| Swept entry type (with inner radius) | ✘ | Length of connection 2 | 51.5 Millimetre |
| Reducing | ✓ | Working length connection 2 | 24.5 Millimetre |
| System specific | ✓ | Length of connection 3 | 53.5 Millimetre |
| Connection 1 | Press sleeve | Working length connection 3 | 26.5 Millimetre |
| Contour code connection 1 | TH | Wrench width | 0 Millimetre |
| Connection 2 | Press sleeve | Max. operating pressure at 20 °C | 16 Bar |
| Contour code connection 2 | TH | Wrench width union nut | 0 Millimetre |
| Connection 3 | Press sleeve | Medium temperature (continuous) | -20 60 Degrees celsius |
| Contour code connection 3 | TH | Standard Dimension Ratio (SDR) | 0 |
| Flange standard | Other | | |
| Material sealing | Hydrogenated acrylonitrile butadiene rubber (HNBR) | | |
| Main colour fitting | Black | | |
| High tensile strength | ✘ | | |
| Ring stiffness class | Other | | |
| With sealing rings/gaskets | ✓ | | |
| With drain valve | ✘ | | |
| With de-aerator | ✘ | | |
| With thermal insulation | ✘ | | |
| With buffer stud | ✓ | | |
| Capped | ✘ | | |
| FM quality mark | ✘ | | |
| LPCB quality mark | ✘ | | |
| ULC quality mark | ✘ | | |
| UL quality mark | ✘ | | |
| DIN-CERTCO certificate | ✘ | | |
| VdS quality mark | ✘ | | |
| With approval for TÜV | ✘ | | |
| DVGW quality mark for gas | ✘ | | |
| DVGW quality mark for water | ✘ | | |
| KIWA certified | ✘ | | |
| Gastec QA mark | ✓ | | |
| KOMO certified | ✘ | | |
| Type approval according to BBR/EKS | ✘ | | |