







**CL.1 Wall valve clockwise closing cold 1/2" - Chrome**

CL.1

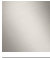
36 617 706 Product version up to 10/14/2020



- with WAVES structure
- rosette 60 x 60 mm
- with cold marking
- head part with cut-to-length spindle and sleeve
- WRAS

	Chrome	36 617 706-00
	Brushed Platinum	36 617 706-06
	Dark Chrome	36 617 706-19
	Brushed Light Gold (PVD)	36 617 706-27
	Brushed Champagne (22kt Gold)	36 617 706-46
	Champagne (22kt Gold)	36 617 706-47
	Brushed Dark Platinum	36 617 706-99

**Required miscellaneous**



- Wall valve 1/2" -** 35 607 970 90
- min. recess depth 105 mm
  - max. recess depth 150 mm

36 617 706 Product version up to 10/14/2020

mm [inches]



**Codes & Standards**

ASME A112.18.1	cUPC	DIN 4109	EN 200
ISO 3822	Scottish Water Byelaws	UK Water Supply Regulations	Ü-Zeichen

**Certificates and sustainability**

DVGW_DW-6501DN0	LGA_29	WRAS_2010	LGA_29	IAPMO_4976 (
EPD-DOR-20230287 -IBA1-EN Environmental product-declaration				

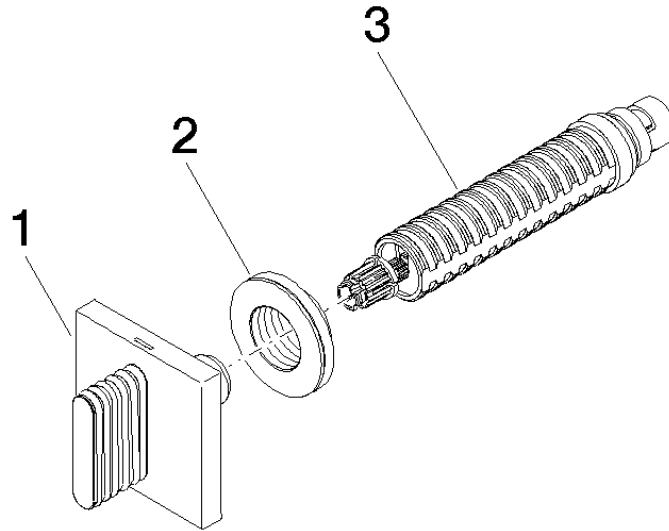

Spare parts list

No.	Item Number	Name	Quantity used	Delivery time
3	90 90 03 143 00 90	Head part clockwise closing 1/2" -	1.00	14
2	09 21 02 108 90	Sleeve Ø 43,1 x 13 mm -	1.00	-
Spare part can no longer be ordered, please order the replacement item				
	9021021080090	Wall disc complete -		
1	90 20 70 055 02-00	Handle for concealed wall mounting Cold oval wave 60 x 60 x 40 mm - Chrome	1.00	20