

Dispenser Pump head, complete Installation variant with rosette - Brushed Light Gold (PVD)

SPARE PARTS

90 10 10 538 00 Product version from 4/1/2025



	Brushed Light Gold (PVD)	90 10 10 538 00-27
	Chrome	90 10 10 538 00-00
	Brushed Platinum	90 10 10 538 00-06
	Platinum	90 10 10 538 00-08
	Matte White	90 10 10 538 00-10
	Dark Chrome	90 10 10 538 00-19
	Brushed Durabronze (23kt Gold)	90 10 10 538 00-28
	Matte Black	90 10 10 538 00-33
	Brushed Bronze (PVD)	90 10 10 538 00-42
	Brushed Champagne (22kt Gold)	90 10 10 538 00-46
	Champagne (22kt Gold)	90 10 10 538 00-47
	Cyprum	90 10 10 538 00-49
	Brushed Chrome	90 10 10 538 00-93
	Brushed Dark Platinum	90 10 10 538 00-99



Dispenser Pump head, complete Installation variant with rosette - Brushed Light Gold (PVD) SPARE PARTS

90 10 10 538 00 Product version from 4/1/2025



Dispenser Pump head, complete Installation variant with rosette - Brushed Light Gold (PVD) SPARE PARTS

90 10 10 538 00 Product version from 4/1/2025

Dispenser Pump head, complete Installation variant with rosette - Brushed Light Gold (PVD) SPARE PARTS

90 10 10 538 00 Product version from 4/1/2025

Parts for other finishes can be found here: [Chrome](#)

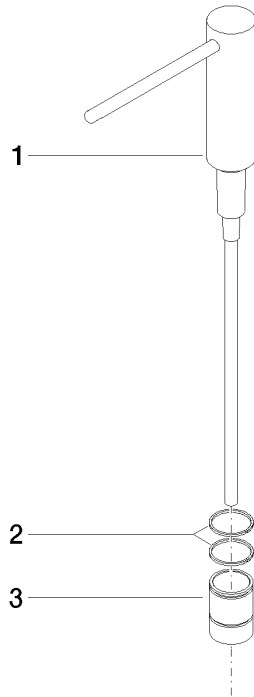

Spare parts list

No.	Item Number	Name	Quantity used	Delivery time
3	08 10 10 538-27	Retainer for lotion dispenser Integrated Ø 27 x 38 mm - Brushed Light Gold (PVD)	1.00	82
2	09 14 15 014 90	Ring Ø 27,1 x Ø 24,4 x 1,5 mm -	2.00	14
1	90 10 10 534 00-27	Dispenser Pump head, complete Installation variant - Brushed Light Gold (PVD)	1.00	40