

## 2P-1404K: Backplate elbow female short model 14x1/2"

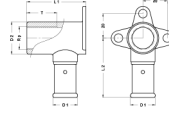
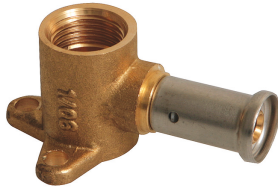

### Commercial information

The body of the fitting is made from CW617N brass. These fittings offer great advantages with regard to corrosion and they are also also better for the environment.

- The fitting has a buffer ring that prevents direct galvanic contact between the aluminium of the pipe and the brass of the fitting.
- This excludes the possibility of electrolysis occurring.
- The fitting is equipped with O-rings made from EPDM and RVS pressure sleeves with 3 inspection windows.
- In order to prevent assembly errors, the dimensions and type of press profile which can be pressed are shown on the RVS sleeves

### Certificates

ATG, DVGW Wasser, ETA, KIWA, ÖVGW Wasser, WRAS, KOMO, STF, ÖN EN 21003-2/-3, GOST-R, ITC, TSU, QB (CSTBat), AFNOR, ACS, PZH, DNV-GL, EMI

### Applications

Potable water, Heating, Compressed air, Cooling, Sanitary



### Solutions

Building installations, Industry, Utility, Shipbuilding

## Technical characteristics

Housing material	Brass	Outer pipe diameter connection	14 Millimetre
Housing material	Brass	Length of connection 1	30.5 Millimetre
Surface protection	Untreated	Working length connection 1	25 Millimetre
Shape	Right-angled	Length of connection 2	32 Millimetre
Thread size	1/2 inch	Working length connection 2	32 Millimetre
System specific	✓	Length from wall plate	32 Millimetre
Nominal diameter connection 2	1/2 inch (15)	Length of connection 3	0 Millimetre
Connection	Press sleeve	Working length connection 3	0 Millimetre
Thread size tap connection	1/2 inch	Medium temperature (continuous)	-10 70 Degrees celsius
Contour code	TH	Max. operating pressure at 20 °C	16 Bar
DVGW quality mark for gas	✗		
DVGW quality mark for water	✓		
KIWA certified	✓		
Gastec QA mark	✗		
KOMO certified	✓		
Type approval according to BBR/EKS	✗		

## Related products

Product code	GTIN	Description	Image
BE14	05414764028845	Henco Jaws (universal) BE/TH-Profile 14x2	
PRESSCHECK1432	05414764028845	Henco Tool to control the accuracy of a pressing Ø14-32	
PLF-P-PK	05414764028845	Henco Galvanised bracket flat for backplate elbow	
PLP-P-PK	05414764028845	Henco Galvanised bracket for backplate elbow	