

28 012 979 Product version from 4/1/2024



- spray head Ø 120mm
- Four settings: COMPACT RAIN, COMPACT SOFT FLOW, COMPACT AQUAPRESSURE FLOW, COMPACT CASCADE, max. flow rate 6.8 l/min (at 3 bar)
- Function from: 6 l/min
- 1/2" connection
- inherently safe from back flow
- with anti-scale system

**Notes:**

- This product can help a building meet the requirements of Green Building Rating Systems, e.g. LEED®, BREEAM®, DGNB

	Platinum	28 012 979-08 0010
	Chrome	28 012 979-00 0010
	Brushed Platinum	28 012 979-06 0010
	Dark Chrome	28 012 979-19 0010
	Light Gold (PVD)	28 012 979-26 0010
	Brushed Light Gold (PVD)	28 012 979-27 0010
	Brushed Durabrass (23kt Gold)	28 012 979-28 0010
	Matte Black	28 012 979-33 0010
	Brushed Gold (PVD)	28 012 979-37 0010
	Brushed Dark Brass (PVD)	28 012 979-39 0010
	Brushed Bronze (PVD)	28 012 979-42 0010
	Brushed Dark Bronze (PVD)	28 012 979-43 0010
	Brushed Champagne (22kt Gold)	28 012 979-46 0010
	Champagne (22kt Gold)	28 012 979-47 0010
	Brushed Chrome	28 012 979-93 0010
	Brushed Dark Platinum	28 012 979-99 0010

28 012 979 Product version from 4/1/2024

mm [inches]

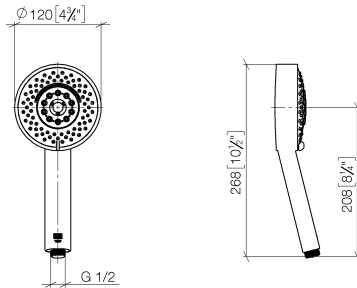

Codes & Standards

ASME A112.18.1	cUPC	DIN 4109	EN 1112
ISO 3822	Ü-Zeichen		

Certificates and sustainability

DVGW_DW-6517DN0	LGA_29	IAPMO_4976 (
-----------------	--------	--------------

28 012 979 Product version from 4/1/2024

Parts for other finishes can be found here: [Chrome](#)

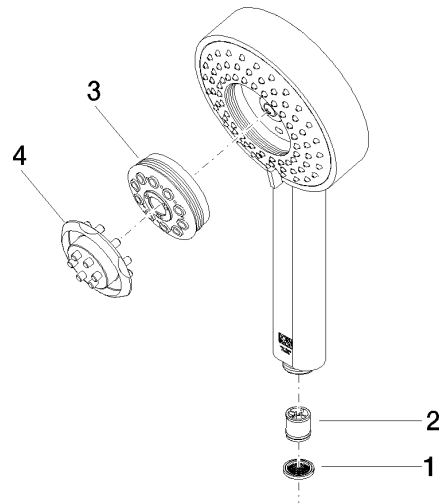

### Spare parts list

No.	Item Number	Name	Quantity used	Delivery time
1	09 23 01 039 90	Sieve seal Ø 19 x 5,5 mm -	1.00	14
4	09 30 09 022 90	Spanner -	1.00	14
3	04 12 11 071 00 90	Regulating insert Hand shower adjuster 31 x 191 x 50 mm -	1.00	14
2	09 23 01 166 90	Back-flow preventer 7 l/min. -	1.00	14