

# Product End of Life Instructions

## Wiser Room Thermostat





## End of Life Instructions

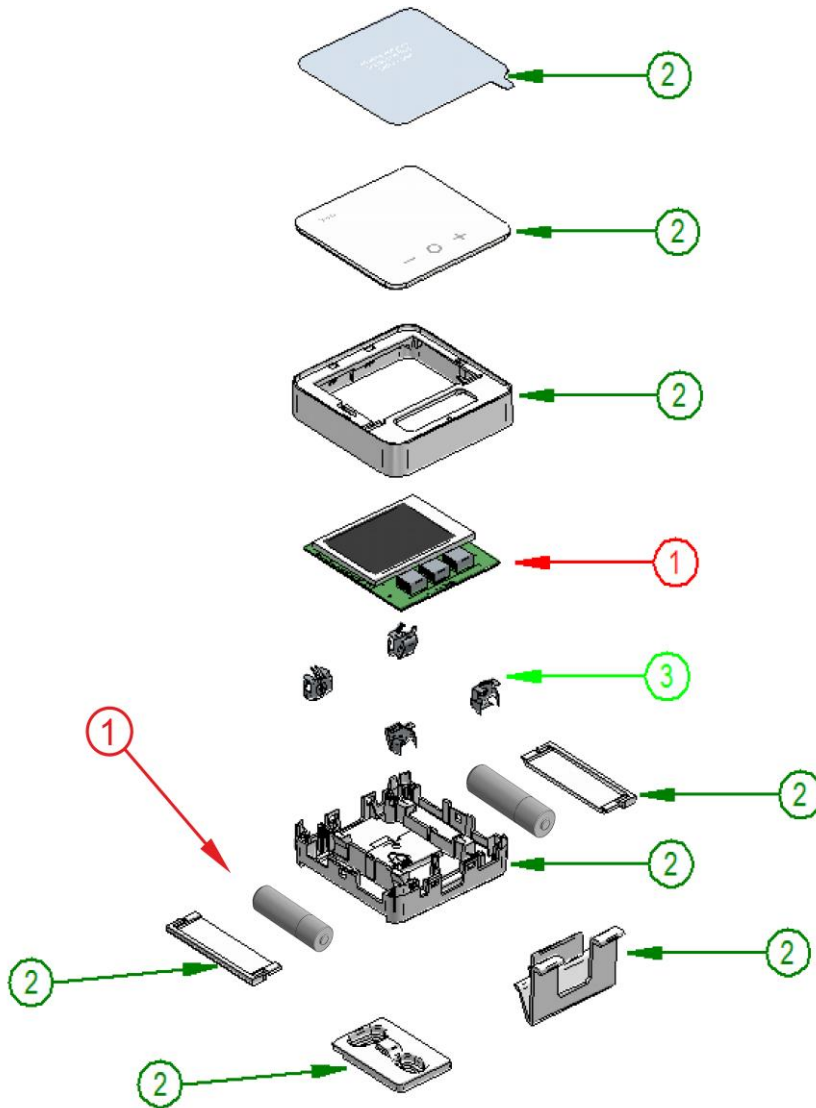

Recommendation	Number on drawing	Component / Material	Weight (in g)	Comment
To be depolluted	1	Other battery	46,6	Total weight for 2 batteries
To be depolluted	1	Electronic Board (Communication) > 10cm <sup>2</sup>	19,3	Electronic board with display
Other	2	Plastics	67,68	
Other	3	Metals	1,8086	



## Product description

Manufacturer identification	Schneider Electric Industries SAS
Brand name	Drayton

<b>Product function</b>	Wisser Room Thermostat has no wires, no installation and no mess. The wireless room thermostat is battery powered and, thanks to the handy table stand and wall clip, can be positioned anywhere. The large multi-colour screen and capacitive touch buttons provide the perfect combination of usability and iconic design. Connects to the HubR to control temperature actuation and boost features whilst monitoring temperature and humidity.
<b>Product reference</b>	WN704R0S0902
<b>Additional similar product references</b>	WN704R0S0902 WN704R0A1804 CCTFR6400
<b>Total representative product mass</b>	135,38669584892 g
<b>Representative product dimensions</b>	75mm x 75mm x 24mm
<b>Accessories</b>	Base stand
<b>Date of information release</b>	07/2018



## Additional information

<b>Legal information</b>	This product family is in the scope of European Union directive 2012/19/EU on Waste Electrical and Electronic Equipment (WEEE). The product family must be disposed according to the legislation of the country. This document is intended for use by end of life recyclers or treatment facilities. It provides the basic information to assure an appropriate end of life treatment for the components and materials of the product.	
<b>Recyclability potential</b>	<b>48%</b>	Based on "ECO'DEEE recyclability and recoverability calculation method" (version V1, 20 Sep. 2008 presented to the French Agency for Environment and Energy Management: ADEME).

Schneider Electric Industries SAS

Country Customer Care Center  
<http://www.schneider-electric.com/contact>

35, rue Joseph Monier  
 CS 30323  
 F- 92506 Rueil Malmaison Cedex  
 RCS Nanterre 954 503 439  
 Capital social 896 313 776 €

[www.schneider-electric.com](http://www.schneider-electric.com)

ENVEOLI1807013\_V1

Published by Schneider Electric

© 2017 - Schneider Electric – All rights reserved

07/2018