

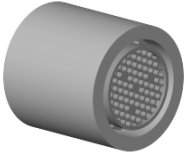









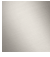





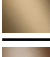

90 23 01 028 03 Product version from 4/1/2025



	Chrome	90 23 01 028 03-00
	Brushed Platinum	90 23 01 028 03-06
	Platinum	90 23 01 028 03-08
	Durabress (23kt Gold)	90 23 01 028 03-09
	Matte White	90 23 01 028 03-10
	Dark Chrome	90 23 01 028 03-19
	Brushed Light Gold (PVD)	90 23 01 028 03-27
	Brushed Durabress (23kt Gold)	90 23 01 028 03-28
	Matte Black	90 23 01 028 03-33
	Brushed Gold (PVD)	90 23 01 028 03-37
	Brushed Dark Brass (PVD)	90 23 01 028 03-39
	Brushed Bronze (PVD)	90 23 01 028 03-42
	Brushed Dark Bronze (PVD)	90 23 01 028 03-43
	Brushed Champagne (22kt Gold)	90 23 01 028 03-46
	Champagne (22kt Gold)	90 23 01 028 03-47
	Cyprum	90 23 01 028 03-49
	Brushed Chrome	90 23 01 028 03-93
	Brushed Dark Platinum	90 23 01 028 03-99



Aerator M18xIG 7,0 l/min. - Chrome

SPARE PARTS

90 23 01 028 03 Product version from 4/1/2025



Aerator M18xIG 7,0 l/min. - Chrome

SPARE PARTS

90 23 01 028 03 Product version from 4/1/2025

90 23 01 028 03 Product version from 4/1/2025

Parts for other finishes can be found here: Brushed
Platinum

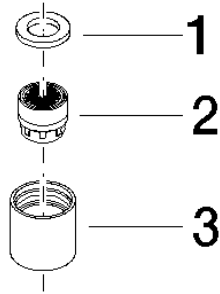

Spare parts list

No.	Item Number	Name	Quantity used	Delivery time
1	90 14 05 020 00 90	Washer 16,7 x 10,0 x 2,0 mm -	1.00	14
2	90 29 03 057 00 90	Aerator insert M18x1 - 1.8gpm -	1.00	14
3	09 23 01 028-00	Aerator sleeve Ø 20 x 20 mm - Chrome	1.00	20