

Color: ■ blue

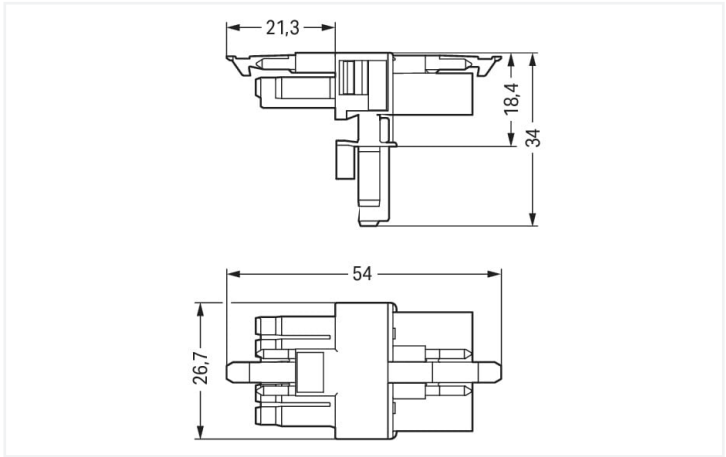

Dimensions in mm

Distribution connector WINSTA® MINI I coding

The WINSTA® MINI distribution connector I coding allows installation of fine-stranded and solid conductors. WAGO pluggable installation connectors can be used when requirements repeat or are distributed on a defined grid, for example for installing grid lighting or flush-mount lighting. The coding options reduce installation errors, allowing fast, maintenance-free wiring of all components. Regulated lighting equipment, as implemented in the DALI standard, for instance, is the main application of WINSTA® MINI pluggable installation connectors with I coding. WINSTA® MINI satisfies the demand for miniaturisation. Our smallest pluggable connection system is especially suitable for lights, for example, since as a result of LED technology; due to complex systems, these offer less and less space for the connection technology.

Push-in CAGE CLAMP® spring pressure connection technology – pluggable installation instead of laborious screw connections!

WINSTA® is the pluggable connection system that is optimally tailored to the strict requirements of electrical installation. It allows fast, secure and, above all, error-free installation of components and cables. Enjoy the benefits of the pluggable version of our maintenance-free spring pressure connection technology too! Plan your installation with with locking lever from WAGO.

- pluggable installation connectors with protection against mismatching
- compact design for conductors with a cross-section up to 1.5 mm²
- with I coding for use in building automation (lighting control)
- ready to install and use immediately
- quick replacement of defective units during ongoing operation

Electrical data						
Ratings per		IEC/EN 60664-1			Approvals per	UL 1977
Overvoltage category		III	III	II	Rated voltage	600 V
Pollution degree		3	2	2	Rated current	12 A
Nominal voltage	400 V	-	-	-		
Rated surge voltage	6 kV	-	-	-		
Rated current	16 A	-	-	-		

General information	
Note on contact resistance	approx. 1 mΩ of contact resistance approx. 0.25 mΩ contact transition plug/ socket



Connection data		
Total number of potentials	5	Connection 1
PE function	Preceding PE contact	
		Pole number5
Physical data		
Pin spacing	4.4 mm / 0.173 inches	
Width	26.7 mm / 0.705 inches	
Height	34 mm / 1.339 inches	
Depth	54 mm / 2.122 inches	
Mechanical data		
Use	DALI, Lighting Management	
Coding	I	
Variable coding	No	
Marking	N ⊕ L - +	
Potential marking	N ⊕ L - +	
Mating force of a plug-in connection	Approx. 20 ... 70 N (depending on pole number)	
Retention force of a plug-in connection	When locked: > 80 N	
Unmating force of a plug-in connection	Unlocked: approx. 20 ... 70 N (depending on pole number)	
Number of mating cycles	200, without resistive load	
Type of distribution box	T-distribution connector	
Protection type	IP20; IP40 when mated	
Plug-in connection		
Mismating protection	Yes	
Note on mismating protection	All WINSTA® components are 100% protected against mismating when: a.) plugging different numbers of poles b.) plugging while rotated 180 c.) plugging while laterally staggered d.) plugging one pole	
Locking lever	Yes	
Locking of plug-in connection	Locking lever	
Note on locking system	All connectors for mounted installations (snap-in versions for lighting fixtures or devices, all types of PCB and distribution connectors) are factory-equipped with locking levers to ensure plugs and sockets are securely locked. Additional locking levers are only required for flying leads (plug/socket).	
Number of locking levers	2	
Material data		
Note (material data)	Information on material specifications can be found here	
Color	blue	
Material group	I	
Insulation material (main housing)	Polyamide (PA66)	
Flammability class per UL94	V0	
Contact material	Copper or copper alloy; surface-treated	
Contact Plating	Tin	
Fire load	0.256 MJ	
Weight	12.1 g	



Environmental requirements	
Processing temperature	-5 ... +40 °C
Continuous operating temperature	-35 ... +85 °C
Note on continuous operating temperature	Insulating parts for temperatures ≤ 105 °C



Commercial data	
Product Group	20 (Winsta)
eCl@ss 10.0	27-44-06-03
eCl@ss 9.0	27-44-06-03
ETIM 9.0	EC002567
ETIM 8.0	EC002567
PU (SPU)	25 pcs
Packaging type	Box
Country of origin	DE
GTIN	4050821229483
Customs tariff number	85366990990

Environmental Product Compliance	
RoHS Compliance Status	Compliant, No Exemption

Approvals / Certificates

General approvals			Declarations of conformity and manufacturer's declarations		
 					
Approval	Standard	Certificate Name	Approval	Standard	Certificate Name
CCA DEKRA Certification B.V.	EN 61535	71-123231	EU-Declaration of Confor- mity WAGO GmbH & Co. KG	-	-
CCA DEKRA Certification B.V.	IEC 61535	NL-85020	UK-Declaration of Confor- mity WAGO GmbH & Co. KG	-	-
cURus Underwriters Laboratories Inc.	UL 1977	E45171			

Approvals for marine applications

  		
Approval	Standard	Certificate Name
ABS American Bureau of Ship- ping	Steel Vessel Rules	19-HG1869855-PDA
DNV GL Det Norske Veritas, Ger- manischer Lloyd	-	TAE00001Z6
LR Lloyds Register	EN 61535	08/20047 (E2)



Downloads

Environmental Product Compliance

Compliance Search			
Environmental Product Compliance 890-617			

Documentation

Bid Text			
890-617	19.02.2019	xml 2.73 KB	
890-617	30.11.2018	doc 22.50 KB	

CAD/CAE-Data

CAD data	
2D/3D Models 890-617	

CAE data	
WSCAD Universe 890-617	

Installation Notes

Installation



Secure the mounting plate via pins.